

Malabu Heights Plaza

2348 & 2358 Nicholasville Road, Lexington, KY 40503



Property Description

Malabu Heights Plaza, located on Nicholasville Road (43,989 avg. cars/day), is at the center Lexington's premier retail corridor. The property boasts high traffic counts and excellent visibility. It is perfect for retail, showroom, or office type users.

Location Description

Malabu Heights Plaza is located on Nicholasville Road surrounded by high-end retail including Trader Joes, Verizon, Lasik Plus, and many others. Inside New Circle Road, the property is convenient to the University of Kentucky, hospitals, and hotels. It is supported by strong office, commercial, and residential volume in the immediate and surrounding areas.

Google Maps: [CLICK HERE](#)

Google Streetview: [CLICK HERE](#)

Malabu Heights Plaza

2348 & 2358 Nicholasville Road

Lexington, KY 40503

Zoned: B-1 (Neighborhood Business)

Bldg. 2358 Suite 170 - 1,350 SF- \$16.00-18.00/SF + NNN

Contact:

Colleen Barr, MBA, CCIM

O: 859.309.0099 X230

C: 859.489.6133

Colleen@BALrealestate.com



Malabu Heights Plaza

Available Space & Site Plan

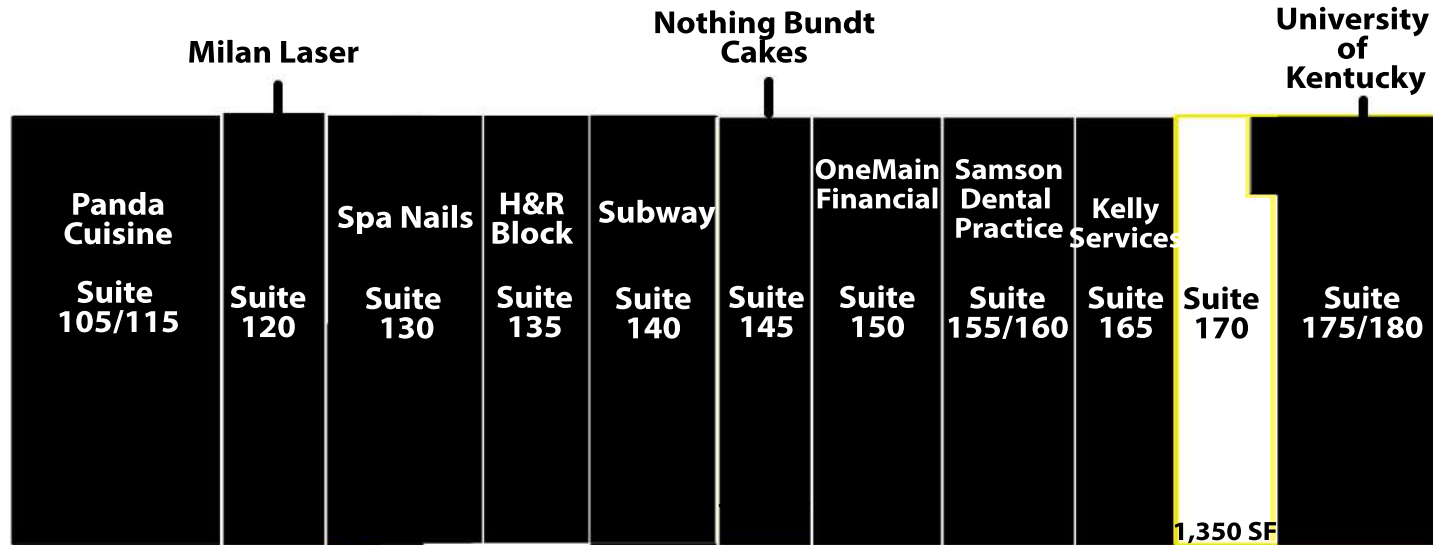

2358 Nicholasville Road

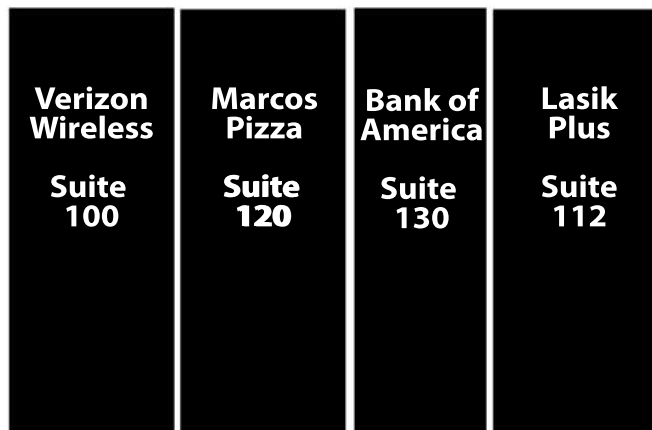

2348 Nicholasville Road

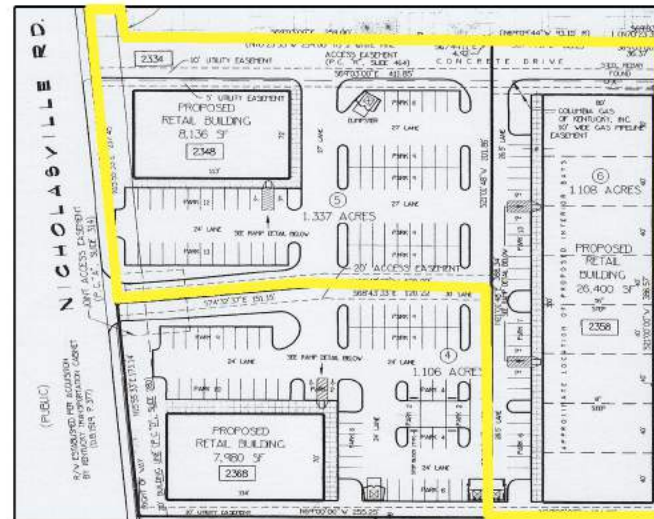

Malabu Heights Plaza

Aerial & Demographics



Malabu Heights Plaza

Photos

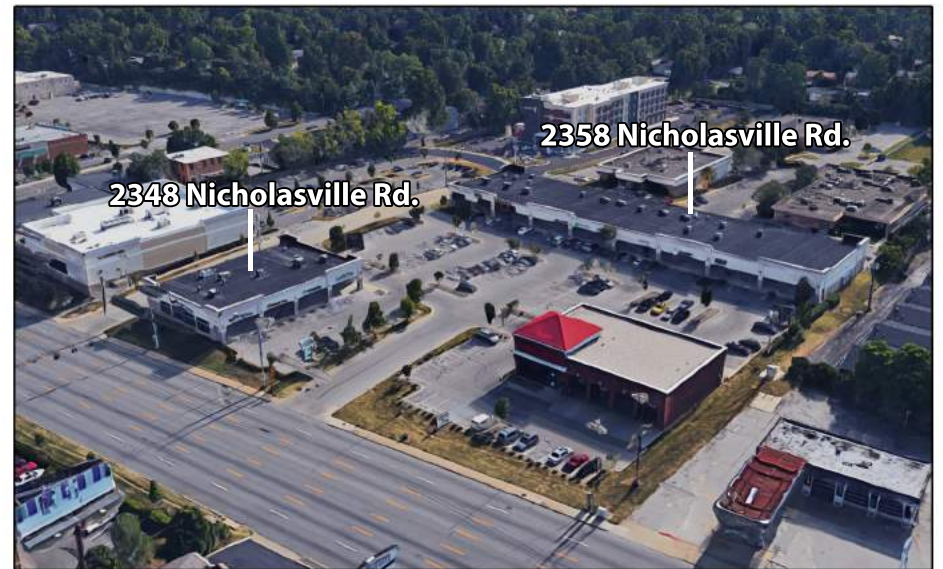

Malabu Heights Plaza

Floor Plan

