

Move In Ready Creative Office

3221 - 3235 Donald Douglas Loop S.
Santa Monica CA 90405



**CORPORATE
REALTY
GROUP**



PREMISES

3221 A - 4,413 Sq. Ft.

3235 A - 3,493 Sq. Ft.

AVAILABLE

Immediate

TERM

Negotiable

RENT

\$3.85 to \$4.25 PSF / MG
(INCLUDING UTILITIES)

PARKING

Abundant @ \$150 per space

FEATURES

- Floor to ceiling windows
- High ceilings
- Amazing sunset views
- Outdoor seating / deck
- Mix of open space & offices
- Prominent signage
- Currently creative office

CONTACT

Craig Zund

Craig@corprg.com

DRE# 01897508

(310) 570-5011

Move In Ready / Creative Office

3221 - 3235 Donald Douglas Loop S.



**CORPORATE
REALTY
GROUP**

Suite - 3221 A



CONTACT Craig Zund
Craig@corprg.com
DRE# 01897508

(310) 570-5011



**CORPORATE
REALTY
GROUP**

Floor Plan Suite 3221 A 4,413 Square Feet

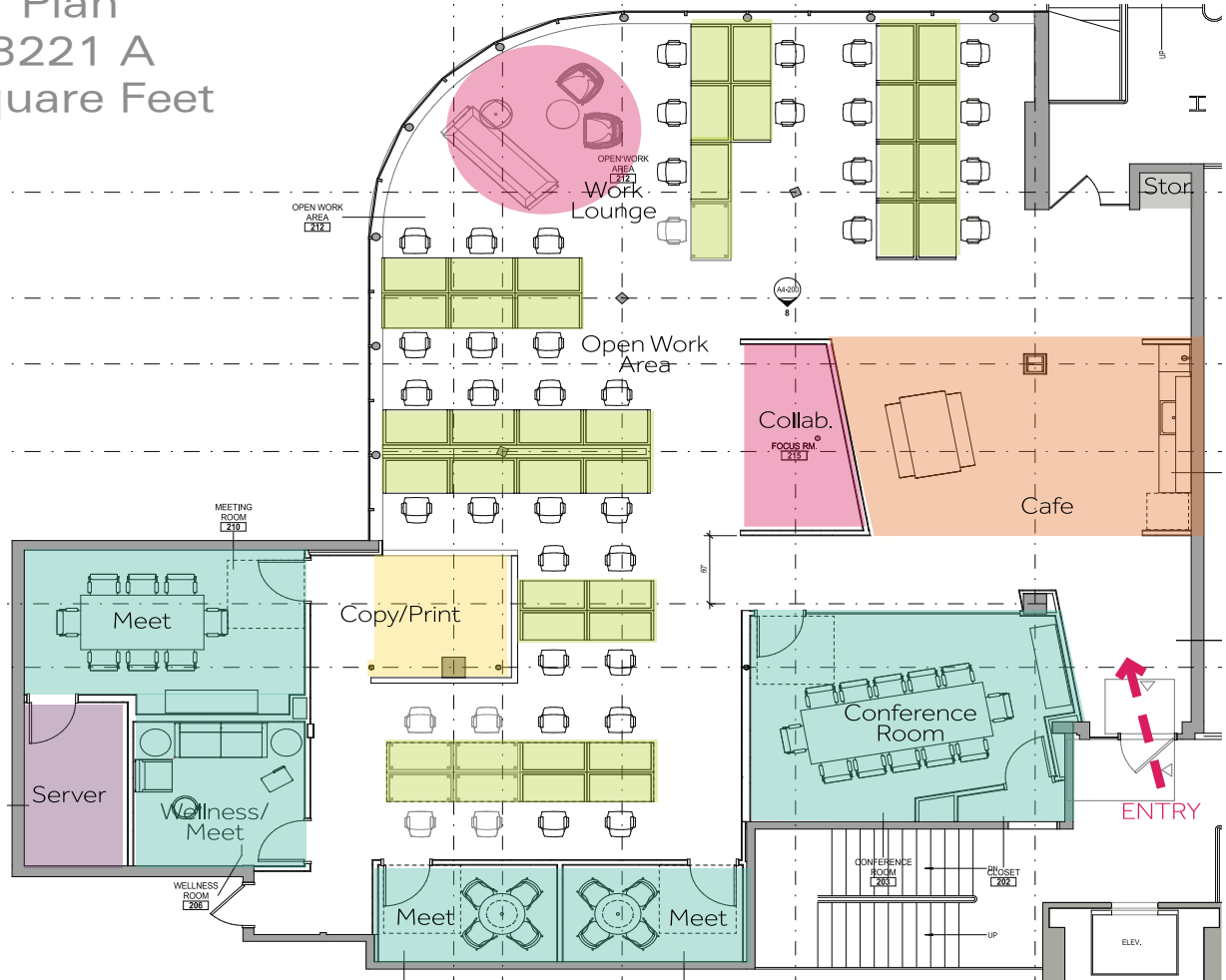

CONTACT Craig Zund
Craig@corprg.com
DRE# 01897508

(310) 570-5011



CORPORATE GROUP



Suite - 3235A

CONTACT Craig Zund
Craig@corprg.com
DRE# 01897508

(310) 570-5011



CORPORATE
REALTY
GROUP

Floor Plan
Suite 3235 A
3,493 Square Feet



3235 A Floorplan

3221 - 3235 Donald Douglas Loop S.



**CORPORATE
REALTY
GROUP**

Spectacular Views !



CONTACT Craig Zund
Craig@corprg.com
DRE# 01897508

(310) 570-5011



**CORPORATE
REALTY
GROUP**

Santa Monica Airport

- Nearby Neighbors
- Coffee Bean
 - Starbucks
 - Vitos
 - Uplifters Kitchen
 - The Counter
 - Crimson
 - The Cloverfield

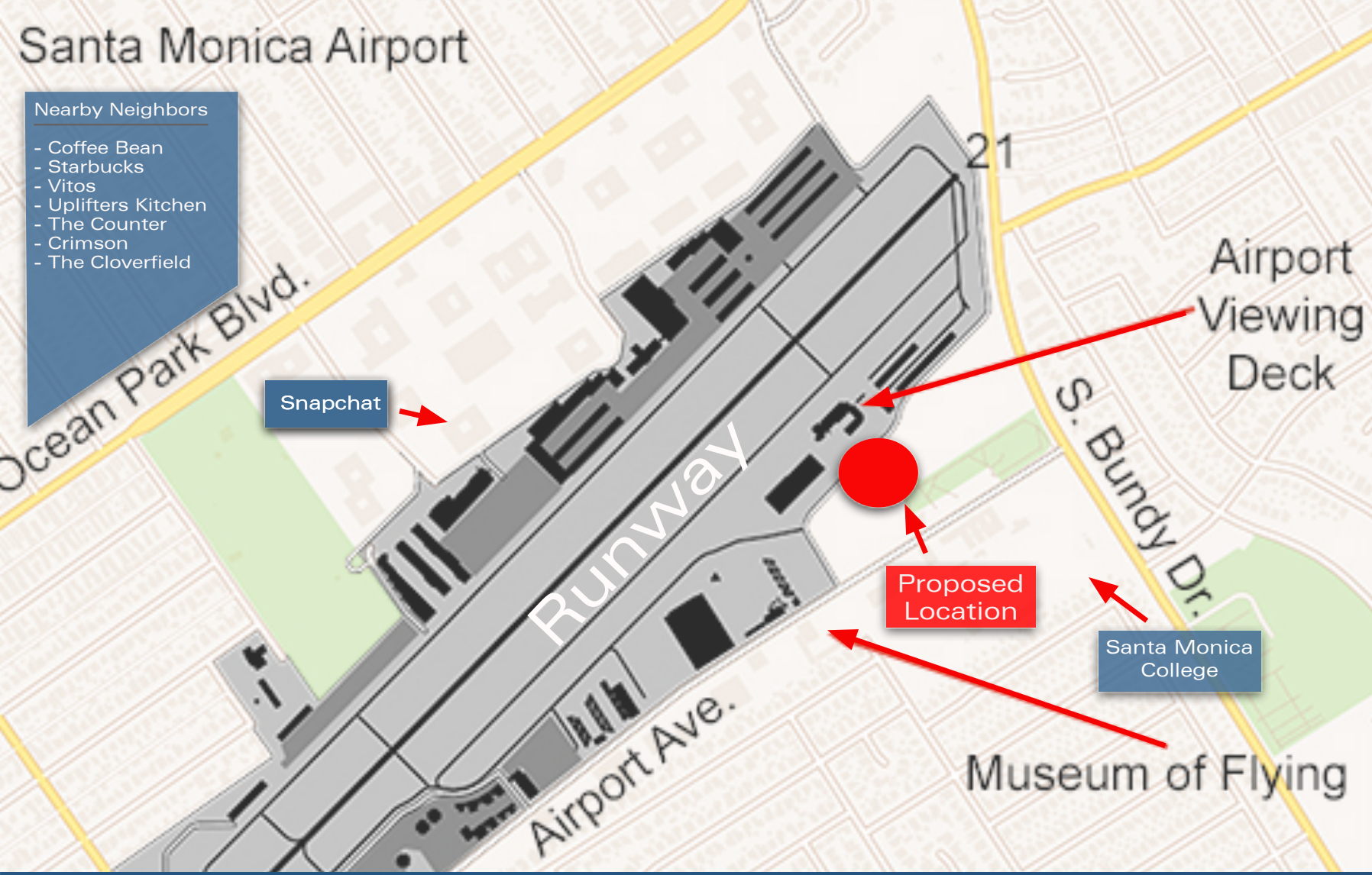

CONTACT Craig Zund
Craig@corprg.com
DRE# 01897508

(310) 570-5011



CORPORATE
REALTY
GROUP