

DOLPHIN COMMERCE CENTER | AIRPORT WEST SUBMARKET | DORAL
FOR SALE: 2045 NW 115th Avenue #12



DETAILS

Size: 11,520 SqFt
Office Area 10%
Mezzanine 10%
4 Docks
Door Height 10'-12'
Clear Height 28'
Reception/Showroom Area
4 Offices, 2 Bathrooms
11 Assigned Parking Spaces
3 Phase Electricity / 200 Amps



FEATURES

Contemporary Architecture
Open/Bright Floor Plan
Parquet Floors
Signage Opportunity
Impact Resistant Glass Door & Windows
Individual AC Unit / Thermostat
Independent Electric Meter / Panel
Leased through Sept. 30th, 2019

The Information Contained Herein Is Subject To Errors, Omissions, Change Of Price, Rental Or Other Conditions, Prior Sale, Lease Or Financing, Or Withdrawal Without Notice.



Chabeli Castillo
LIC. BROKER ASSOCIATE
BEACHFRONT REALTY

(786) 423-0525
CHABELICM@GMAIL.COM
CHABELI_REALESTATE



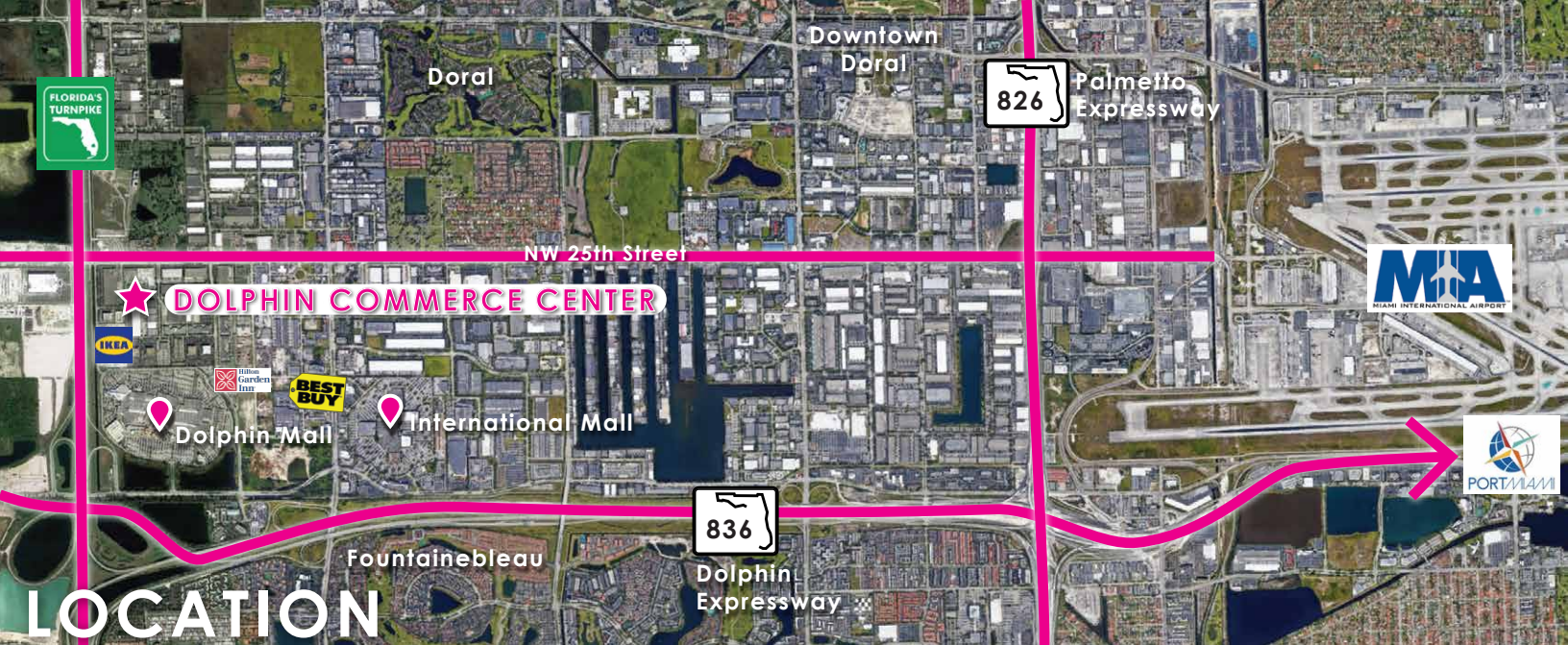

LOCATION

Strategically Located in the MIA Airport West Submarket
 Next to Commerce/Retail Hubs Dolphin & International Malls
 Easy Access to All Major Highways: Florida Turnpike, SR-836 & SR-826
 Minutes to Downtown Doral & Major Mixed Used Developments
 Doral is South Florida's Global Epicenter of Distribution, Logistics & Wholesale



Chabeli Castillo
 LIC. BROKER ASSOCIATE
 BEACHFRONT REALTY

☎ (786) 423-0525
 ✉ CHABELICM@GMAIL.COM
 📍 CHABELI_REALESTATE



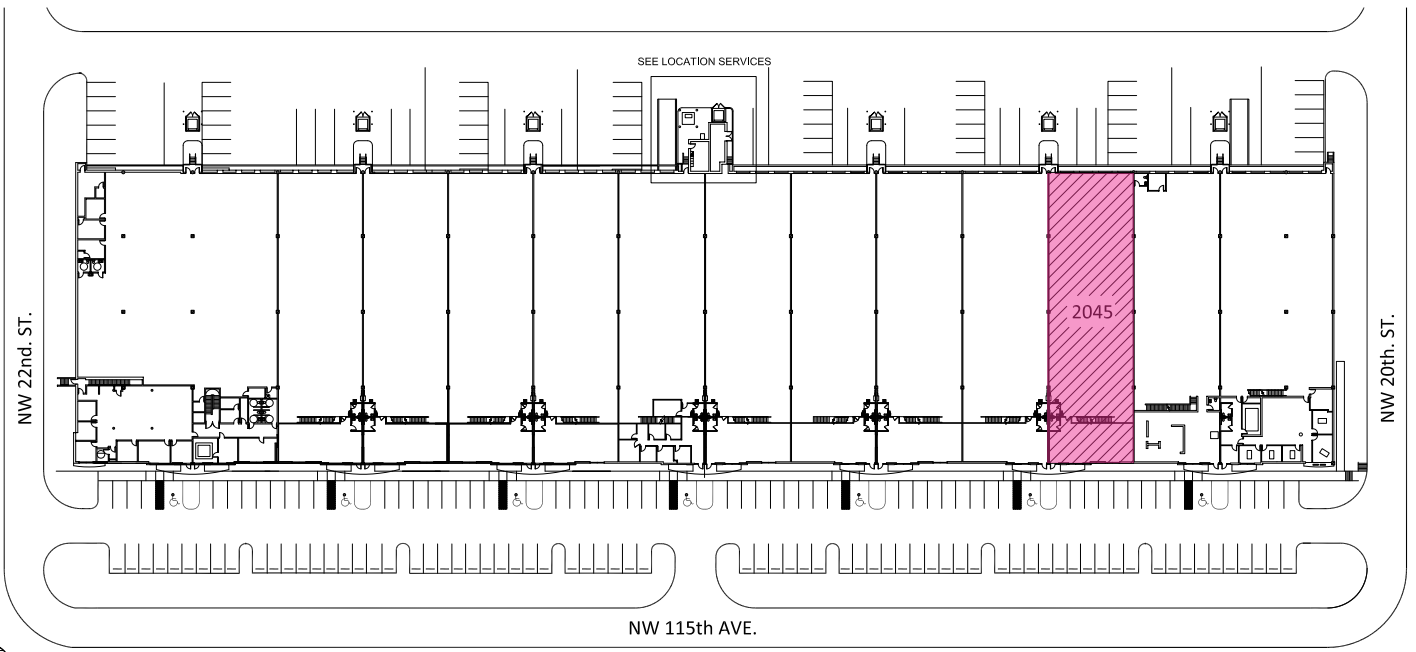

SITE PLAN

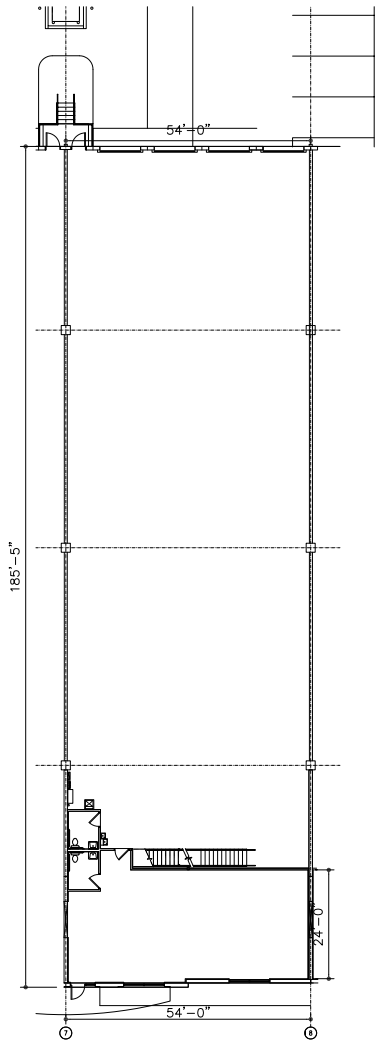

FIRST FLOOR PLAN

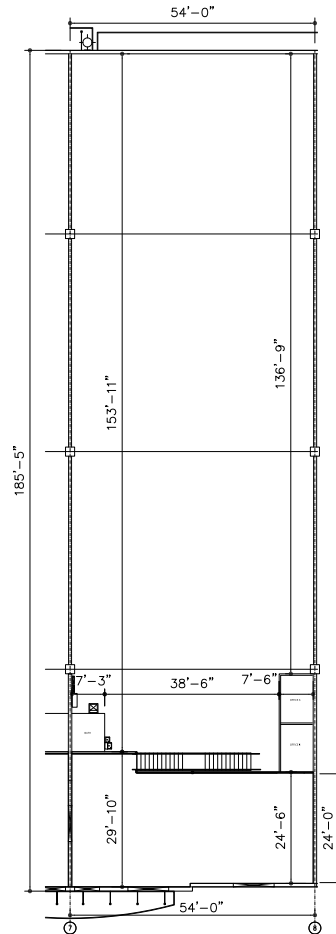

MEZZANINE



Chabeli Castillo
LIC. BROKER ASSOCIATE
 BEACHFRONT REALTY

- ☎ (786) 423-0525
- ✉ CHABELICM@GMAIL.COM
- 📷 CHABELI_REALESTATE

