

# WELCOME TO THE 12TH FLOOR AT THE REFINERY.



**THE REFINERY**  
at Domino

# AN ICON IN THE CENTER OF NEW YORK'S MOST CREATIVE NEIGHBORHOOD

## NEW YORK'S NEWEST ICON

Meticulously designed by PAU Architects and located at the epicenter of New York City's most creative and dynamic neighborhood, The Refinery represents a once-in-a-lifetime opportunity for business leaders to claim an unmissable and defining part of the New York City skyline.

With the expansive waterfront Domino Park at your doorstep, The Refinery offers all the perks and amenities of a brand new, Class-A building with the cultural relevance and historic significance of a beloved landmark address. This is a matchless opportunity to embody the modern live, work, and play lifestyle that inspires creativity, drives innovation, and propels meaningful business growth.



# A TURNKEY FULL FLOOR ON THE WILLIAMSBURG WATERFRONT

The largest, turnkey pre-built in Brooklyn, is for the discerning tenant who understands this iconic building is at the very center of New York's most creative neighborhood.

Available Fall 2024, the 12th Floor at The Refinery is 31,414 RSF of virtually column-free space and unobstructed river and Manhattan views. The floor has been efficiently and carefully thought out to appeal to both home-grown Brooklyn tenants or company seeking a satellite office in close proximity to employees.



# CREATIVE FLOOR PLAN

Entire 12th Floor  
31,414 RSF

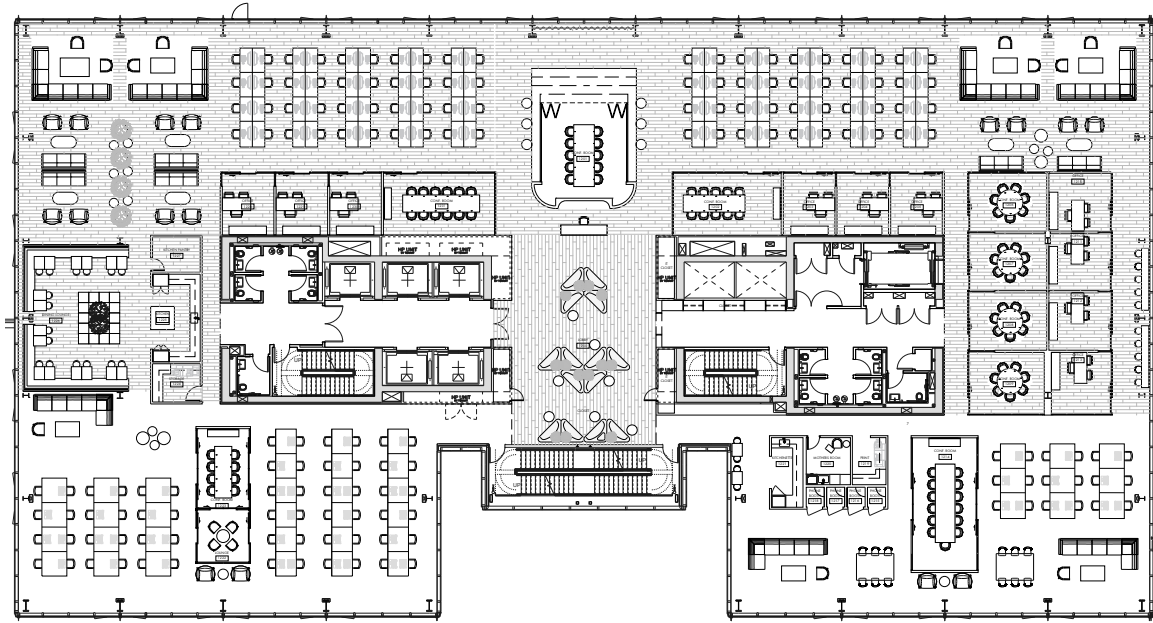

## Features

Efficient full floor design and layout

Raised platform conference room with stadium seating

One (1) large conference room

Three (3) conference rooms

Five (5) medium huddle rooms

Ten (10) offices

Four (4) telephone rooms

One (1) lab/maker space

Two (2) high-end pantries with seats

Concrete and oak floors

Exposed 12'6" ceilings





## MODERN AND AMENITIZED

A raised glass-encased conference room, complete with stadium seating, is just one of many unique architectural features of the space. The 12th Floor also includes a dedicated reception and waiting area, with custom 3D Printed seating complete with natural greenery.



# ABOUT TWO TREES

Two Trees Management Company is a family-owned, Brooklyn-based real estate development firm best known for its singular role in transforming DUMBO from a neglected, industrial waterfront into a vibrant, mixed-use community, as well as the on-going creation of the Domino Campus on the Williamsburg waterfront.

Since its founding in 1968, Two Trees has operated under the fundamental belief that successful neighborhoods offer a wide variety of uses and attract diverse groups of people, and that developers must play a fundamental role in cultivating livable streetscapes - because people prosper when neighborhoods bloom.

**Mary Ann Tighe**  
CEO, NY Tri-State Region

**Arkady Smolyansky**  
Senior Vice President  
Arkady.Smolyansky@cbre.com

**Brett Shannon**  
Senior Vice President  
Brett.Shannon@cbre.com

**Jacob Rosenthal**  
Senior Associate  
Jacob.Rosenthal@cbre.com

**Alyssa Zahler**  
Managing Director  
Alyssa@twotreesny.com

**Elizabeth Bueno**  
Managing Director  
Ebueno@twotreesny.com

**CBRE**

