

# 1125 W Pinnacle Peak Rd

1125 W PINNACLE PEAK RD  
PHOENIX / AZ



**±8,917 SF**  
**Space for**  
**Sublease**



# Site Plan

1125 W Pinnacle Peak Rd

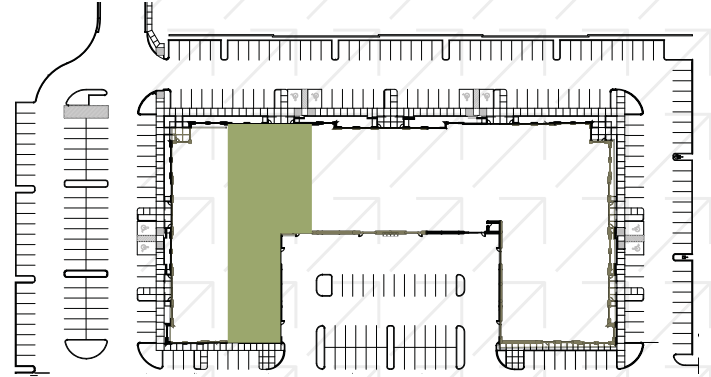
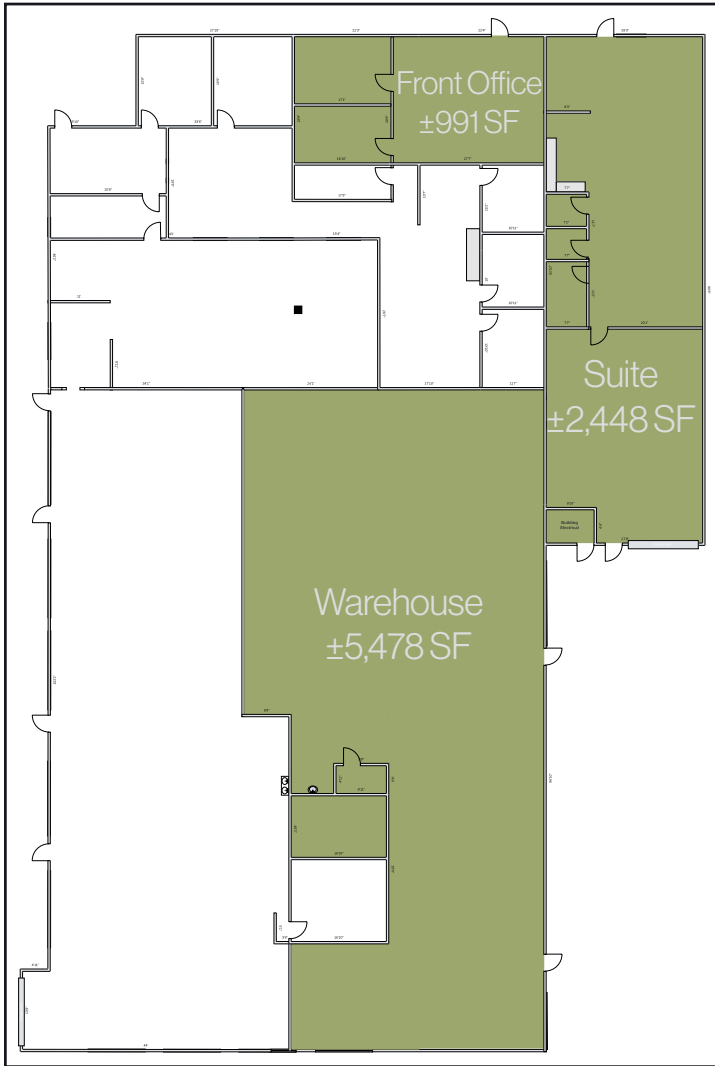

NOT TO SCALE



±8,917 SF Available

100% AC

±16' Clear Height

5:1,000 Parking Ratio

1 Grade Level Door

±3,439 SF Quality Training Office Space

Sublease Expiration 2/28/2027

Access to I-17, Loop 101, & SR-51 Freeways

Frontage on Pinnacle Peak Road

Retail Amenities Nearby

NOT TO SCALE

HAPPY VALLEY TOWNE CENTER



# Nearby Amenities

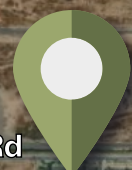

W Pinnacle Peak Rd



PHOENIX DEER VALLEY AIRPORT



W Rose Garden Ln

W Beardsley Rd

LOOP 101

LOOP 101

DEER VALLEY TOWNE CENTER



W Utopia Rd

# 1125 W Pinnacle Peak Rd

## ±12,000 SF Space for Sublease

1125 W PINNACLE PEAK RD  
PHOENIX / AZ



### 10 Mile Radius Demographics

795,661 Population 

293,295 Employees 

22,700 Businesses 

39.8 Median Age 

\$124,644 House Hold Income 

SOURCE: ESRI 2024

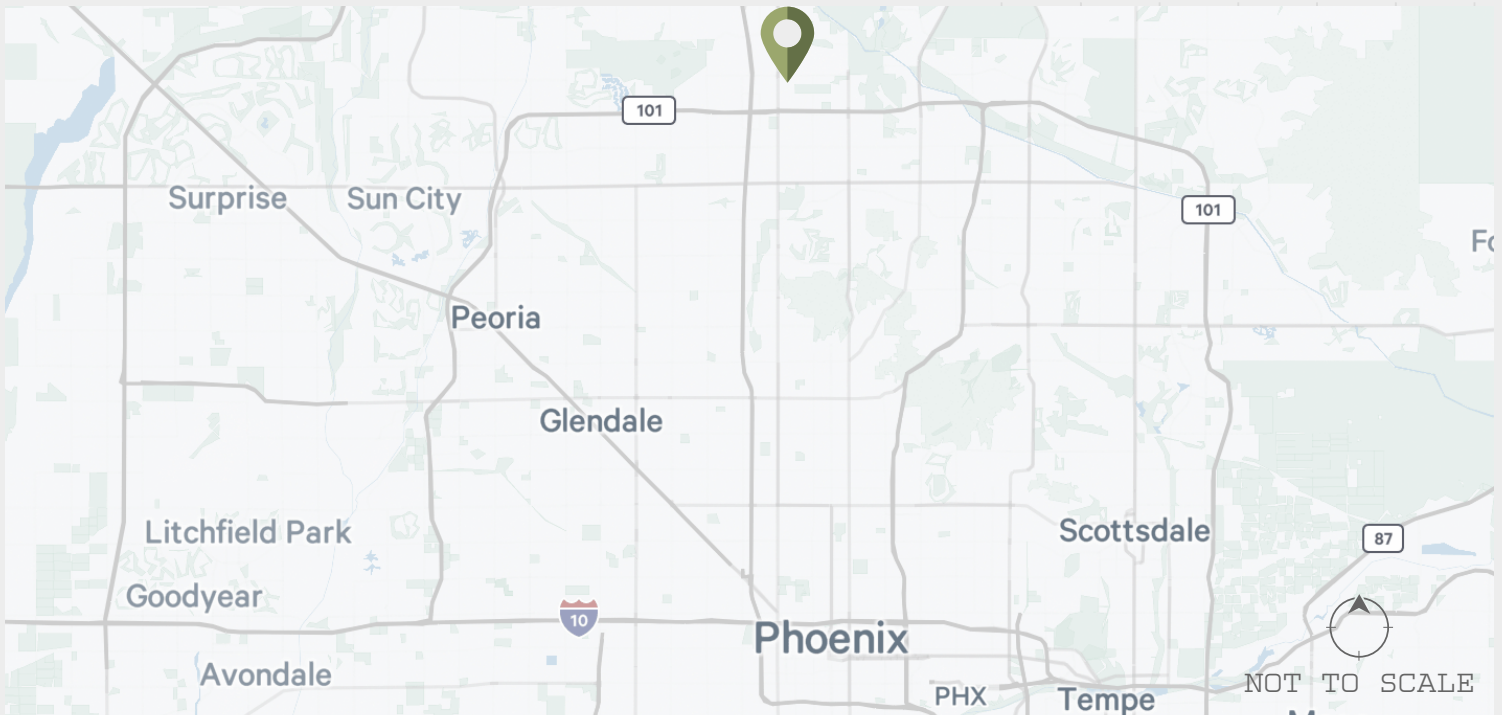

#### Dan Calihan

Executive Vice President, SIOR

+1 602-617-1546

dan.calihan@cbre.com

#### Pat Feeney

Executive Vice President, SIOR

+1 602-538-3257

pat.feeney@cbre.com

#### Tyler Vowels

Senior Associate

+1 231-384-1079

tyler.vowels@cbre.com

© 2024 CBRE, Inc. All rights reserved. This information has been obtained from sources believed reliable but has not been verified for accuracy or completeness. CBRE, Inc. makes no guarantee, representation or warranty and accepts no responsibility or liability as to the accuracy, completeness, or reliability of the information contained herein. You should conduct a careful, independent investigation of the property and verify all information. Any reliance on this information is solely at your own risk. CBRE and the CBRE logo are service marks of CBRE, Inc. All other marks displayed on this document are the property of their respective owners, and the use of such marks does not imply any affiliation with or endorsement of CBRE. Photos herein are the property of their respective owners. Use of these images without the express written consent of the owner is prohibited.