



# HWY COMMERCIAL DRIVE-THRU PADS AVAILABLE

SEC Sierra College Boulevard & Schriber Way at Interstate 80 - Rocklin, CA



Kevin Soares  
Executive Vice President  
CA DRE #01291491  
ksoares@GallelliIRE.com

Jeff Hagan  
Senior Vice President  
CA DRE #01494218  
jhagan@GallelliIRE.com

Matt Goldstein  
Vice President  
CA DRE #01886233  
mgoldstein@GallelliIRE.com

Gallelli Real Estate  
3005 Douglas Blvd., Suite 200  
Roseville, CA 95661  
P 916 772 1700  
www.GallelliIRE.com  
Gary B. Gallelli, Broker  
CA DRE #00811881







# HWY COMMERCIAL DRIVE-THRU PADS AVAILABLE

SEC Sierra College Boulevard & Schriber Way at Interstate 80 - Rocklin, CA



Kevin Soares  
Executive Vice President  
CA DRE #01291491  
ksoares@GallelliRE.com

Jeff Hagan  
Senior Vice President  
CA DRE #01494218  
jhagan@GallelliRE.com

Matt Goldstein  
Vice President  
CA DRE #01886233  
mgoldstein@GallelliRE.com

Gallelli Real Estate  
3005 Douglas Blvd., Suite 200  
Roseville, CA 95661  
P 916 772 1700  
www.GallelliRE.com  
Gary B. Gallelli, Broker  
CA DRE #00811881



Licensed as Real Estate Salespersons by the CA DRE. The information contained herein has been obtained from sources we deem reliable. While we have no reason to doubt its accuracy, we do not guarantee it. © Gallelli Real Estate. All Rights Reserved.





# HWY COMMERCIAL DRIVE-THRU PADS AVAILABLE

## PROPERTY HIGHLIGHTS & DEMOGRAPHICS

**location:** SEC Sierra College Boulevard and Schriber Way at I80 Rocklin, CA

**notable tenants in close proximity:** Bass Pro Shops, Walmart Supercenter, Green Acres Nursery, TJ Maxx, HomeGoods, PetSmart, Chick-Fil-A, Habit Burger, Del Taco & Cracker Barrel

**shopping center GLA:** ±17,730 Square Feet (GLA)

**availability:** Highly Visible Pad Space Ground Lease/Build-to-Suit



<u>2024 total population</u>	
3-mile	45,054
5-mile	142,145
7-mile	241,947



<u>2024 daytime population</u>	
3-mile	49,981
5-mile	172,652
7-mile	283,471



<u>2024 total employees</u>	
3-mile	19,466
5-mile	83,229
7-mile	133,905



<u>2024 total households</u>	
3-mile	17,073
5-mile	52,744
7-mile	92,129



<u>2024 average HH income</u>	
3-mile	\$169,315
5-mile	\$175,903
7-mile	\$165,257



<u>traffic counts</u>	
Interstate 80 (west of Sierra College)	±103,647
Sierra College Blvd (south of Interstate 80)	±19,072



Kevin Soares  
Executive Vice President  
CA DRE #01291491  
ksoares@GallelliRE.com

Jeff Hagan  
Senior Vice President  
CA DRE #01494218  
jhagan@GallelliRE.com

Matt Goldstein  
Vice President  
CA DRE #01886233  
mgoldstein@GallelliRE.com

Gallelli Real Estate  
3005 Douglas Blvd., Suite 200  
Roseville, CA 95661  
P 916 772 1700  
www.GallelliRE.com  
Gary B. Gallelli, Broker  
CA DRE #00811881



# HWY COMMERCIAL DRIVE-THRU PADS AVAILABLE

SEC Sierra College Boulevard & Schriber Way at Interstate 80 - Rocklin, CA

A proud member of  
**CHAINLINKS**  
REAL ADVISORS

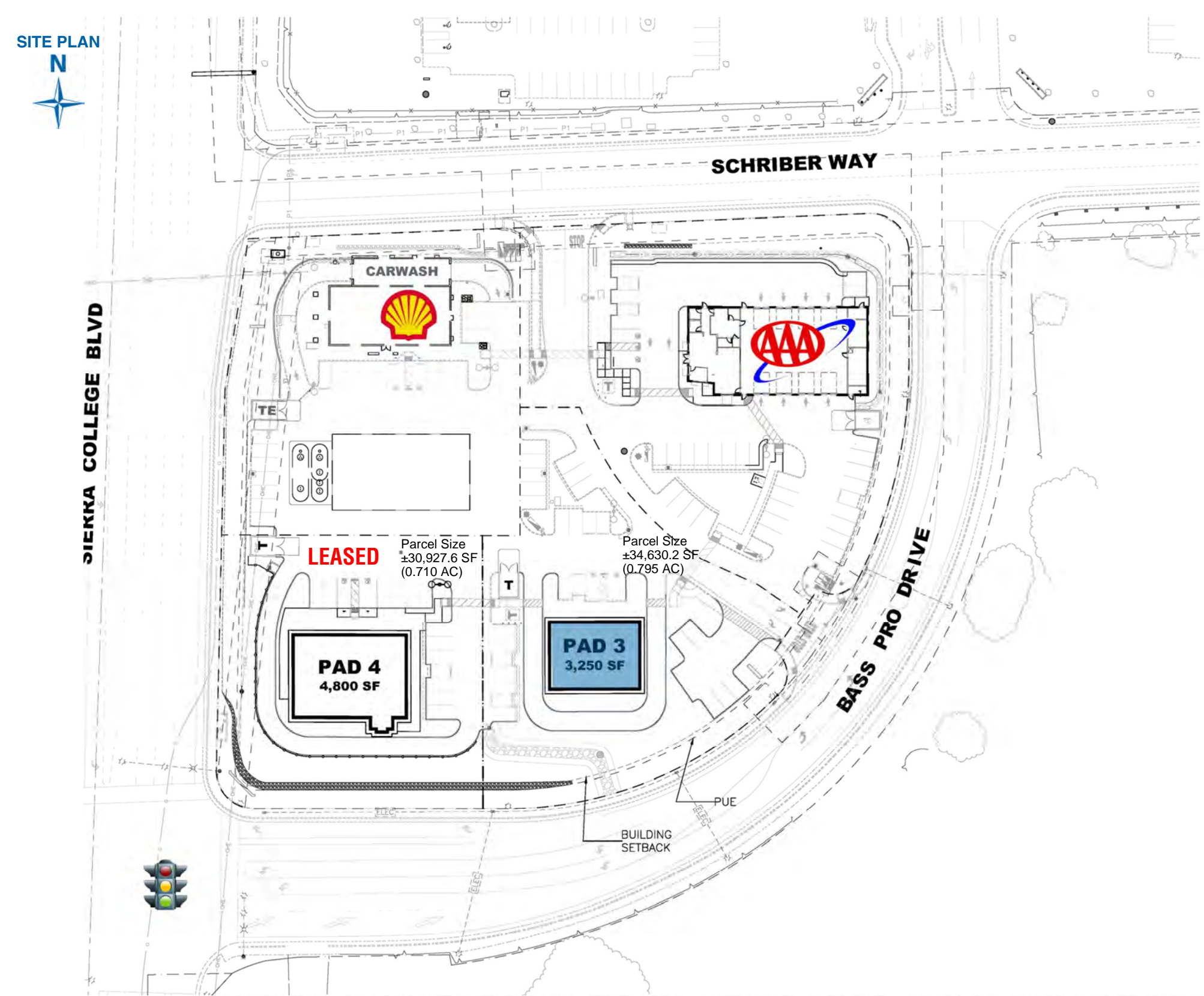

SUITE	TENANT	SQ. FT.
Pad 1	Shell	2,880
Pad 2	AAA	6,800
Pad 3	<b>FUTURE DRIVE-THRU</b>	3,250
Pad 4	LEASED	4,800

For leasing information,  
please contact:

**Kevin Soares**  
CA DRE #01291491  
ksoares@GallelliRE.com

**Jeff Hagan**  
CA DRE #01494218  
jhagan@GallelliRE.com

**Matt Goldstein**  
CA DRE #01886233  
mgoldstein@GallelliRE.com

**Gallelli Real Estate**  
3005 Douglas Blvd., Suite 200  
Roseville, CA 95661  
P 916 772 1700  
www.GallelliRE.com  
Gary B. Gallelli, Broker  
CA DRE #00811881



Licensed as Real Estate Salespersons by the CA DRE. The information contained herein has been obtained from sources we deem reliable. While we have no reason to doubt its accuracy, we do not guarantee it. © Gallelli Real Estate. All Rights Reserved.





# HWY COMMERCIAL DRIVE-THRU PADS AVAILABLE

## RETAIL TRADE AREA AERIAL

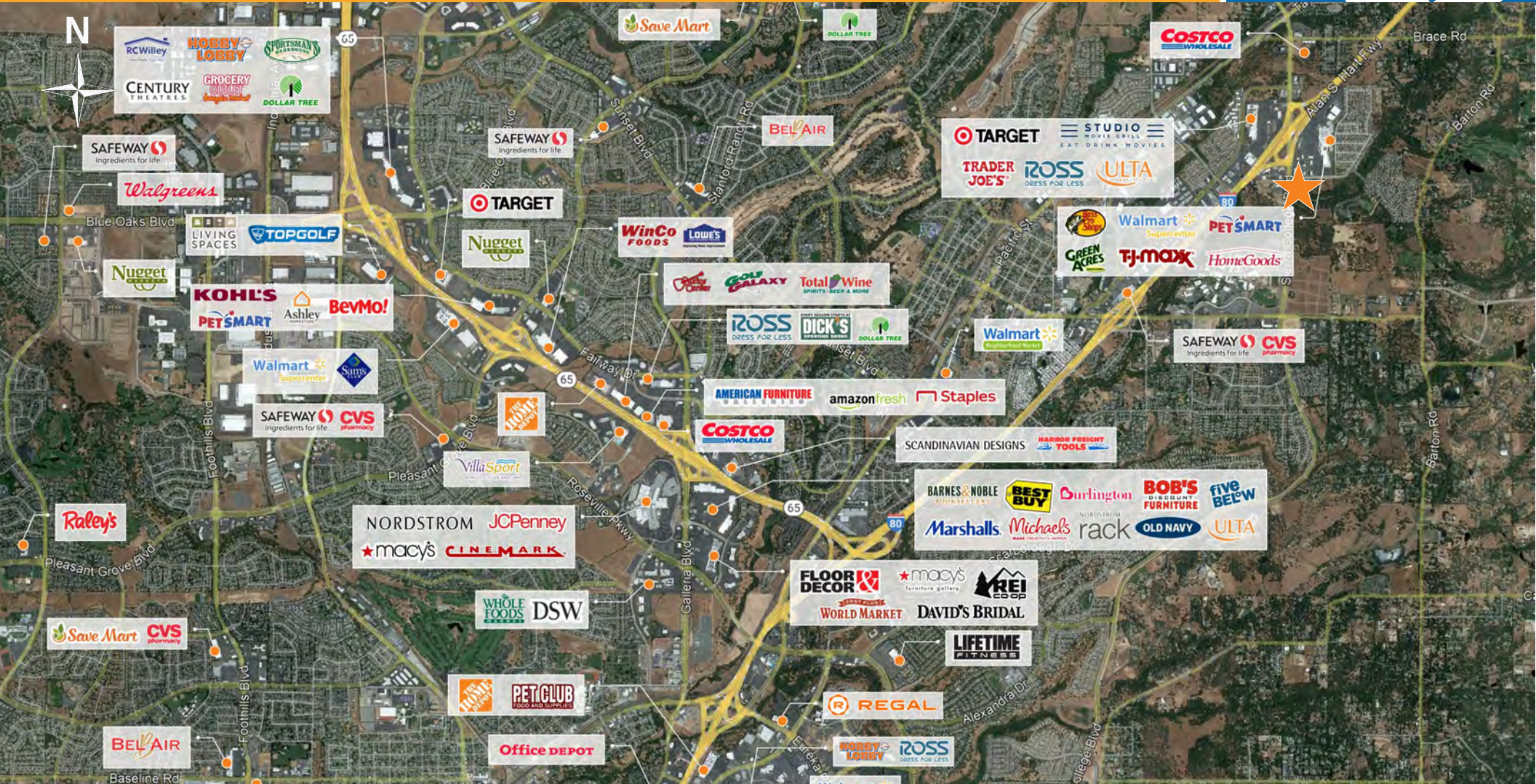

Kevin Soares  
Executive Vice President  
CA DRE #01291491  
ksoares@GallelliIRE.com

Jeff Hagan  
Senior Vice President  
CA DRE #01494218  
jhagan@GallelliIRE.com

Matt Goldstein  
Vice President  
CA DRE #0186233  
mgoldstein@GallelliIRE.com

Gallelli Real Estate  
3005 Douglas Blvd., Suite 200  
Roseville, CA 95661  
P 916 772 1700  
www.GallelliIRE.com  
Gary B. Gallelli, Broker  
CA DRE #00811881

