

Allied

PROPERTY GROUP

21 GLENVILLE STREET, GREENWICH, CT ALL NEW GREENWICH SHOPPING CENTER

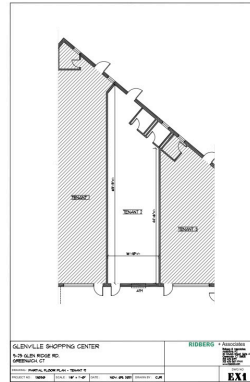

ADDRESS: 21 GLENVILLE STREET, GREENWICH, CT

SIZE: 1,050 +/- RSF

RENT: \$65 RSF

INFO: ALL NEW SHOPPING CENTER

1,050 RSF X \$65 RSF + \$11.56 NET EXPENSES = \$6,699 MONTH

FINISHED VANILLA BOX READY FOR YOU

NEW HANDICAP BATHROOM, NEW MODERN SPIRAL HVAC

NEW ELECTRIC PANEL

NEWLY PAVED PRIVATE PARKING LOT

BACK ENTRANCE FOR EASY DELIVERY

HIGH CEILINGS, FULL GLASS RETAIL WINDOWS AND DOOR

LOCATED IN GREENWICH IN GLENVILLE NEIGHBORHOOD

25,000 CARS A DAY PASS CENTER

INFO, SHOWINGS TEXT DIANE ROTH 203-962-6558

Listed subject to errors, omissions change of price and withdrawal without notice. Sale rent projections are estimates only



Exclusive Agent

Allied Property Group

Diane Roth

mobile: 203-962-6558

email: diane@alliedpropertygp.com