

RETAIL/FLEX PROPERTY FOR LEASE

ATTRACTIVE RETAIL/FLEX UNIT FOR LEASE

1104 Great Falls Ct | Knightdale, NC 27545

1104

NIKITA ZHITOV
919.888.1285
nikita@cityplat.com

CITYPLAT
COMMERCIAL REAL ESTATE

1104 GREAT FALLS CT

Knightdale, NC 27545

RETAIL PROPERTY FOR LEASE



TABLE OF CONTENTS

3 | Property Summary

4 | Floor Plan

5 | Survey

6 | Ariel

7 | Amenities Map

8 | Location Map

9 | City Information

10 | Demographics

NIKITA ZHITOV

[919.888.1285 | nikita@cityplat.com

CITYPLAT
COMMERCIAL REAL ESTATE

1104 GREAT FALLS CT

Knightdale, NC 27545

RETAIL PROPERTY FOR LEASE



PROPERTY DESCRIPTION

Introducing a prime commercial opportunity at 1104 Great Falls Ct, Unit D, Knightdale, NC, 27545. This exceptional property offers a versatile space suitable for a wide range of businesses. Boasting an inviting exterior and expansive interior, this well-maintained building provides ample parking and excellent visibility. With flexible floor plans and modern amenities, it's ideal for retail, office, or service-oriented ventures. Take advantage of the high traffic location and make this dynamic property the new home for your enterprise. Don't miss the chance to lease this standout property and elevate your business to new heights.

OFFERING SUMMARY

Date Available:	1/1/2026
Lease Rate:	\$18.00 SF/yr (NNN)
Available SF:	1,733 SF
Estimated TICAM:	\$3.63 SF/yr

PROPERTY HIGHLIGHTS

- High traffic location
- Versatile space for various businesses
- Ample parking
- Flexible floor plan
- Inviting exterior
- Located just off Knightdale Boulevard in the
- 64 East Business Park
- Approximately one mile from I-540, exit 24
- Zoning: NMX

NIKITA ZHITOV

[919.888.1285 | nikita@cityplat.com

CITYPLAT
COMMERCIAL REAL ESTATE

1104 GREAT FALLS CT

Knightdale, NC 27545

RETAIL PROPERTY FOR LEASE

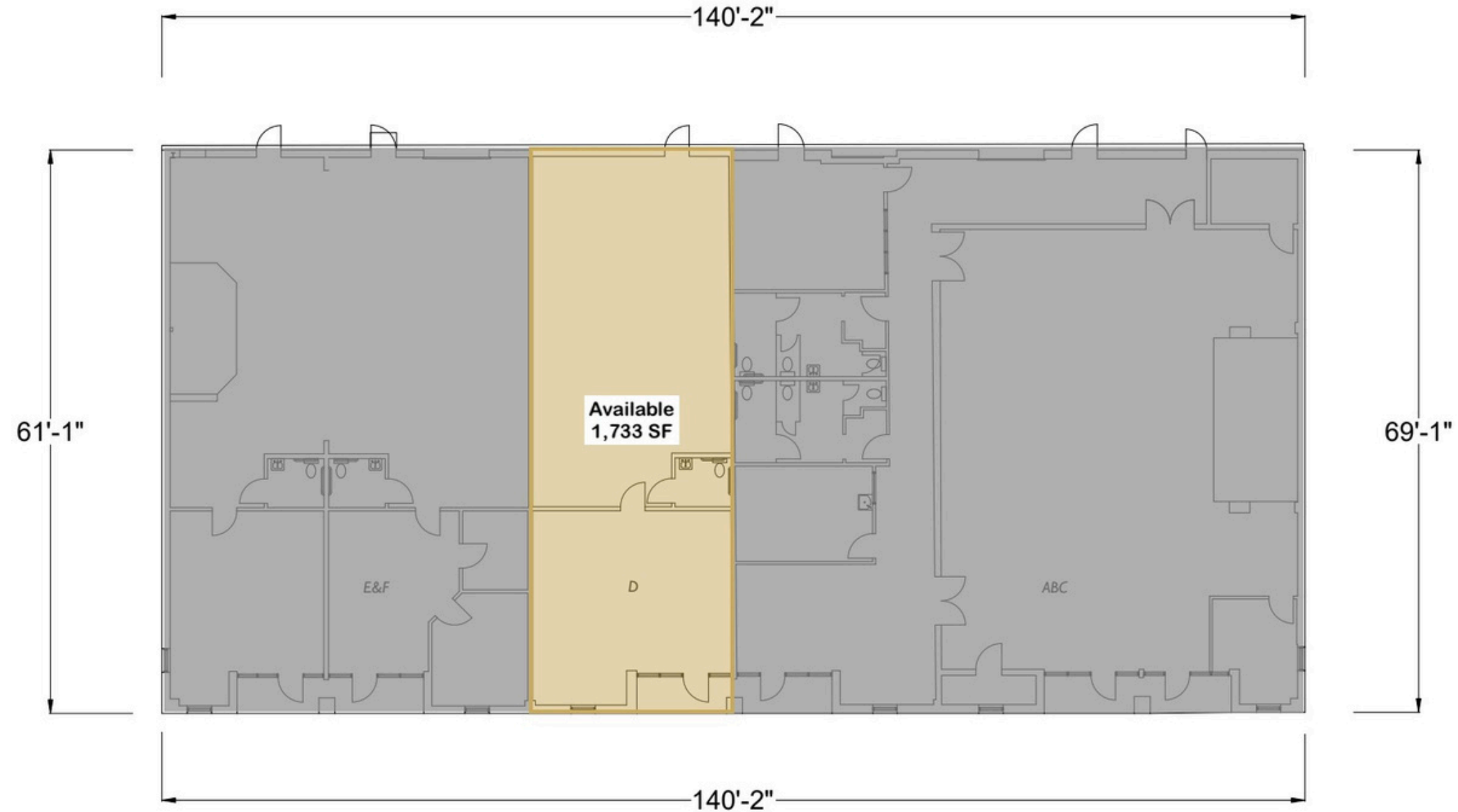

NIKITA ZHITOV

[919.888.1285 | nikita@cityplat.com

CITYPLAT
COMMERCIAL REAL ESTATE

RETAIL PROPERTY FOR LEASE



1104 GREAT FALLS CT

Knightdale, NC 27545

RETAIL PROPERTY FOR LEASE

AERIAL LOOKING SOUTH

Knightdale Blvd

Great Falls Ct



NIKITA ZHITOV

[919.888.1285 | nikita@cityplat.com

CITYPLAT
COMMERCIAL REAL ESTATE

1104 GREAT FALLS CT

Knightdale, NC 27545

RETAIL PROPERTY FOR LEASE

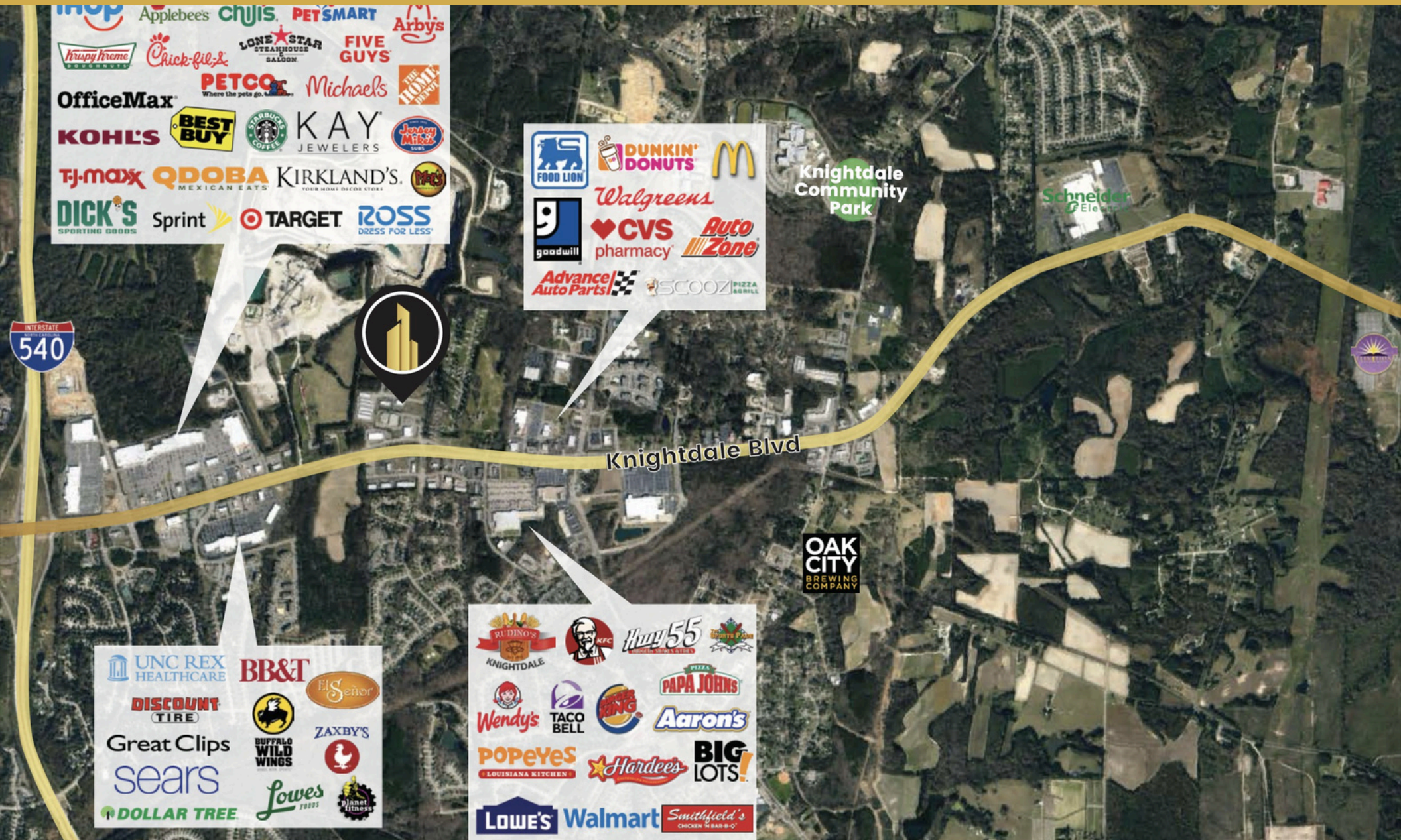

NIKITA ZHITOV

[919.888.1285 | nikita@cityplat.com

CITYPLAT
COMMERCIAL REAL ESTATE

1104 GREAT FALLS CT

Knightdale, NC 27545

RETAIL PROPERTY FOR LEASE

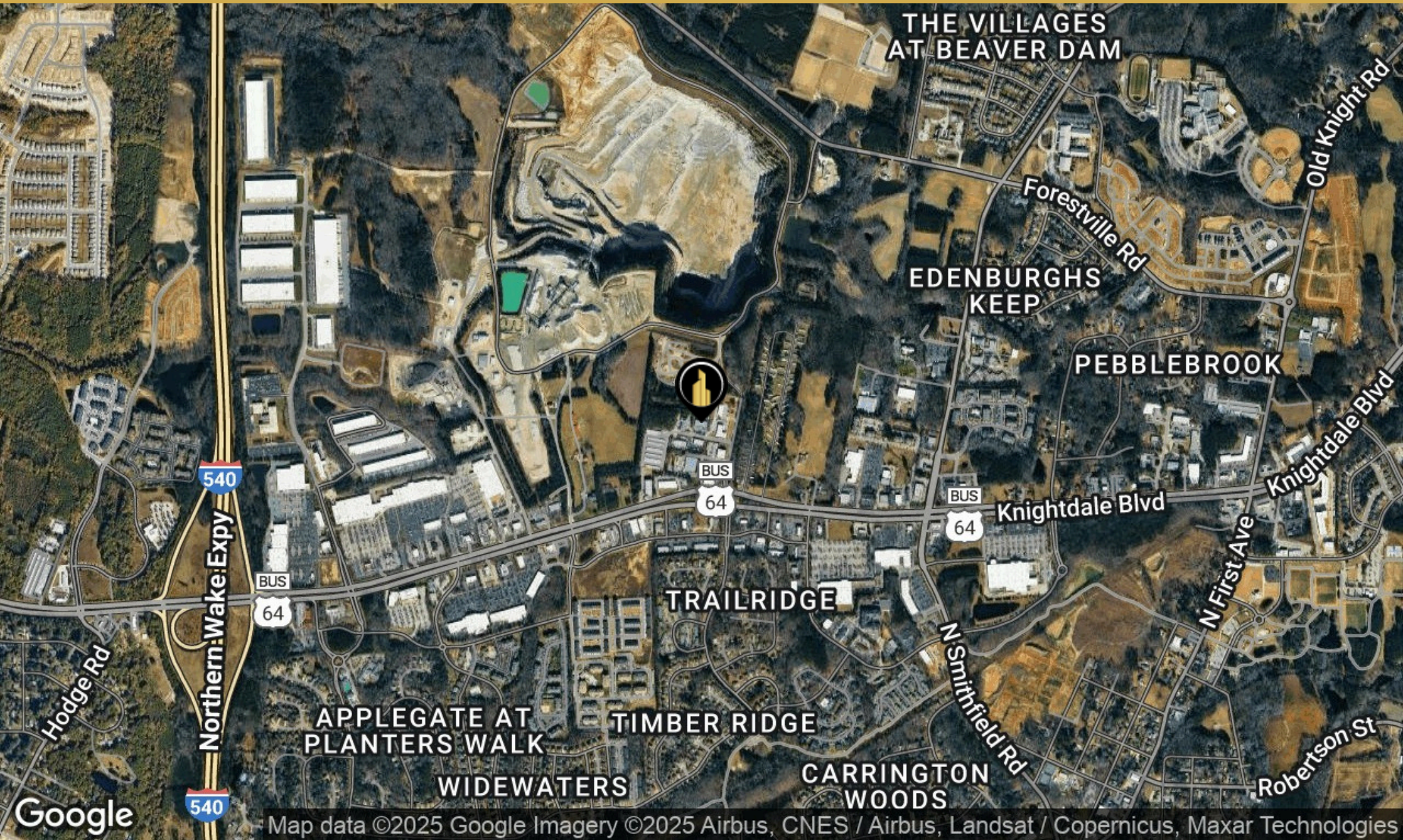

NIKITA ZHITOV

[919.888.1285 | nikita@cityplat.com

CITYPLAT
COMMERCIAL REAL ESTATE

1104 GREAT FALLS CT

Knightdale, NC 27545

RETAIL PROPERTY FOR LEASE



LOCATION DESCRIPTION

Knightdale is located in eastern Wake County, just minutes away from Raleigh, North Carolina's state capital. The Town is home to nearly 16,000 residents with a robust transportation system to support our emerging business base. Incorporated in 1927, Knightdale's jurisdiction covers approximately 17.85 square miles. Knightdale is a vibrant and youthful community located in one of the fastest growing regions in the country.

Knightdale offers businesses and residents easy access to the Research Triangle Region by way of I-540 and US Highway 64. Thanks to the designated I-87, the entire eastern seaboard is within reach by way of I-95 (less than 40 minutes away). In addition, RDU International Airport is only a 27 minute drive from Knightdale via I-540.

The Town's commitment to parks, greenways and open space makes it an excellent place to raise a family. Knightdale Station Park is over 70 acres and includes miles of paved trails, a dog park, athletic fields, playgrounds, bathrooms, large picnic shelters, amphitheater and a Veteran's Memorial.

Since 2000, Knightdale has grown by 153%. It is the 10th fastest growing municipality in North Carolina.

Knightdale is a wonderful place to live, raise a family, work and establish a business. In addition to providing a highly desirable quality of life for every type of business and its workforce, Knightdale an excellent marketplace for businesses and entrepreneurs to offer goods and services of all descriptions.



NIKITA ZHITOV

[919.888.1285 | nikita@cityplat.com

CITYPLAT
COMMERCIAL REAL ESTATE

1104 GREAT FALLS CT

Knightdale, NC 27545

RETAIL PROPERTY FOR LEASE

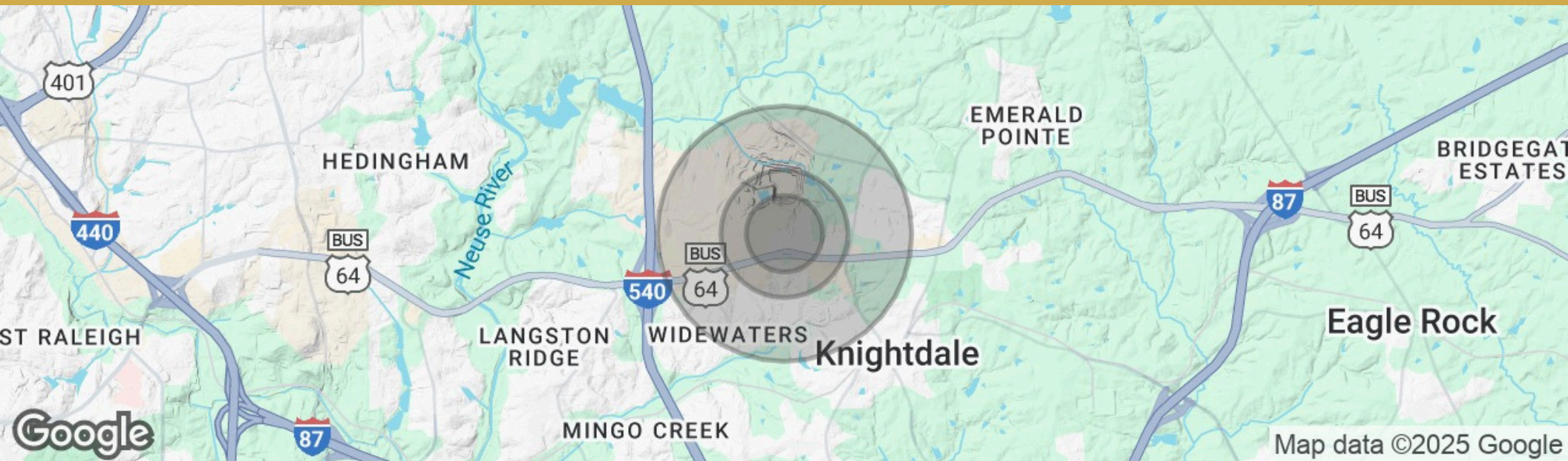

POPULATION

	0.3 MILES	0.5 MILES	1 MILE
Total Population	276	923	6,264
Average Age	39	39	39
Average Age (Male)	37	37	37
Average Age (Female)	40	40	40

HOUSEHOLDS & INCOME

	0.3 MILES	0.5 MILES	1 MILE
Total Households # of Persons per HH	108	369	2,477
Average HH Income Average House	2.6	2.5	2.5
Value	\$99,475	\$91,583	\$87,206
Demographics data derived from AlphaMap	\$348,653	\$343,313	\$355,854

NIKITA ZHITOV

[919.888.1285 | nikita@cityplat.com

CITYPLAT
COMMERCIAL REAL ESTATE

1104 GREAT FALLS CT

Knightdale, NC 27545

RETAIL PROPERTY FOR LEASE



Nikita Zhitov

919.888.1285

nikita@cityplat.com



Brooke Denton

919.888.1285

brooke@cityplat.com



NIKITA ZHITOV

|919.888.1285 | nikita@cityplat.com



1104 GREAT FALLS CT

Knightdale, NC 27545

RETAIL PROPERTY FOR LEASE

CONFIDENTIALITY & DISCLAIMER

All materials and information received or derived from City Plat its directors, officers, agents, advisors, affiliates and/or any third party sources are provided without representation or warranty as to completeness, veracity, or accuracy, condition of the property, compliance or lack of compliance with applicable governmental requirements, developability or suitability, financial performance of the property, projected financial performance of the property for any party's intended use or any and all other matters.

Neither City Plat its directors, officers, agents, advisors, or affiliates makes any representation or warranty, express or implied, as to accuracy or completeness of the any materials or information provided, derived, or received. Materials and information from any source, whether written or verbal, that may be furnished for review are not a substitute for a party's active conduct of its own due diligence to determine these and other matters of significance to such party. City Plat will not investigate or verify any such matters or conduct due diligence for a party unless otherwise agreed in writing.

EACH PARTY SHALL CONDUCT ITS OWN INDEPENDENT INVESTIGATION AND DUE DILIGENCE.

Any party contemplating or under contract or in escrow for a transaction is urged to verify all information and to conduct their own inspections and investigations including through appropriate third party independent professionals selected by such party. All financial data should be verified by the party including by obtaining and reading applicable documents and reports and consulting appropriate independent professionals. City Plat makes no warranties and/or representations regarding the veracity, completeness, or relevance of any financial data or assumptions. City Plat does not serve as a financial advisor to any party regarding any proposed transaction. All data and assumptions regarding financial performance, including that used for financial modeling purposes, may differ from actual data or performance. Any estimates of market rents and/or projected rents that may be provided to a party do not necessarily mean that rents can be established at or increased to that level. Parties must evaluate any applicable contractual and governmental limitations as well as market conditions, vacancy factors and other issues in order to determine rents from or for the property.

Legal questions should be discussed by the party with an attorney. Tax questions should be discussed by the party with a certified public accountant or tax attorney. Title questions should be discussed by the party with a title officer or attorney. Questions regarding the condition of the property and whether the property complies with applicable governmental requirements should be discussed by the party with appropriate engineers, architects, contractors, other consultants and governmental agencies. All properties and services are marketed by City Plat in compliance with all applicable fair housing and equal opportunity laws.

NIKITA ZHITOV

[919.888.1285 | nikita@cityplat.com

