

RETAIL SPACE FOR LEASE



50 SW CUTOFF

WORCESTER, MA 01604



TODD ALEXANDER

Executive Vice President

alexander@kelleher-sadowsky.com

O: 508.841.6201

C: 508.981.7014

WILLIAM D. KELLEHER, IV

Principal

wkelleher@kelleher-sadowsky.com

O: 508.635.6785

C: 508.596.5395

JAMES COZZA

Vice President

cozza@kelleher-sadowsky.com

O: 508.635.6782

C: 508.450.4271

EXECUTIVE SUMMARY



OFFERING SUMMARY

Property Type:	Retail
Building Size:	98,000 SF
Available SF:	1,250 - 15,000 SF
Lease Rate:	Negotiable

PROPERTY OVERVIEW

- 98K square foot neighborhood shopping center located at the intersection of Southwest Cutoff (Route 20) and Sunderland Road in Worcester.
- New ownership with many renovations taking place including new façade, parking lot, and pylon signs
- Tenants include the newly announced Worcester Registry of Motor Vehicles, CVS, Ninety Nine Restaurant, Chuck E Cheese, and more.
- Easy access with an abundance of parking and more than 24,600 ADT
- Spaces available: 1,250 SF, 6,630 SF end-cap (can be combined for 7,880 SF) and 15,000 SF

DEMOGRAPHICS	1 MILE	3 MILES	5 MILES
Total Households	3,643	26,343	74,049
Total Population	8,192	64,957	189,832
Average HH Income	\$77,336	\$71,826	\$65,645



Voted Best Commercial Real Estate Brokerage - Worcester Business Journal
120 Front Street, Suite 210 | Worcester, MA 01608 | 508.755.0707 | kelleher-sadowsky.com

TODD ALEXANDER

Executive Vice President

alexander@kelleher-sadowsky.com

O: 508.841.6201

C: 508.981.7014

WILLIAM D. KELLEHER, IV

Principal

wkelleher@kelleher-sadowsky.com

O: 508.635.6785

C: 508.596.5395

JAMES COZZA

Vice President

cozza@kelleher-sadowsky.com

O: 508.635.6782

C: 508.450.4271

FOR LEASE | 50 SW CUTOFF

ADDITIONAL PHOTOS



Voted Best Commercial Real Estate Brokerage - Worcester Business Journal
120 Front Street, Suite 210 | Worcester, MA 01608 | 508.755.0707 | kelleher-sadowsky.com

TODD ALEXANDER

Executive Vice President

alexander@kelleher-sadowsky.com

O: 508.841.6201

C: 508.981.7014

WILLIAM D. KELLEHER, IV

Principal

wkelleher@kelleher-sadowsky.com

O: 508.635.6785

C: 508.596.5395

JAMES COZZA

Vice President

cozza@kelleher-sadowsky.com

O: 508.635.6782

C: 508.450.4271

This information has been obtained from sources believed reliable. We have not verified it and make no guarantee, warranty or representation about it. Any projections, opinions, assumptions or estimates used are for example only and do not represent the current or future performance of the property. You and your advisors should conduct an independent investigation of the property to determine to your own satisfaction the suitability of the property for your needs.

FOR LEASE | 50 SW CUTOFF

ADDITIONAL PHOTOS



Voted Best Commercial Real Estate Brokerage - Worcester Business Journal
120 Front Street, Suite 210 | Worcester, MA 01608 | 508.755.0707 | kelleher-sadowsky.com

TODD ALEXANDER

Executive Vice President

alexander@kelleher-sadowsky.com

O: 508.841.6201

C: 508.981.7014

WILLIAM D. KELLEHER, IV

Principal

wkelleher@kelleher-sadowsky.com

O: 508.635.6785

C: 508.596.5395

JAMES COZZA

Vice President

cozza@kelleher-sadowsky.com

O: 508.635.6782

C: 508.450.4271

This information has been obtained from sources believed reliable. We have not verified it and make no guarantee, warranty or representation about it. Any projections, opinions, assumptions or estimates used are for example only and do not represent the current or future performance of the property. You and your advisors should conduct an independent investigation of the property to determine to your own satisfaction the suitability of the property for your needs.

SITE PLAN

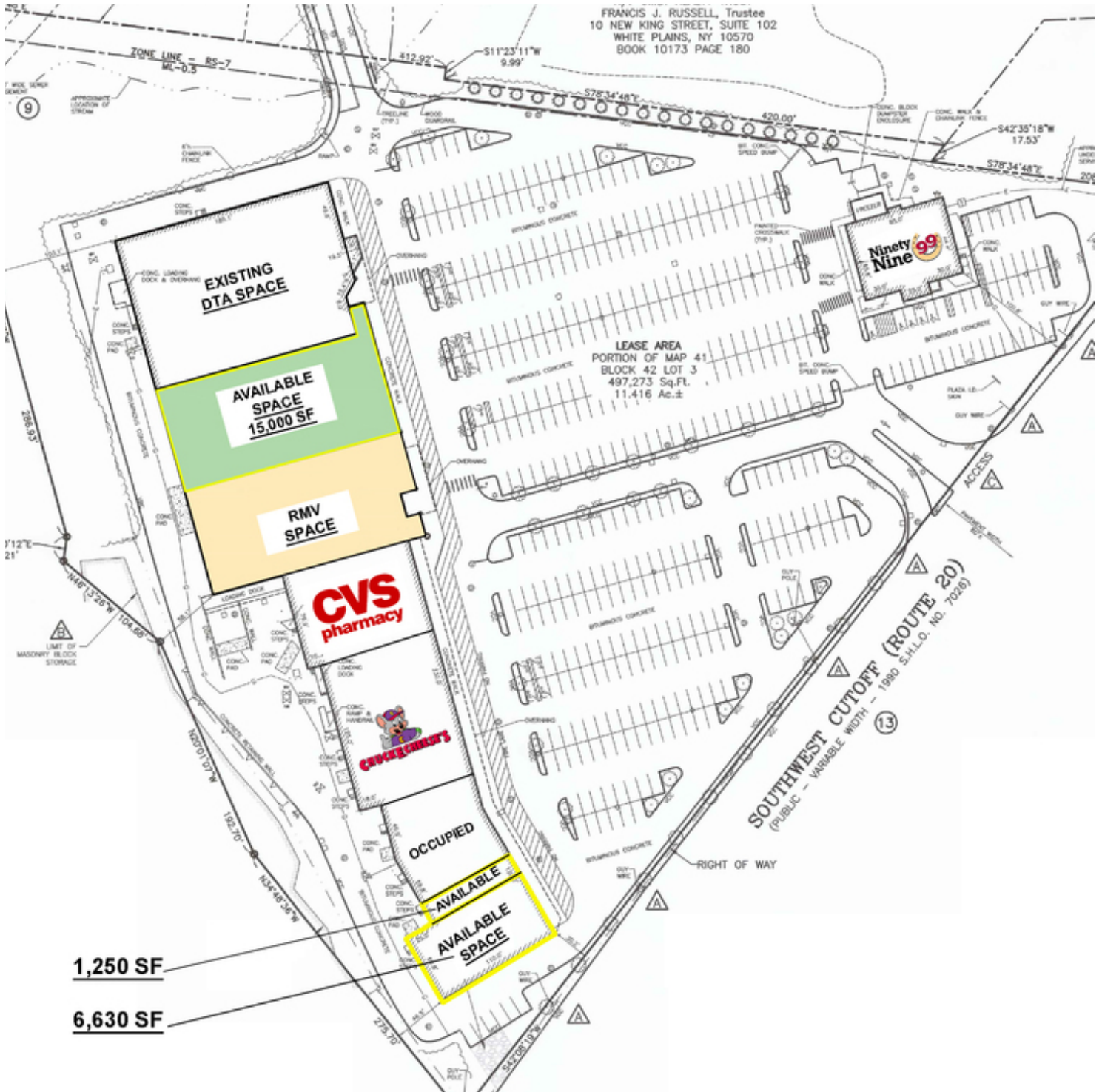

TODD ALEXANDER

Executive Vice President

alexander@kelleher-sadowsky.com

O: 508.841.6201

C: 508.981.7014

WILLIAM D. KELLEHER, IV

Principal

wkelleher@kelleher-sadowsky.com

O: 508.635.6785

C: 508.596.5395

JAMES COZZA

Vice President

cozza@kelleher-sadowsky.com

O: 508.635.6782

C: 508.450.4271



Voted Best Commercial Real Estate Brokerage - Worcester Business Journal

120 Front Street, Suite 210 | Worcester, MA 01608 | 508.755.0707 | kelleher-sadowsky.com

AMENITIES MAP

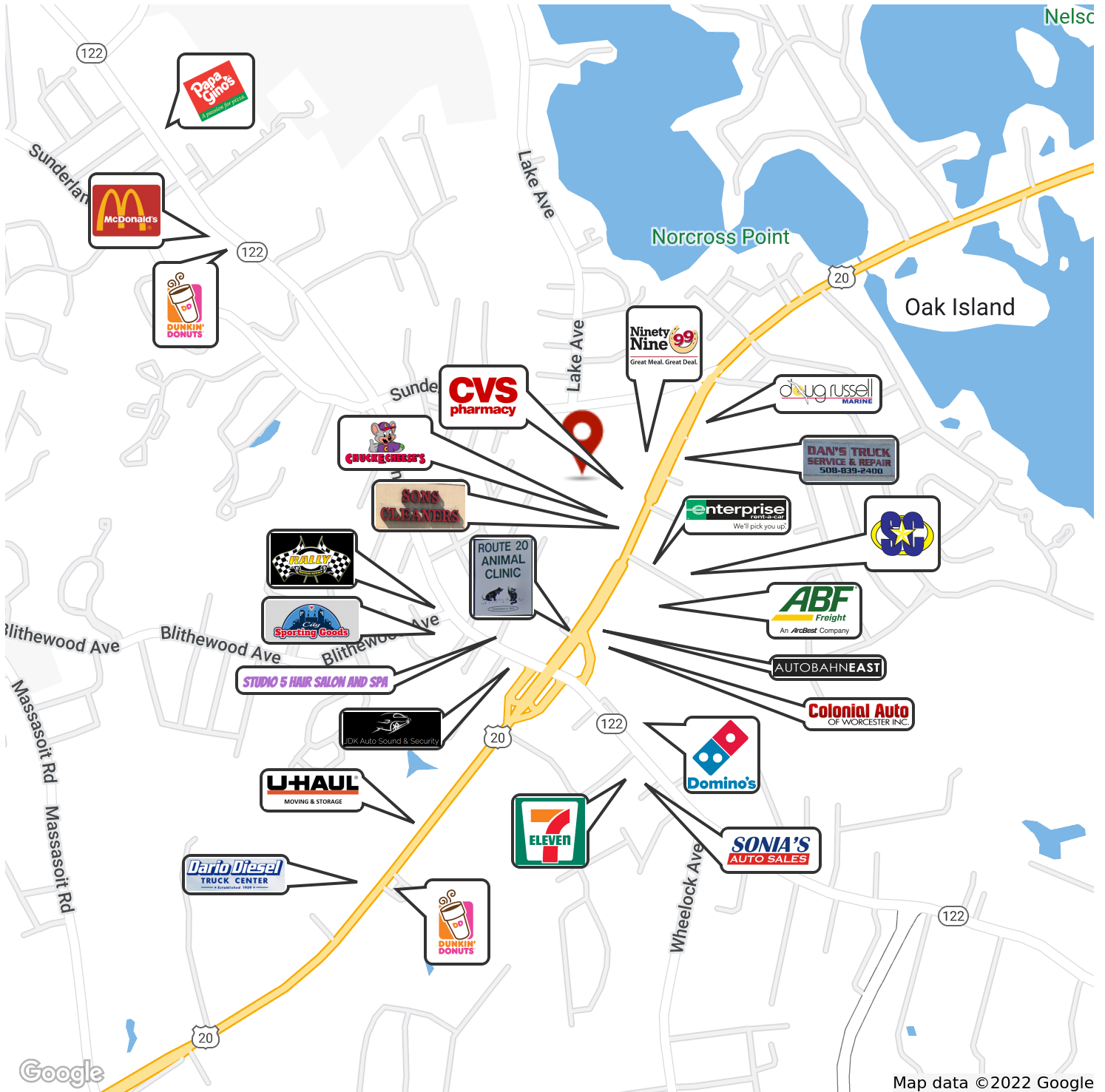

Map data ©2022 Google

TODD ALEXANDER

Executive Vice President

alexander@kelleher-sadowsky.com

O: 508.841.6201

C: 508.981.7014

WILLIAM D. KELLEHER, IV

Principal

wkelleher@kelleher-sadowsky.com

O: 508.635.6785

C: 508.596.5395

JAMES COZZA

Vice President

cozza@kelleher-sadowsky.com

O: 508.635.6782

C: 508.450.4271



Voted Best Commercial Real Estate Brokerage - Worcester Business Journal

120 Front Street, Suite 210 | Worcester, MA 01608 | 508.755.0707 | kelleher-sadowsky.com