

FOR LEASE

315 NW LAURENT ST

Topeka, KS 66608

KANSAS COMMERCIAL  
REAL ESTATE SERVICES, INC.



## PROPERTY DESCRIPTION

Office/warehouse with a fenced yard and approximately 1,250<sup>±</sup> SF of office space.

## VIRTUAL WALK-THRU LINK

<https://my.matterport.com/show/?m=y5huwe18W8j>



## OFFERING SUMMARY

Lease Rate	\$7.68 SF/yr
Base Rate/MO	\$2,500.00
Building Size	5,000 <sup>±</sup> SF
Lot Size	25,899 <sup>±</sup> SF
Year Built	1978
Zoning	X2

Tenant pays utilities, janitorial, and interior/exterior maintenance. Landlord pays roof and structural maintenance, real estate taxes, and property insurance.

## BUILDING SPECS

5,000<sup>±</sup> SF Main building, office, warehouse

Building 1 (East)	20' x 18' +/-
Building 3 (West)	40' x 24' +/-

Listed By:

MARK REZAC

Partner

785.228.5308

mark@kscommercial.com

All information furnished regarding property for sale or lease is from sources deemed reliable; but no warranty or representation is made as to the accuracy thereof and the same is submitted subject to errors, omissions, changes of price, rental or other conditions prior sale or lease, or withdrawal without notice. The purchaser and or leaser should conduct a careful, independent investigation of the property to determine if the property is suitable for your intended use.

KS Commercial Real Estate Services, Inc. // 435 S Kansas Ave., Suite 200, Topeka, KS 66603 // 785.272.2525 // [kscommercial.com](http://kscommercial.com)

FOR LEASE

315 NW LAURENT ST

Topeka, KS 66608

**KANSAS COMMERCIAL**  
REAL ESTATE SERVICES, INC.

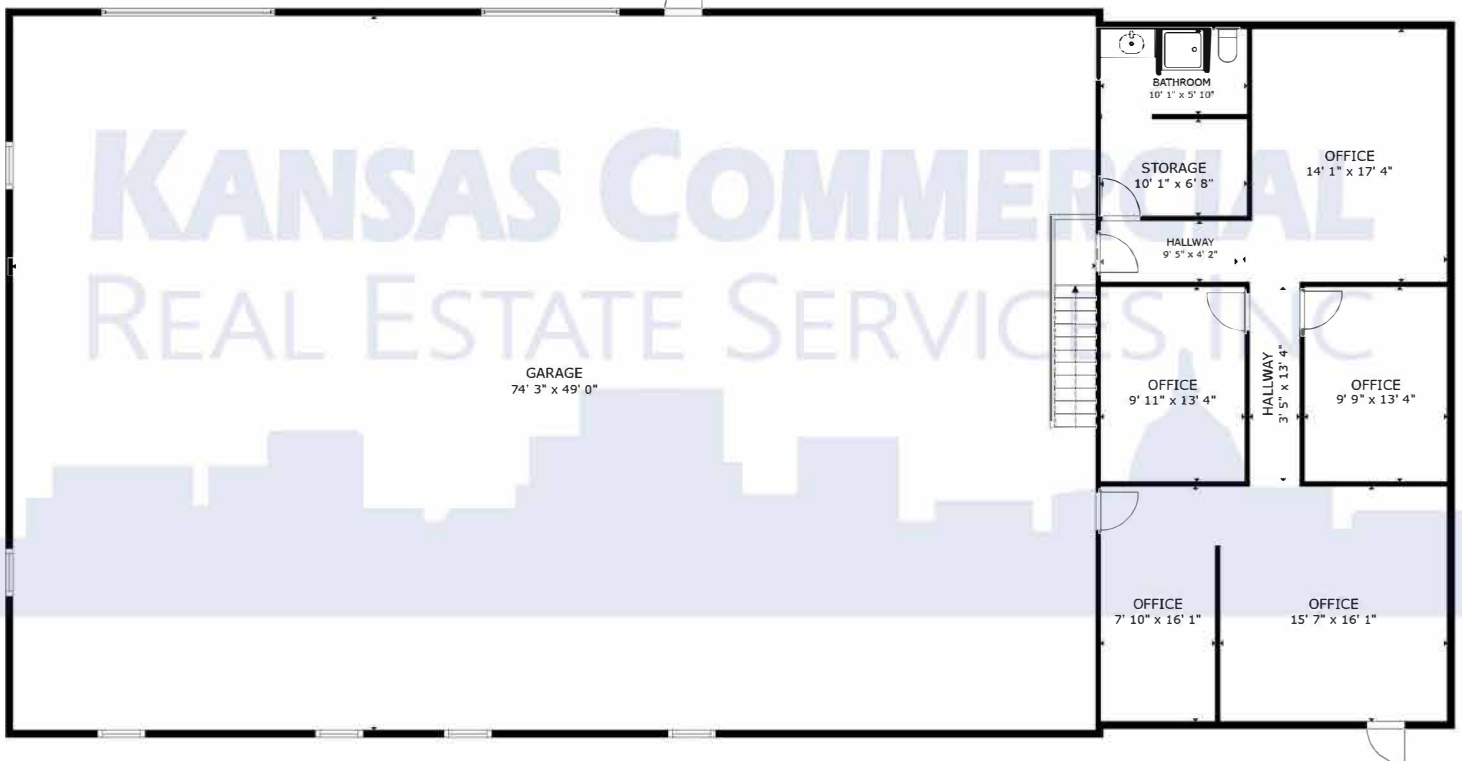

FLOOR PLAN

KS Commercial Real Estate Services, Inc. // 435 S. Kansas Ave., Suite 200, Topeka, KS 66603 // 785.272.2525// kscommercial.com

All information furnished regarding property for sale or lease is from sources deemed reliable; but no warranty or representation is made as to the accuracy thereof and the same is submitted to errors, omissions, changes of price, rental or other conditions prior sale or lease, or withdrawal without notice. The purchaser and or leaser should conduct a careful, independent investigation of the property to determine if the property is suitable for your intended use.