

# SKYPARK INDUSTRIAL CENTRAL

31949 CORYDON ROAD, SUITE 110, LAKE ELSINORE, CA 92530

**+/- 1,448 SF  
INDUSTRIAL SPACE  
FOR LEASE**



**FOR MORE INFORMATION, PLEASE CONTACT:**

**CAREY PASTOR** | Senior Vice President

(951) 297-7434 | [cpastor@cbcsocalgroup.com](mailto:cpastor@cbcsocalgroup.com)

CalDRE License # 01403298



**COLDWELL  
BANKER  
COMMERCIAL  
SC**

# SKYPARK INDUSTRIAL CENTRAL

31949 CORYDON ROAD, SUITE 110, LAKE ELSINORE, CA 92530

**+/- 1,448 SF  
INDUSTRIAL SPACE  
FOR LEASE**



## PROPERTY HIGHLIGHTS

- 1,448 SF Industrial space available
- Industrial or Auto uses allowed
- 200 Amp, 120/208v, 3 phase power supply per unit
- Specific Plan (SP) Zoning, City of Lake Elsinore
- Improvements include a reception area, 1 restroom and warehouse space
- 10 x 10 front loading roll up door



# SKYPARK INDUSTRIAL CENTRAL

31949 CORYDON ROAD, SUITE 110, LAKE ELSINORE, CA 92530

**+/- 1,448 SF  
INDUSTRIAL SPACE  
FOR LEASE**

## AVAILABILITY

UNIT	UNIT SIZE	MONTHLY LEASE RATE	DESCRIPTION
110	±1,448 SF	\$2,317.00 Per month	Reception area, restroom and warehouse. 10x10 GL roll up door and man door

Rental Rates are Industrial Gross - No CAM or NNN Fees

## FLOOR PLAN

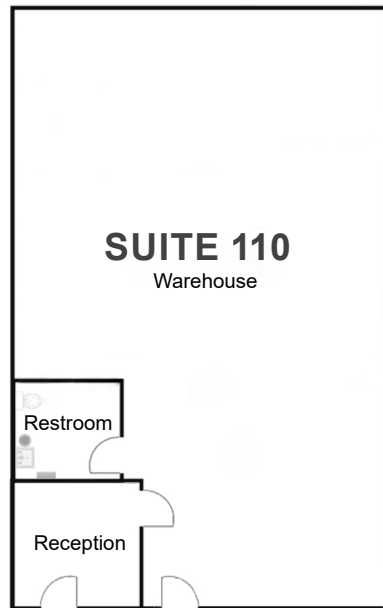

\*Not to scale

## SITE PLAN

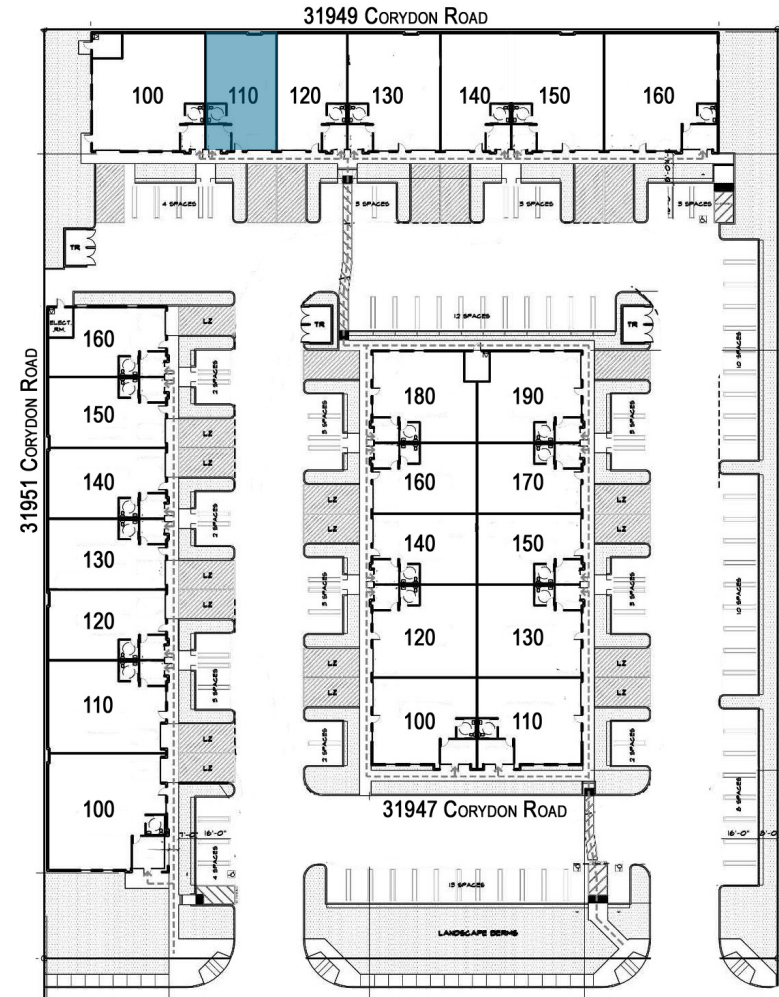

**CORYDON ROAD**



# SKYPARK INDUSTRIAL CENTRAL

31949 CORYDON ROAD, SUITE 110, LAKE ELSINORE, CA 92530

+/- 1,448 SF  
INDUSTRIAL SPACE  
FOR LEASE





# SKYPARK INDUSTRIAL CENTRAL

31949 CORYDON ROAD, SUITE 110, LAKE ELSINORE, CA 92530

+/- 1,448 SF  
INDUSTRIAL SPACE  
FOR LEASE



Coldwell Banker Commercial and the Coldwell Banker Commercial Logo are registered service marks licensed to Coldwell Banker Commercial Affiliates. Each Office is Independently Owned and Operated. All information contained herein has been obtained from sources deemed reliable. However, no warranty or guarantee is made as to the accuracy of the information.

CalDRE License # 02089395

# SKYPARK INDUSTRIAL CENTRAL

31949 CORYDON ROAD, SUITE 110, LAKE ELSINORE, CA 92530

**+/- 1,448 SF  
INDUSTRIAL SPACE  
FOR LEASE**



**FOR MORE INFORMATION, PLEASE CONTACT:**

**CAREY PASTOR**

Senior Vice President

951.297.7434

[cpastor@cbcsocalgroup.com](mailto:cpastor@cbcsocalgroup.com)

CalDRE # 01403298

27368 Via Industria | Suite 102  
Temecula | California | 92590  
t 951.200.7683 | f 951.239.3147  
[cbcsocalgroup.com](http://cbcsocalgroup.com)



**COLDWELL  
BANKER  
COMMERCIAL  
SC**