

Available
For Sale

16,000 SF
Industrial/
Manufacturing
Facility

506 Pasadena Avenue

Crest Hill, Illinois 60403

PROPERTY HIGHLIGHTS

Well-maintained, freestanding industrial/manufacturing facility located in Will County.



AVAILABLE FOR SALE
16,000 SF



18'
CEILING HEIGHT



2 DRIVE IN DOORS



ASKING PRICE:
\$1,250,000



LOCATED IN
WILL COUNTY

Broker Contact Info

Steve Connolly
+1 630 693 0642
sconnolly@hiffman.com

Michael Kraft
+1 630 693 0661
mkraft@hiffman.com

Mark Moran
+1 630 693 0656
mmoran@hiffman.com

One Oakbrook Terrace
Suite 400
Oakbrook Terrace, Illinois 60181
+1 630 932 1234

NO WARRANTY OR REPRESENTATION, EXPRESS OR IMPLIED, IS MADE AS TO THE ACCURACY OF THE INFORMATION CONTAINED HEREIN, AND THE SAME IS SUBMITTED SUBJECT TO ERRORS, OMISSIONS, CHANGE OF PRICE, RENTAL OR OTHER CONDITIONS, PRIOR SALE, LEASE OR FINANCING, OR WITHDRAWAL WITHOUT NOTICE, AND OF ANY SPECIAL LISTING CONDITIONS IMPOSED BY OUR PRINCIPALS NO WARRANTIES OR REPRESENTATIONS ARE MADE AS TO THE CONDITION OF THE PROPERTY OR ANY HAZARDS CONTAINED THEREIN ARE ANY TO BE IMPLIED.

SITE PLAN

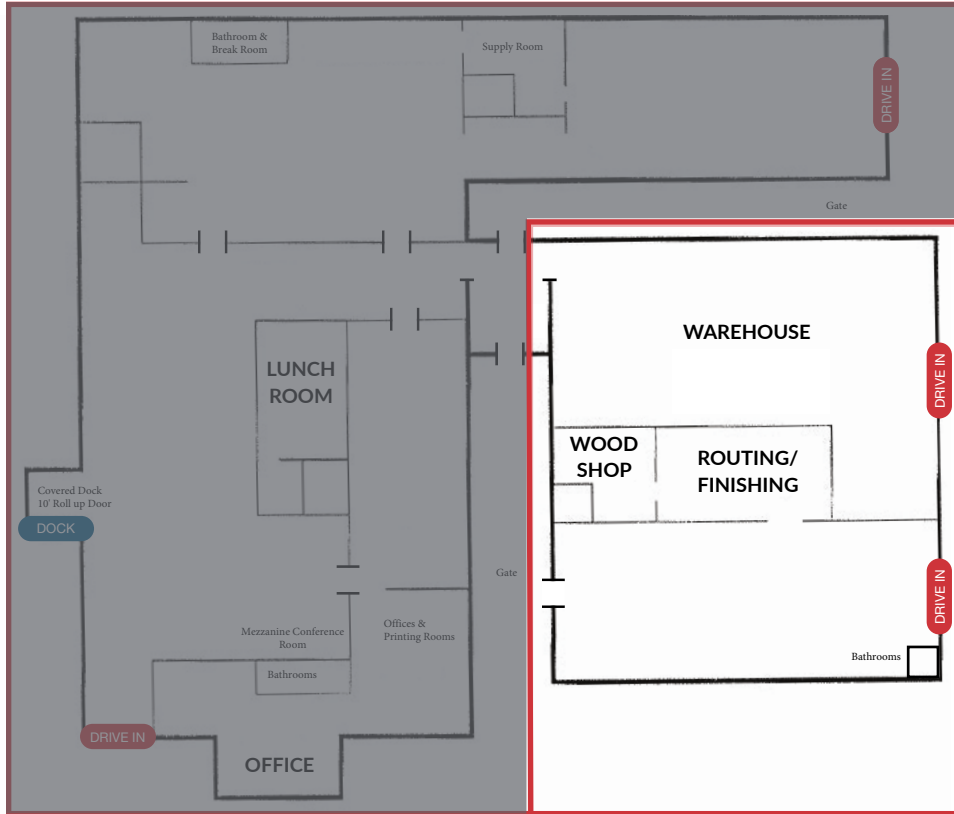

508

506



506 PROPERTY HIGHLIGHTS

- 16,000 SF available for sale
- 18' ceiling height
- 2 drive-in doors
- Asking Price: \$1,250,000



CALL A NAI HIFFMAN BROKER TODAY!

Steve Connolly

+1 630 693 0642
sconnolly@hiffman.com

Michael Kraft

+1 630 693 0661
mkraft@hiffman.com

Mark Moran

+1 630 693 0656
mmoran@hiffman.com

