

11330 Olive Blvd

Creve Coeur, MO 63141

**3,398 SF – 29,640 SF
OFFICE FOR LEASE**

- Full Floor Opportunity
- Monument Signage Available Visible to Olive Blvd
- Newly Renovated Common Areas
- Updated Cafe & Outdoor Patio
- Fitness Center
- Building Conference Room
- Back-up Generator
- 4/1,000 SF Parking Ratio
- Lease Rate: \$24.00 PSF, Full Service

FOR MORE INFORMATION CONTACT:

Jim Loft, CCIM, SIOR | (314) 696-1400
jloft@gershmancre.com

Dan Freeland, CCIM, SIOR | (314) 889-0605
dfreeland@gershmancre.com

Fallon Chambers | (314) 746-1425
fchambers@gershmancre.com



GERSHMANCRE.COM





11330 Olive Blvd

Second Floor

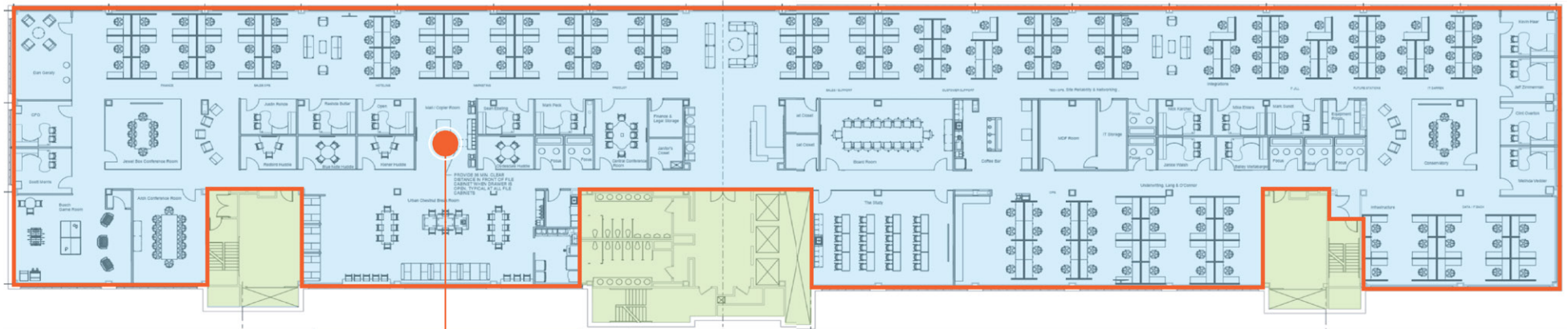

Suite 200
10,000 SF–29,640 SF

Third Floor

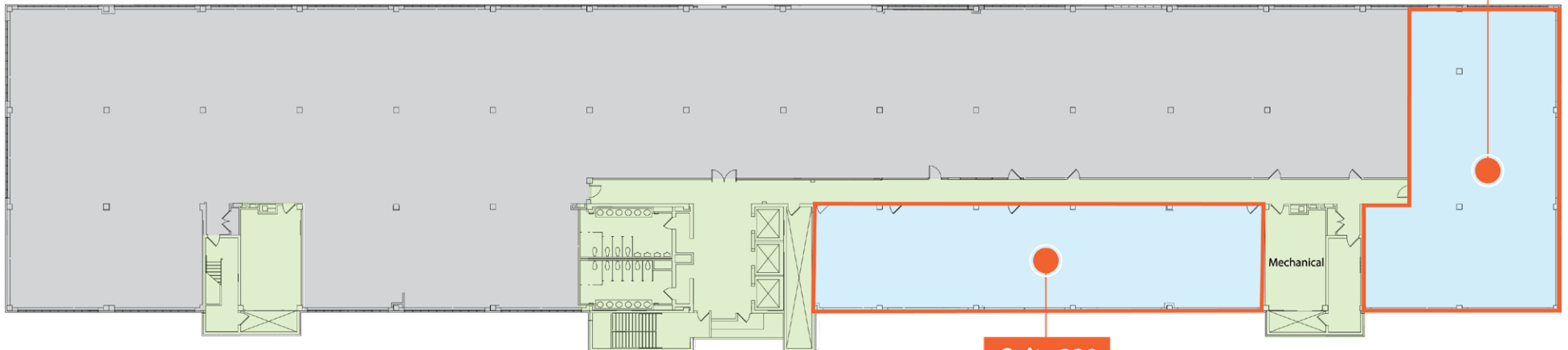

Suite 320
3,398 SF

Suite 310
3,647 SF



11330
Olive Blvd



Conference Room



Fitness Center



New Lobby



New Lobby



11330 Olive Blvd



Gershman
Commercial Real Estate

The information contained herein is not warranted, although it has been obtained from the owner of the property or from other sources we deem reliable. It is subject to change without notice. Owner and broker make no representation as to the environmental condition of the property and recommend purchaser's/tenant's independent investigation.

GERSHMANCRE.COM