

FOR LEASE

12,500 SF INDUSTRIAL UNIT



7 Jules Lane - New Brunswick, NJ



FOR ADDITIONAL INFORMATION, PLEASE CONTACT:

Lorenzo Lambiase, MBA, CCIM
Associate Vice President
201 488 5800 x176
llambiase@naihanson.com

Patrick Lennon
Vice President
201 488 5800 x109
plennon@naihanson.com

Kenneth D. Lundberg, SIOB
Senior Vice President
201 488 5800 x138
klundberg@naihanson.com

A PROJECT BY:
BRISTOL GROUP

NAI James E. Hanson
COMMERCIAL REAL ESTATE SERVICES, WORLDWIDE

FOLLOW US!      | Teterboro | Parsippany | Allentown | naihanson.com | naisummit.com | Member of NAI Global with 325+ Offices Worldwide

SERVICES OFFERED

Brokerage • Property Management • Corporate Services • Financing • Logistics • Landlord Representation • Healthcare • Tenant Representation • Cold Storage • Investment Services

The information contained herein has been obtained from sources considered to be reliable, but no guarantee of its accuracy is made by NAI James E. Hanson

FOR LEASE

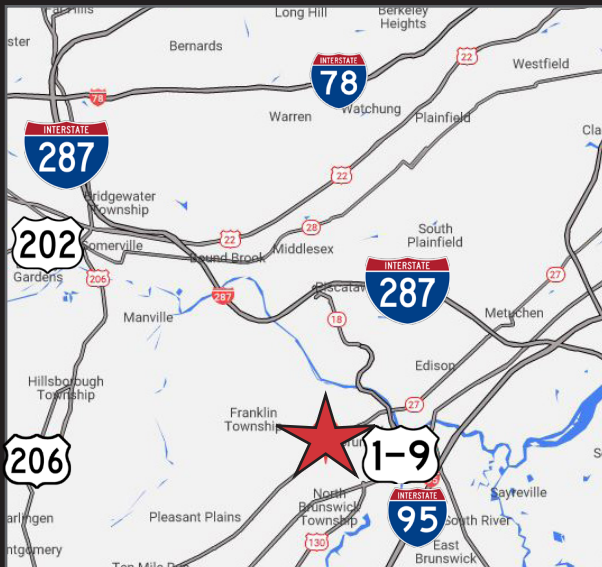
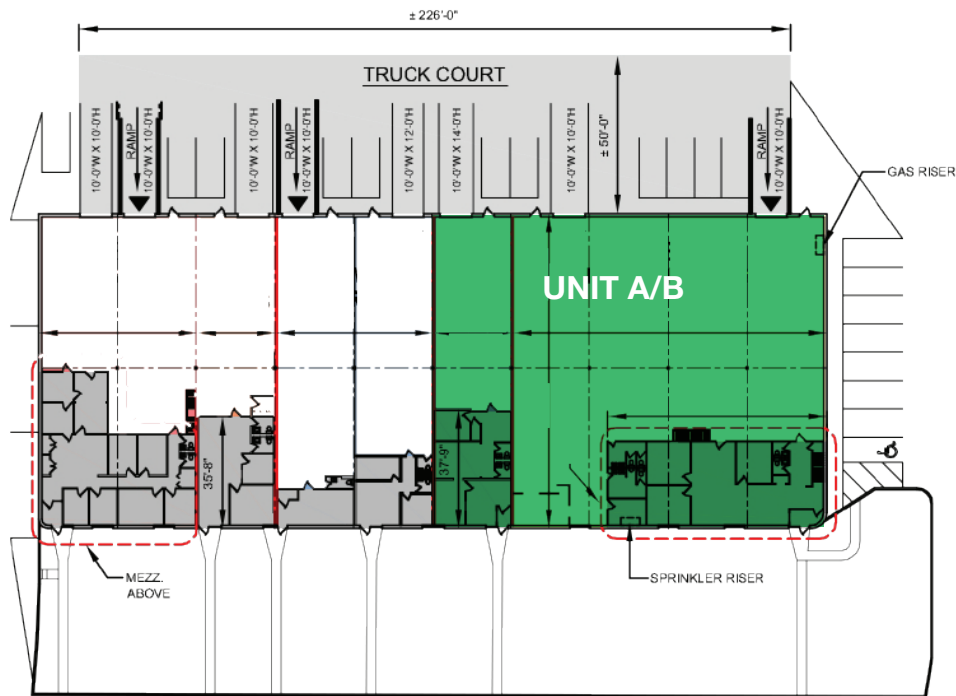

PROPERTY FEATURES

- Available: 12,500 SF | Unit A/B
- Building Size: 25,000 SF
- One (1) Tailgate
- Two (2) Drive-ins
- 18' Ceiling Height
- NNN Lease
- Easy Access to Routes 1, 18 and the NJ Turnpike

FOR ADDITIONAL INFORMATION, PLEASE CONTACT:

Lorenzo Lambiasi, MBA, CCIM
Associate Vice President
201 488 5800 x176
llambiasi@naihanson.com

Patrick Lennon
Vice President
201 488 5800 x109
plennon@naihanson.com

Kenneth D. Lundberg, SIOR
Senior Vice President
201 488 5800 x138
klundberg@naihanson.com

A PROJECT BY:
BRISTOL GROUP

NAI James E. Hanson
COMMERCIAL REAL ESTATE SERVICES, WORLDWIDE