

C:\Program Files\AutoCAD LT 97\PROJECTS\ASTOR\KING\146.dwg Tue Jul 31 13:47:35 2001

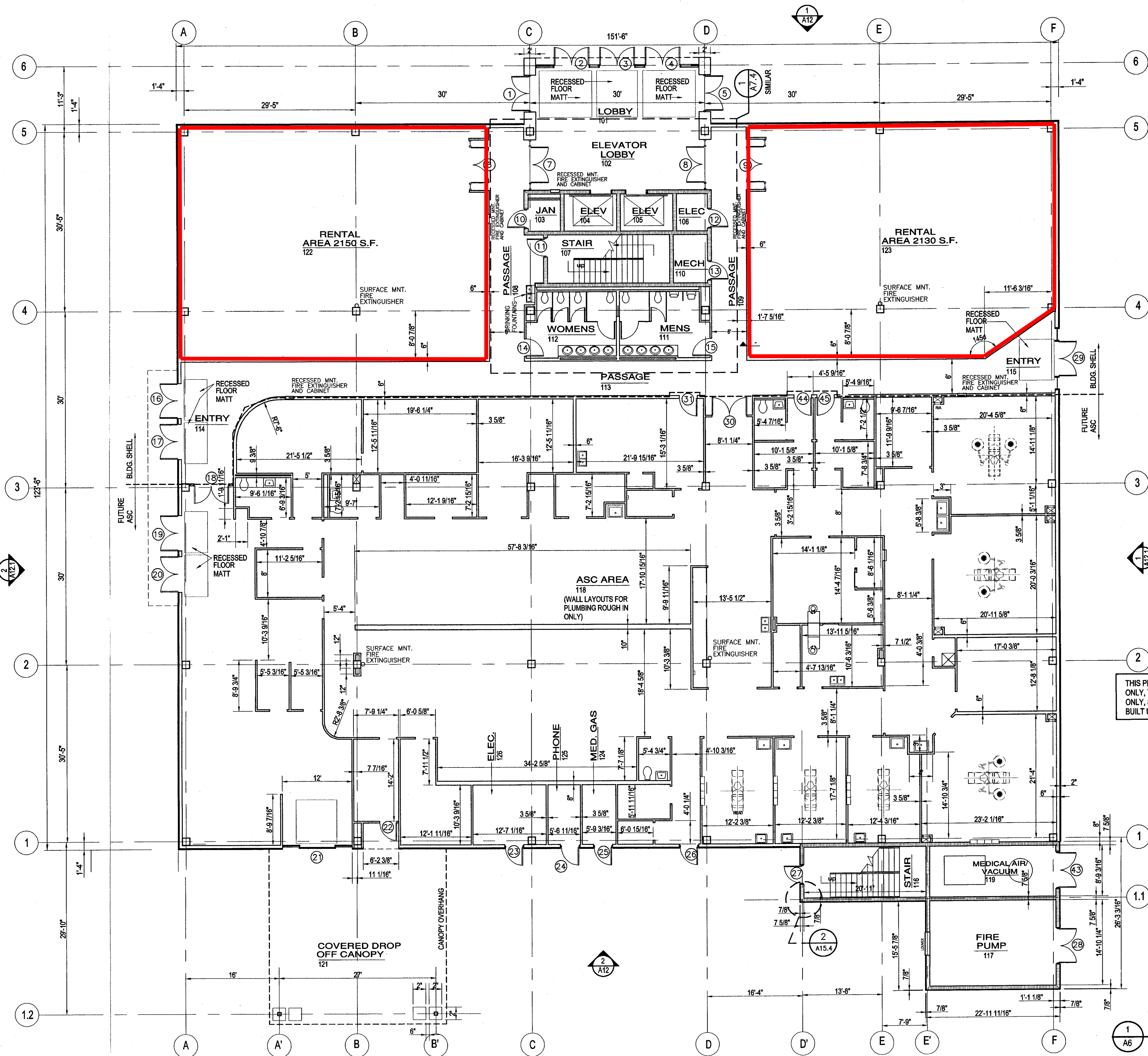

THIS PLAN SHOWS THE FUTURE ASC FLOOR LAYOUT FOR INFORMATION ONLY, THIS SHALL BE USED FOR LAYOUT OF WALLS FOR PLUMBING ROUGH-IN ONLY, SEE SHEET A5 SHELL PLAN FOR ACTUAL WALL TO BE BUILT UNDER THE SHELL CONTRACT.

**LEGEND**

- CG L CORNER GUARD LOCATION
- N WALL TYPE DESIGNATION
- SURFACE MNT. FIRE EXTINGUISHER
- RECESSED MNT. FIRE EXTINGUISHER AND CABINET
- VACUUM ROOM NAME
- 119 ROOM NUMBER
- 43 DOOR DESIGNATION
- MASONRY WALL RE: WALL TYPE LEGEND
- METAL STUD WALL RE: WALL TYPE LEGEND



**AREA TABULATION**  
ASC = 11,400 G.S.F.

**GROUND FLOOR PLAN (ASC FOR INFORMATION ONLY)**

SCALE: 1/8" = 1' 0"

REVISION

PROJECT TITLE: **4 STORY MEDICAL OFFICE BUILDING BILOXI, MISSISSIPPI**

SHEET TITLE: **FOUNTAIN & LAMAS ARCHITECTS LTD. architects & planners**

P.O. BOX 464, 111 RUE MAGNOLIA SUITE BILOXI, MISSISSIPPI, 39533  
PHONE: (1228)336-3399 FAX: (1228)374-0212 E-MAIL: f.lam@fslscape.com

SHEET NUMBER: 596  
DRAWN BY: H&G  
CHECKED BY: JAMS  
REVISED: -  
DATE: AUGUST 2001

SHEET **A-6** OF 29