

# 2500 SOUTH 3850 WEST

WEST VALLEY CITY, UT 84120



OFFICE OR OFFICE/WAREHOUSE LEASE  
AVAILABLE IMMEDIATELY

2,554 - ~30,000 RSF

HUGHES MARINO

# BUILDING INFORMATION

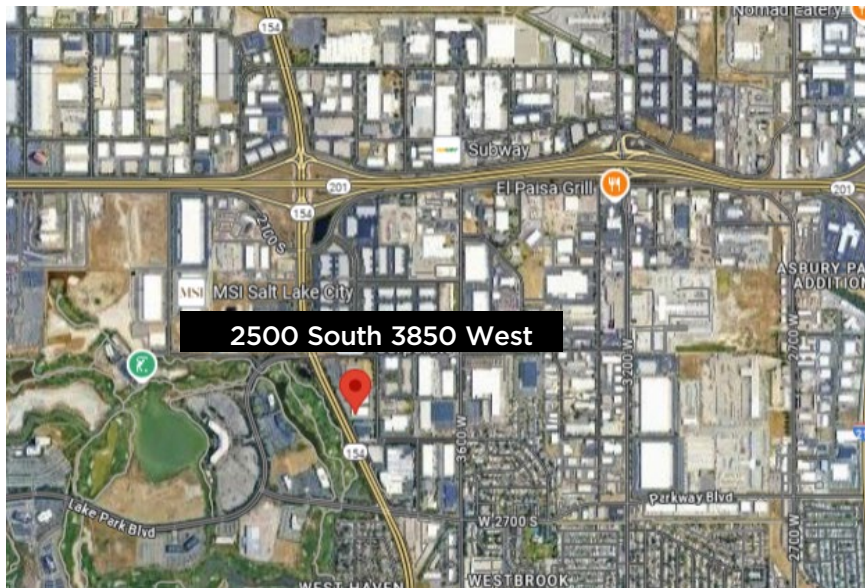

## **BUILDING**

Waterton Place

## **ADDRESS**

2500 South 3850 West  
West Valley City, UT 84120

## **AVAILABLE**

Immediately

## **ASKING RATE**

\$10.00/RSF NNN or \$0.833/SF

## **ADDITIONAL FEATURES**

- Office or Office/Warehouse
- Divisible: 2,554 to approx. 30,000 RSF
- 12' GL door and 14' clear height (potential)
- Shared breakroom
- Immediate access to Bangerter Highway

# FLOOR PLAN

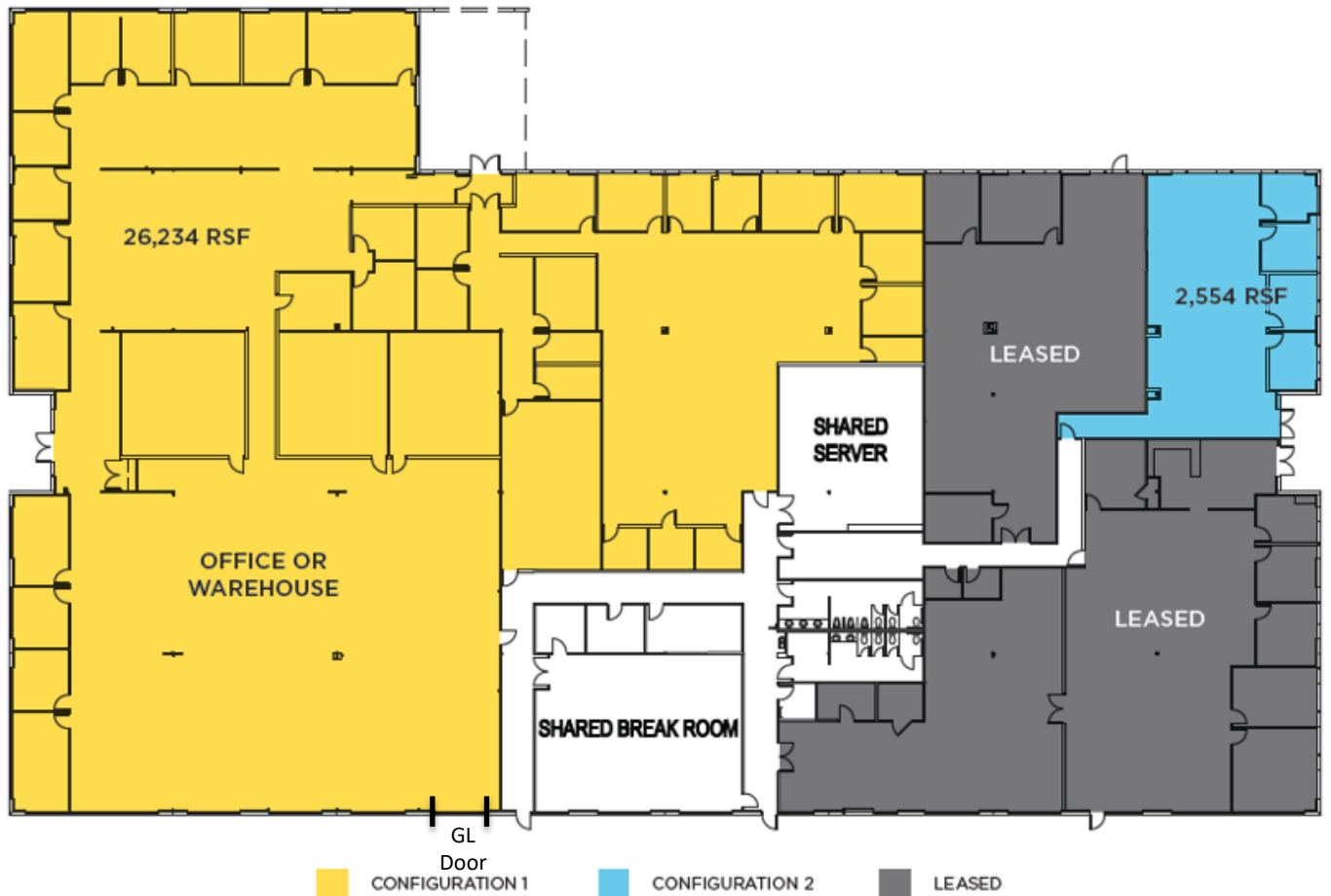

# FLOOR PLAN





2500 SOUTH 3850 WEST





# CONTACT INFORMATION



**LORA MUNSON, CCIM**

[lora.munson@hughesmarino.com](mailto:lora.munson@hughesmarino.com)

801.706.5982

Broker Lic. #5468065-PB00

**6985 UNION PARK CENTER, SUITE 650**  
**COTTONWOOD HEIGHTS, UT 84047**  
801.981.2111 | [hughesmarino.com](http://hughesmarino.com)

**HUGHESMARINO**  
S.L.C., INC.