

1 Mill Ridge Lane Chester, New Jersey

FOR LEASE
637 SF
Office Suite 201B

*One Unit
Available!*



New Availability - All Other Spaces Leased

- Suite 201B: 637 SF available
- Located on second floor near elevator
- Includes 2 offices | reception | waiting area
- Bathroom in common area
- 4:1000 parking
- 16,000 SF building with 2 floors
- Located on corner of Route 24
- Lease Rate: \$20.50 PSF + \$1.75 PSF for Utilities

Additional Information

- Beautiful building with all newly remodeled suites
- High end interior finishes
- Building is wired with fiber
- Professionally landscaped campus
- Professionally maintained common area

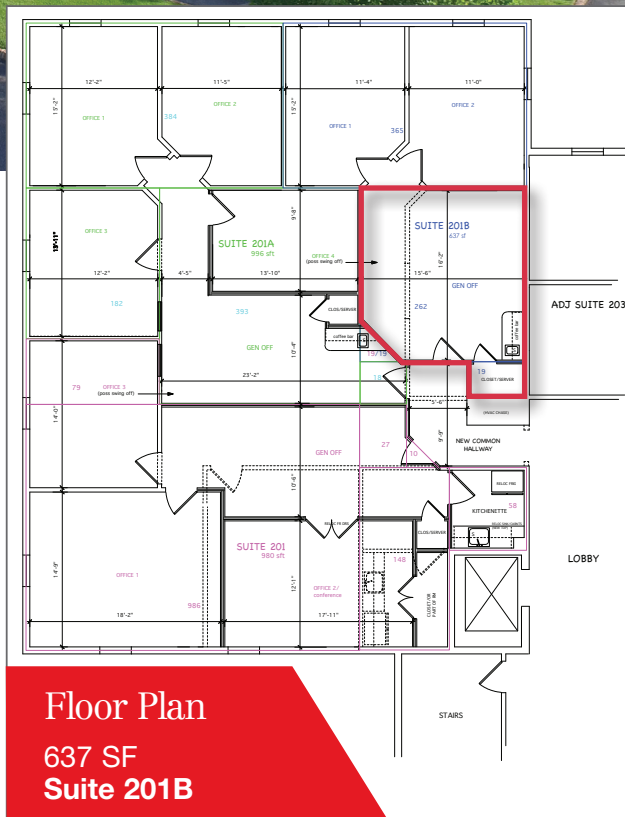

Joseph F. Vindigni 973 463 1011 x169 | jvindigni@naihanson.com

NAI James E. Hanson
COMMERCIAL REAL ESTATE SERVICES, WORLDWIDE

FOLLOW US! | NJ Offices: Teterboro | Parsippany | naihanson.com | Member of NAI Global with 300+ Offices Worldwide

SERVICES OFFERED

Brokerage • Property Management • Corporate Services • Financing • Logistics • Government Services • Healthcare • Tenant Representation • Cold Storage • Investment Services

The information contained herein has been obtained from sources considered to be reliable, but no guarantee of its accuracy is made by NAI James E. Hanson

OFFICE SUITE FOR LEASE
637 SF
 Only Unit Available!

1 Mill Ridge Lane
 Chester, New Jersey



AMENITIES

BANK / RETAIL / SHOPPING

- 1 THE UPS STORE
- 2 BANK OF AMERICA
- 3 STAPLES
- 4 CHESTER MALL
- 5 STREETS OF CHESTER MALL
- 6 COUNTRY CURTAINS
- 7 CHARMING CHARLIE
- 8 THE GAP
- 9 ST'S TIRE SHOP
- 10 MARSHALLS

RESTAURANTS / FAST FOOD / GROCERIES

- 11 SHOPRITE
- 12 ST PUB
- 13 STARBUCKS
- 14 ESTER BAGEL & DELI
- 15 DUNKIN DONUTS
- 16 EAM
- 17 LAMPLIGHTER
- 18
- 19
- 20
- 21
- 22 TAYLOR'S ICE

1 Mill Ridge Lane

NAI James E. Hanson
 COMMERCIAL REAL ESTATE SERVICES, WORLDWIDE