

Property Summary



PROPERTY DESCRIPTION

4 spaces left in this established shopping center. Great visibility with lots of traffic on NW 23rd.

PROPERTY HIGHLIGHTS

- 1) HIGH TRAFFIC STREET
- 2) CLOSE PROXIMITY TO NW 23RD FOR EXCELLENT VISIBILITY
- 3) ESTABLISHED TENANT MIX
- 4) AFFORDABLE RENT WITH FLEXIBLE TERM

DEMOGRAPHICS	1 MILE	3 MILES	5 MILES
Total Households	5,110	25,782	71,243
Total Population	12,973	66,720	178,687
Average HH Income	\$73,263	\$65,487	\$77,585

OFFERING SUMMARY

Lease Rate:	\$10.00 SF/yr (NNN)
Number of Units:	13
Available SF:	880 - 3,000 SF
Building Size:	15,650 SF

SPACES	LEASE RATE	SPACE SIZE
7603 NW 23rd	\$10.00 SF/yr	1,118 SF
7611 NW 23rd	\$10.00 SF/yr	880 SF
7613 NW 23rd	\$10.00 SF/yr	1,500 SF
7615 NW 23rd	\$10.00 SF/yr	1,500 SF

PAUL SWALES

BROKER
 405.477.1894
 PAUL@OKLAHOMACREBROKER.COM

Retail Property For Lease

7601 - 7623 NW 23RD, BETHANY, OK 73008

Location Map



PAUL SWALES

BROKER

405.477.1894

PAUL@OKLAHOMACREBROKER.COM

1508 WEST EDMOND ROAD • • • SALTCOMMERCIAL.REALESTATE

Salt
COMMERCIAL
REAL ESTATE

Retail Property For Lease
7601 - 7623 NW 23RD, BETHANY, OK 73008

Additional Photos

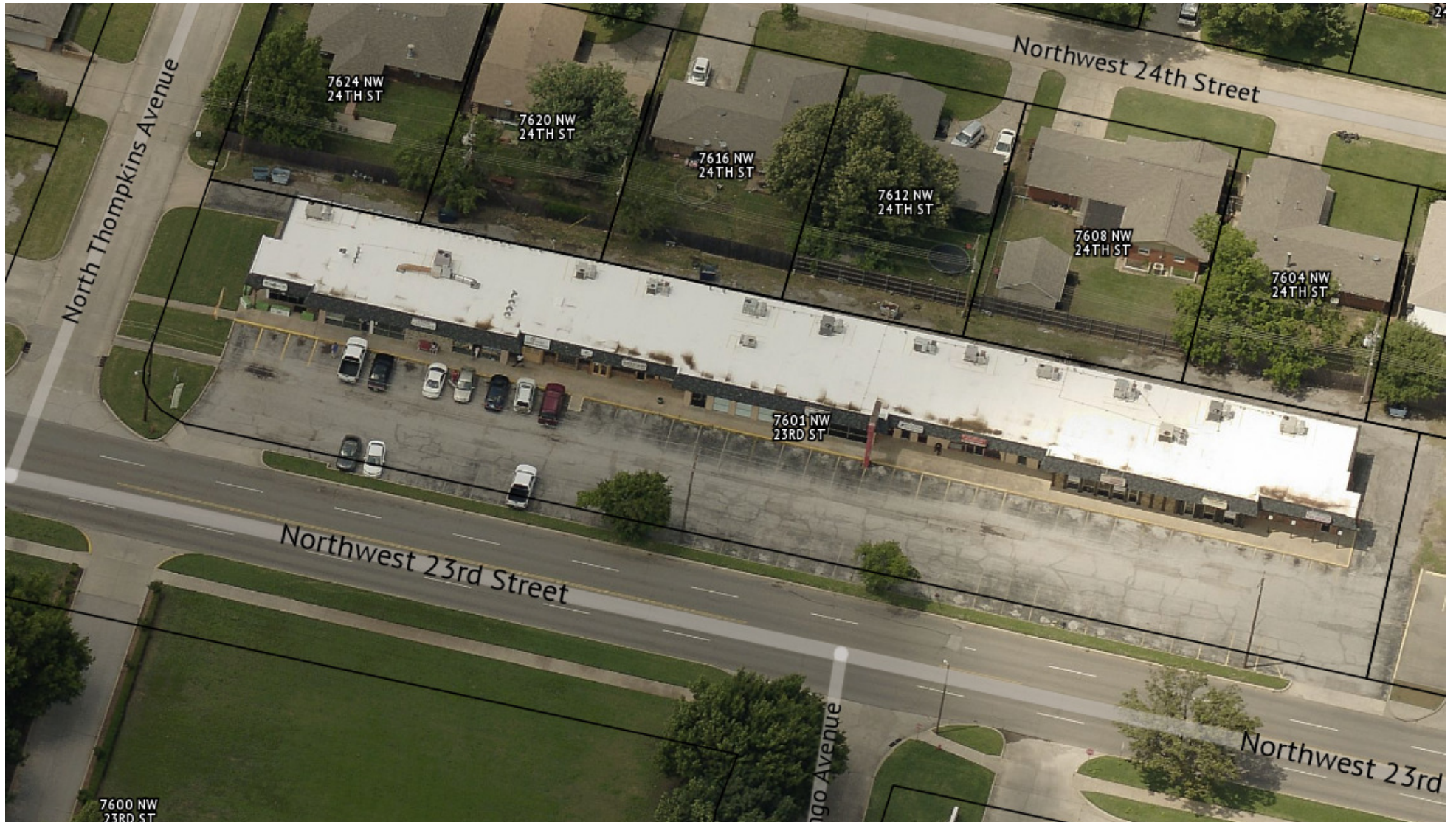

PAUL SWALES

BROKER
405.477.1894
PAUL@OKLAHOMACREBROKER.COM

1508 WEST EDMOND ROAD • • • SALTCOMMERCIAL.REALESTATE

Salt
COMMERCIAL
REAL ESTATE

Retail Property For Lease

7601 - 7623 NW 23RD, BETHANY, OK 73008

Demographics Map & Report

POPULATION	1 MILE	3 MILES	5 MILES
Total Population	12,973	66,720	178,687
Average Age	39	37	38
Average Age (Male)	38	36	37
Average Age (Female)	41	38	39

HOUSEHOLDS & INCOME	1 MILE	3 MILES	5 MILES
Total Households	5,110	25,782	71,243
# of Persons per HH	2.5	2.6	2.5
Average HH Income	\$73,263	\$65,487	\$77,585
Average House Value	\$205,733	\$190,260	\$221,426

Demographics data derived from AlphaMap

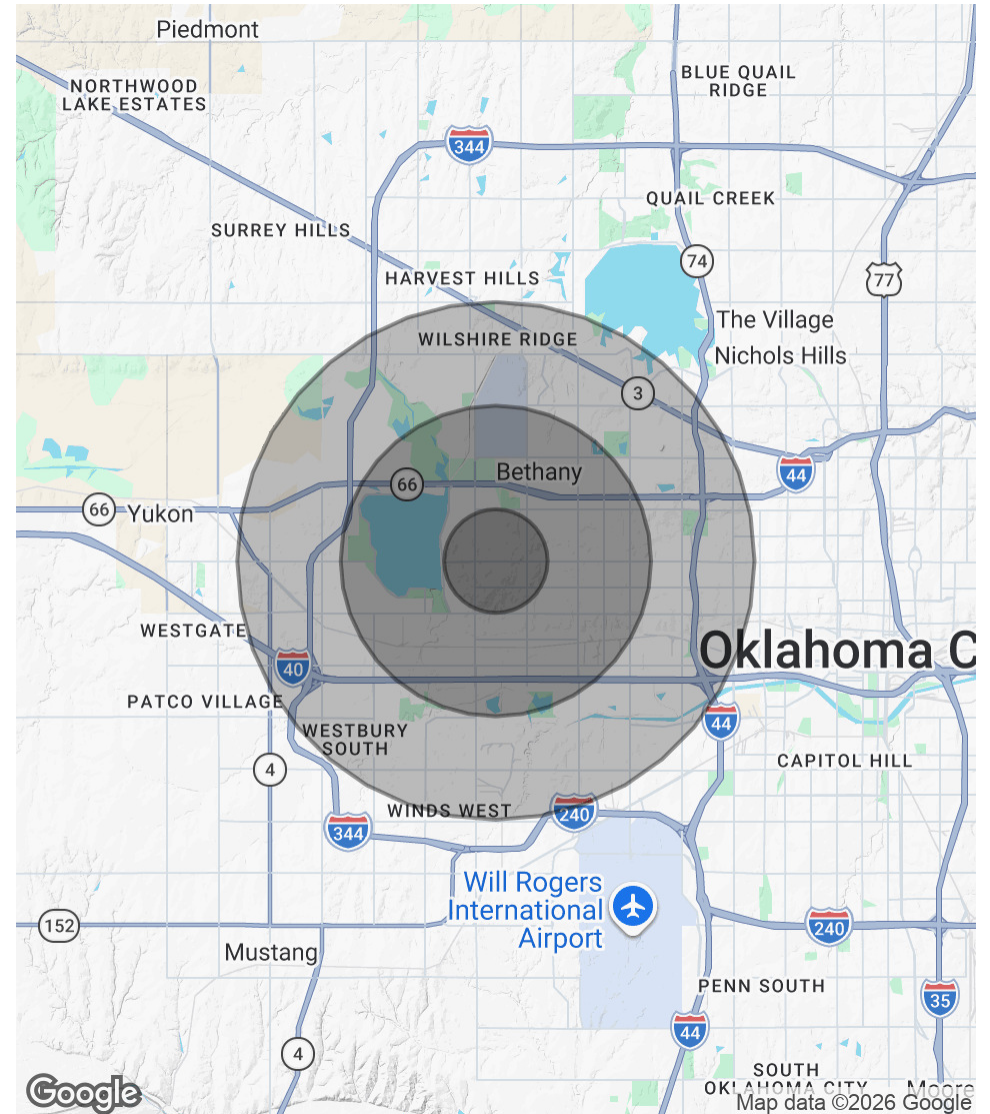

PAUL SWALES

BROKER
405.477.1894
PAUL@OKLAHOMACREBROKER.COM

Salt
COMMERCIAL
REAL ESTATE