

3875 FABER PLACE DRIVE
NORTH CHARLESTON, SC 29405

±4,000 - 19,669 SF
AVAILABLE





± 4,000 - 19,669 SF

Property Highlights

3875 Faber Place Drive presents a versatile leasing opportunity within a well-maintained office building. The entire first floor is available and can be leased in its entirety or subdivided to accommodate users as small as +/- 4,000 SF. This economical office space features an efficient layout for both general office and select medical office users.

- Quick access to I-526
- Excellent visibility
- Prominent building signage
- Abundant free surface parking
- Nature trails and running paths

AVAILABILITIES:

- First Floor: ±4,000-19,669 SF

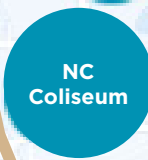
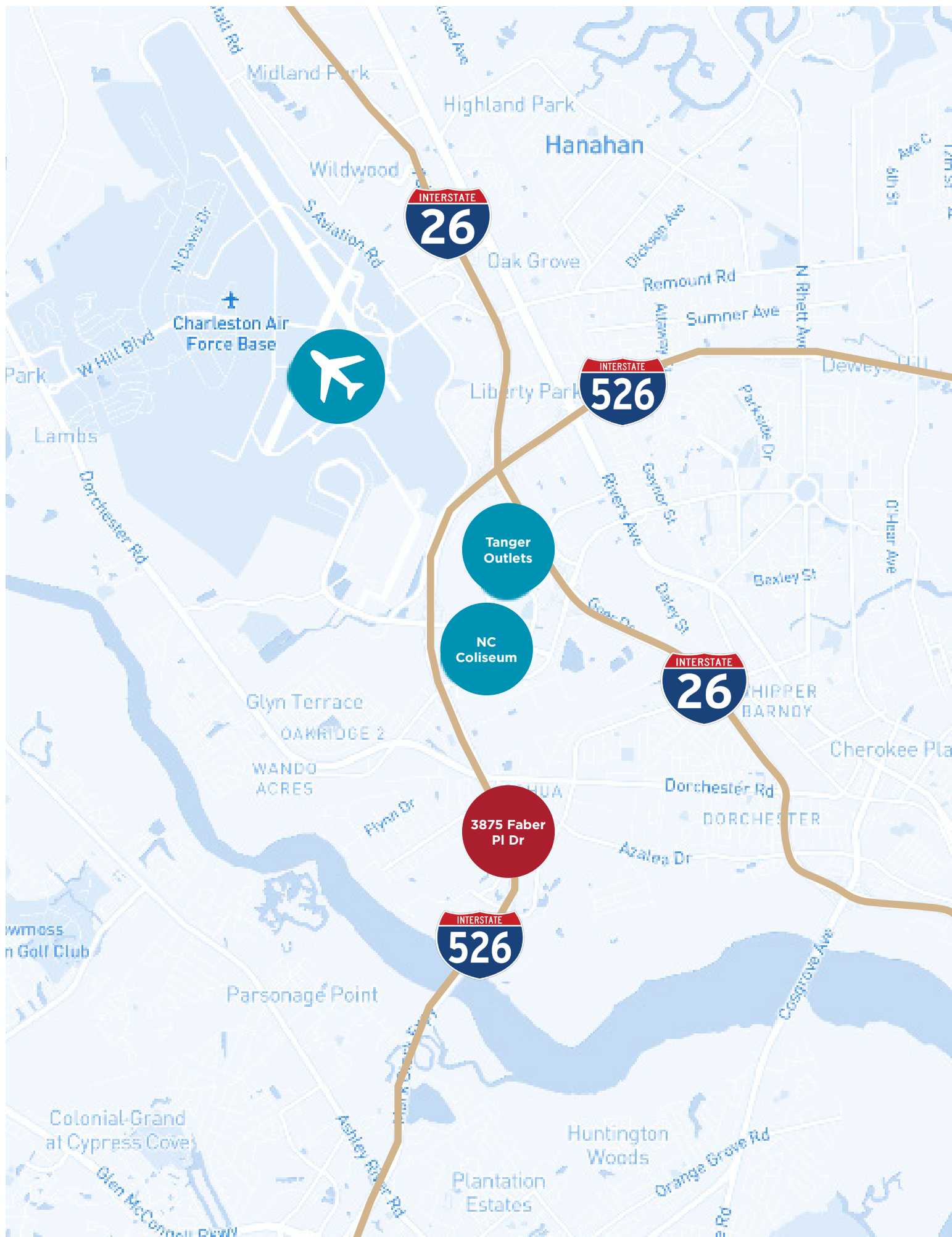

4,000SF - 19,669SF AVAILABLE

1st Floor

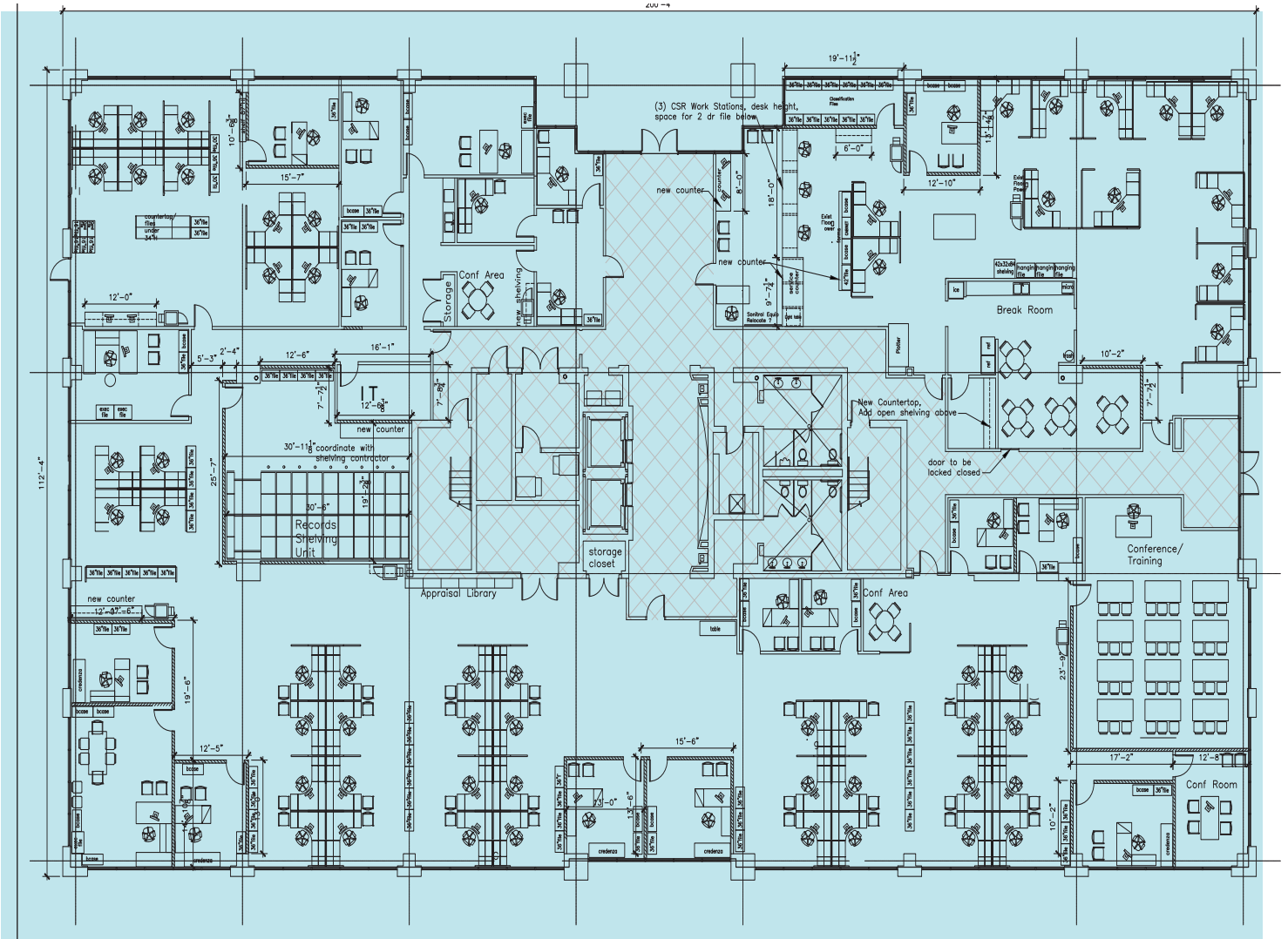





CONTACT INFORMATION

NICK TANANA

Senior Director

+1 843 724 0109

nick.tanana@cushwake.com

BRADY DASHIELL

Senior Associate

+1 843 724 0106

brady.dashiell@cushwake.com



©2024 Cushman & Wakefield. All rights reserved. The information contained in this communication is strictly confidential. This information has been obtained from sources believed to be reliable but has not been verified. NO WARRANTY OR REPRESENTATION, EXPRESS OR IMPLIED, IS MADE AS TO THE CONDITION OF THE PROPERTY (OR PROPERTIES) REFERENCED HEREIN OR AS TO THE ACCURACY OR COMPLETENESS OF THE INFORMATION CONTAINED HEREIN, AND SAME IS SUBMITTED SUBJECT TO ERRORS, OMISSIONS, CHANGE OF PRICE, RENTAL OR OTHER CONDITIONS, WITHDRAWAL WITHOUT NOTICE, AND TO ANY SPECIAL LISTING CONDITIONS IMPOSED BY THE PROPERTY OWNER(S). ANY PROJECTIONS, OPINIONS OR ESTIMATES ARE SUBJECT TO UNCERTAINTY AND DO NOT SIGNIFY CURRENT OR FUTURE PROPERTY PERFORMANCE.