

FOR LEASE



# Waterfront Plaza

325 WEST MAIN STREET | LOUISVILLE, KENTUCKY

**CBRE**

[www.cbre.com/louisville](http://www.cbre.com/louisville)



# Waterfront Plaza

## PROPERTY FEATURES



Galt House  
amenities  
available to  
tenants

Immediate  
access to &  
from I-64

On-site  
parking, best in  
the city

Multiple  
restaurants  
attached

Bank,  
restaurant,  
convenience  
store and UPS  
Store in the  
building

Fitness  
center

Great  
views

Connected to  
Louie Link  
pedway system

New  
Destination  
Dispatch  
Elevators



# AVAILABLE SPACE

## WEST TOWER

25	AVAILABLE   13,473± SF
24	AVAILABLE   13,473± SF
23	AVAILABLE   6,334± SF
22	AVAILABLE   6,821± SF
21	AVAILABLE   7,075± SF
20	AVAILABLE   13,473± SF
19	AVAILABLE   13,473± SF
18	3,095± SF   1,120± SF   1,162± SF
17	AVAILABLE   13,473± SF
16	
15	
14	AVAILABLE   13,473± SF
13	
12	AVAILABLE   13,473± SF
11	
10	
09	4,308± SF
08	AVAILABLE   13,473± SF
07	
06	AVAILABLE   13,473± SF
05	AVAILABLE   13,473± SF
04	
03	8,640± SF   4,161± SF
02	4,135± SF   1,254± SF
01	

## EAST TOWER

25	AVAILABLE   13,473± SF
24	AVAILABLE   13,473± SF
23	AVAILABLE   13,473± SF
22	AVAILABLE   13,473± SF
21	4,565± SF
20	AVAILABLE   13,473± SF
19	AVAILABLE   13,473± SF
18	AVAILABLE   13,473± SF
17	AVAILABLE   13,473± SF
16	AVAILABLE   13,473± SF
15	AVAILABLE   13,473± SF
14	AVAILABLE   13,473± SF
13	
12	AVAILABLE   13,473± SF
11	AVAILABLE   13,473± SF
10	AVAILABLE   13,473± SF
09	AVAILABLE   13,473± SF
08	AVAILABLE   13,473± SF
07	AVAILABLE   13,473± SF
06	AVAILABLE   13,473± SF
05	AVAILABLE   13,473± SF
04	
03	
02	
01	

## CENTRAL TOWER

25	
24	AVAILABLE   7,826± SF
23	
22	
21	
20	AVAILABLE   7,826± SF
19	
18	
17	2,076± SF   4,456± SF
16	
15	
14	AVAILABLE   7,826± SF
13	AVAILABLE   7,826± SF
12	AVAILABLE   7,826± SF
11	AVAILABLE   7,826± SF
10	AVAILABLE   7,826± SF
09	3,950± SF   3,534± SF
08	AVAILABLE   7,826± SF
07	
06	
05	
04	
03	
02	
01	

AVAILABLE

LEASED

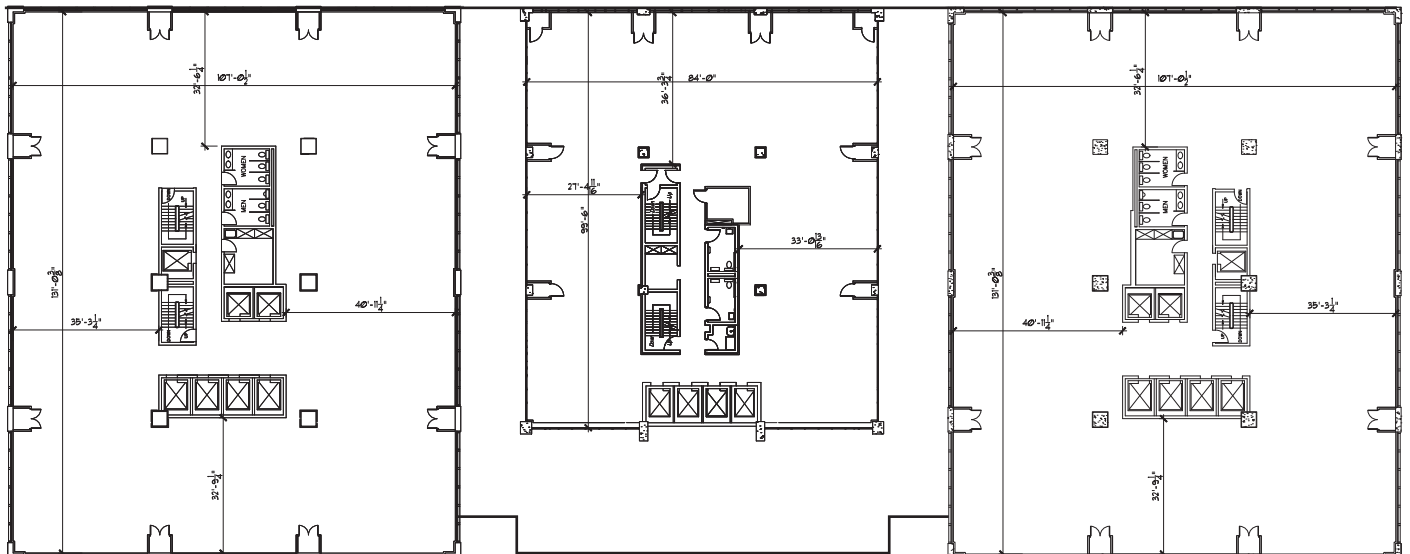





# Waterfront Plaza

325 WEST MAIN STREET | LOUISVILLE, KENTUCKY

CONTACT US FOR MORE INFORMATION

DAVID L. HARDY  
Managing Director  
+1 502 412 7644  
david.hardy@cbre.com

MICHAEL SOMERVELL  
First Vice President  
+1 502 412 7659  
michael.somervell@cbre.com

© 2024 CBRE, Inc. All rights reserved. This information has been obtained from sources believed reliable, but has not been verified for accuracy or completeness. You should conduct a careful, independent investigation of the property and verify all information. Any reliance on this information is solely at your own risk. CBRE and the CBRE logo are service marks of CBRE, Inc. All other marks displayed on this document are the property of their respective owners, and the use of such logos does not imply any affiliation with or endorsement of CBRE. Photos herein are the property of their respective owners. Use of these images without the express written consent of the owner is prohibited. PMStudio\_June

**CBRE**

[www.cbre.com/louisville](http://www.cbre.com/louisville)