

**5,200^{TO}
18,300**

**SQUARE FEET
INDUSTRIAL /
FLEX
FOR LEASE**

**FULL BUILDING
AVAILABLE**

**IDEAL LOCATION
JUST OFF I-95
MINUTES TO
PA TURNPIKE**



AVAILABLE FOR LEASE
200 RITTENHOUSE CIRCLE

NORTH BUILDING | Bristol, PA

OWNED BY

**Camber
Real Estate
Partners**

**MP MARCUS
PARTNERS**

Jeff Licht, SIOR
+1 215 396 2900 ext 101
jeff.licht@naimertz.com

Jared Licht
+1 215 395 2900 ext 105
jared.licht@naimertz.com

Scott Mertz, SIOR
+1 856 802 6529
scott.mertz@naimertz.com

NAI Mertz
210 E. Street Road, Suite 3B | Feasterville-Trevose, PA 19053
+1 215 396 2900 | naimertz.com

NAIMertz
COMMERCIAL REAL ESTATE SERVICES, WORLDWIDE

AVAILABLE FOR LEASE

200 RITTENHOUSE CIRCLE

NORTH BUILDING | Bristol, PA

BUILDING DESCRIPTION

- 18,300± SF industrial / flex building
- Dimensions: 230' x 80'
- (5) 10' x 10' drive-in doors
- (1) tailgate door
- 13'3"-14'6" clear ceiling height; 15'3"-16'6" to deck
- Column spacing: 43' x 34' and 50' x 40'
- LED lighting
- Warehouse restrooms:
 - Men's: 1 stall, 2 urinals, 3 sinks
 - Women's: 3 stalls, 2 sinks
- 2,522 SF office area (40' x 50')
- 3 private offices
- Kitchenette
- Office restrooms:
 - Men's: 1 toilet, 1 urinal, 1 sink
 - Women's: 1 toilet, 1 sink
- Located in Keystone Industrial Park
- Easy access to I-95
- Minutes to PA Turnpike

DIVISIBLE INTO 3 UNITS

5,243 SF | 5,746 SF | 6,873 SF



IMMEDIATE I-95 ACCESS

AVAILABLE FOR LEASE
200 RITTENHOUSE CIRCLE

NORTH BUILDING | Bristol, PA

**LESS THAN 1 MI
FROM EXIT 39
ENTRANCE RAMPS**



FLOORPLAN SINGLE TENANT

AVAILABLE FOR LEASE
200 RITTENHOUSE CIRCLE
NORTH BUILDING | Bristol, PA

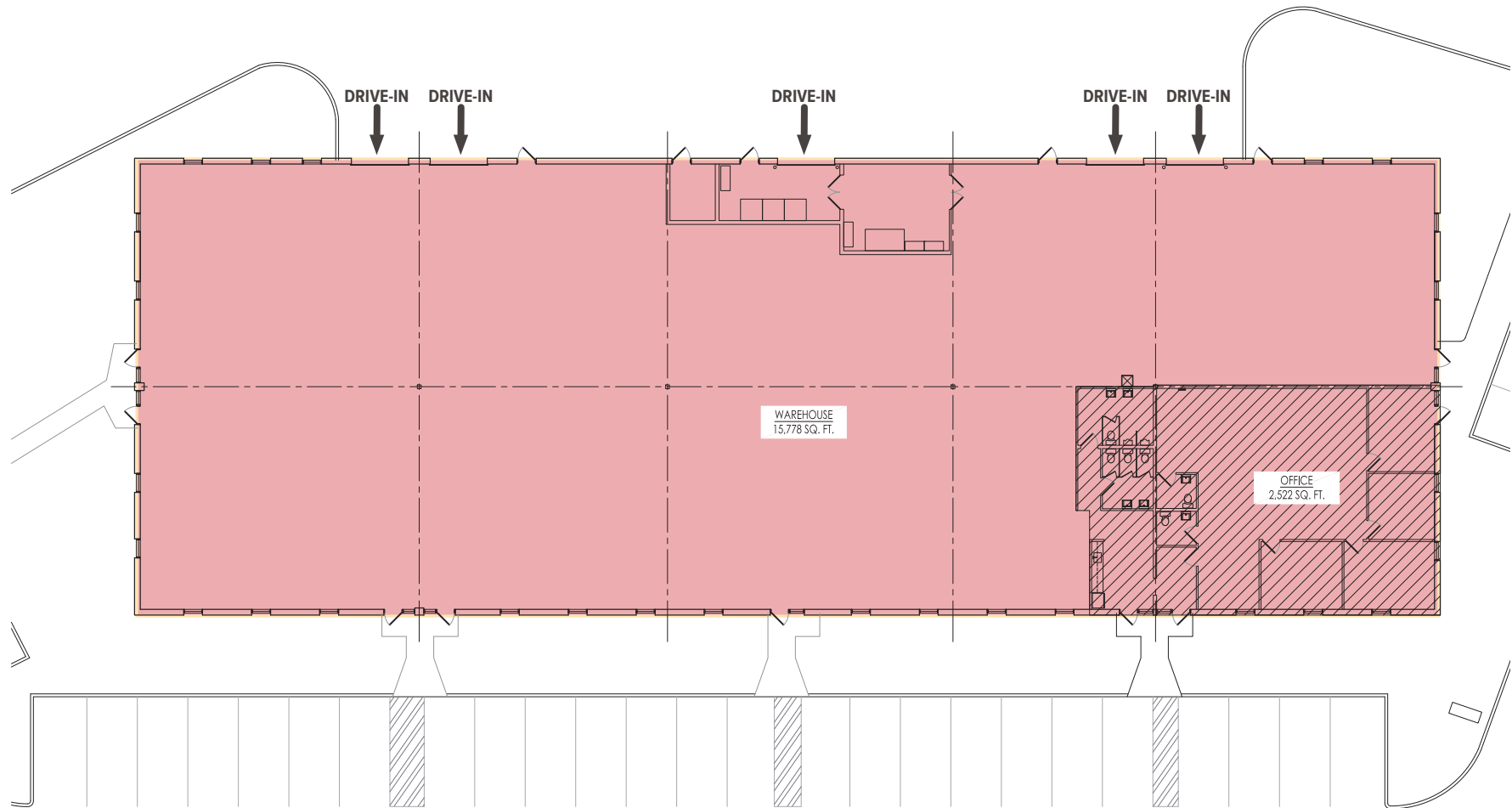

FLOORPLAN DIVISIBLE INTO 3 UNITS

AVAILABLE FOR LEASE
200 RITTENHOUSE CIRCLE

NORTH BUILDING | Bristol, PA

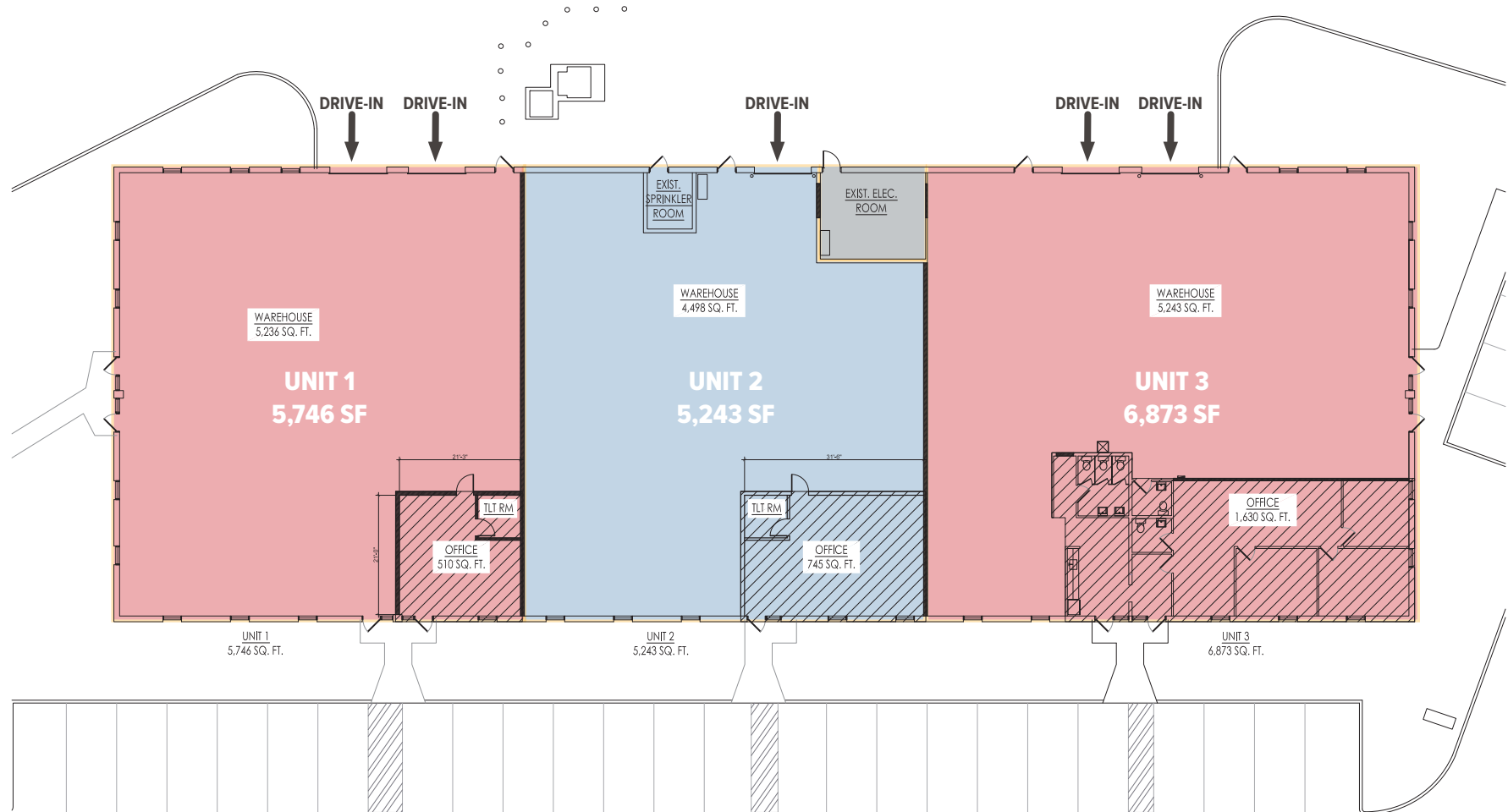

▲ PROPOSED TENANT SEPARATION

AERIAL

AVAILABLE FOR LEASE
200 RITTENHOUSE CIRCLE
NORTH BUILDING | Bristol, PA



LOCATION INFORMATION

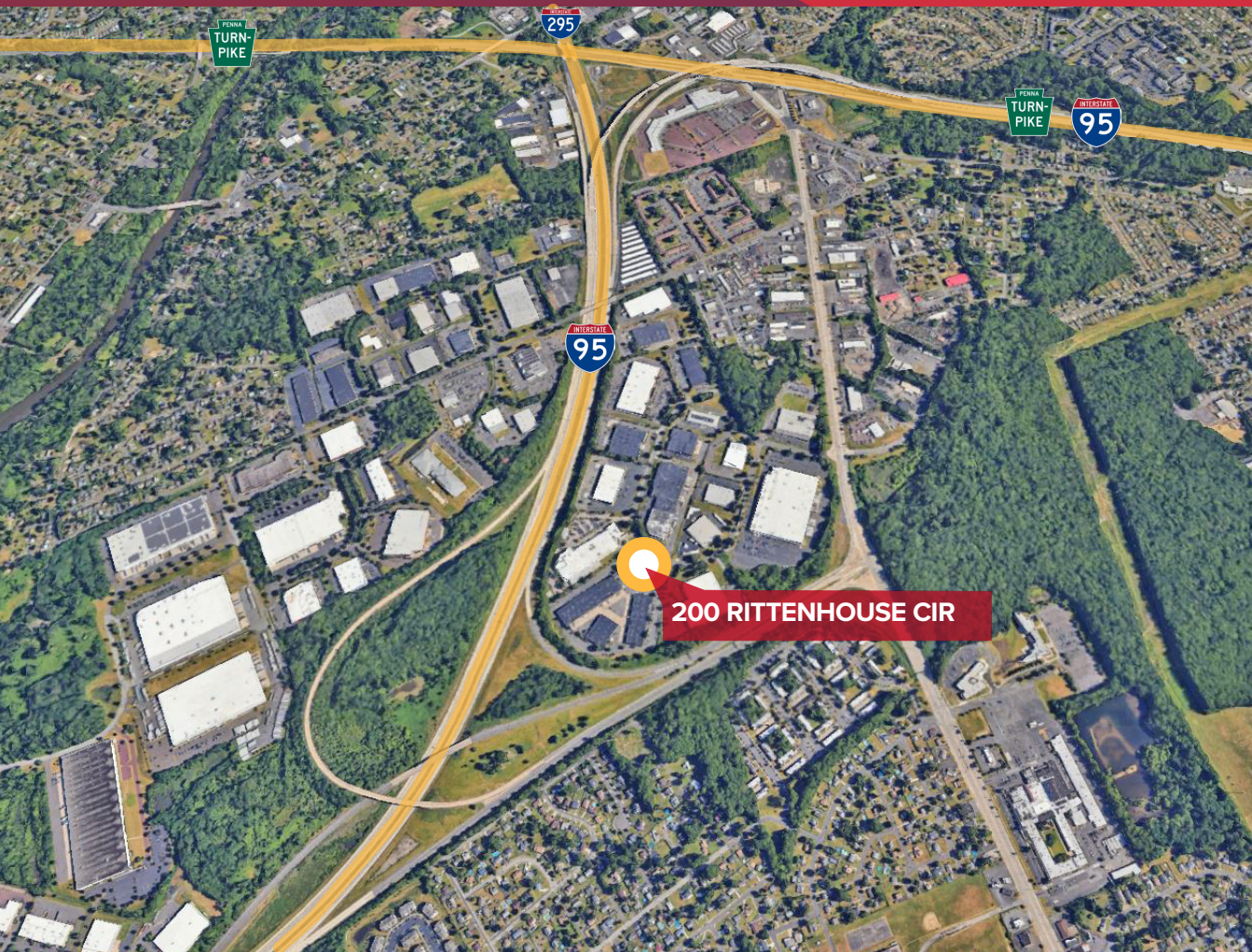

AVAILABLE FOR LEASE 200 RITTENHOUSE CIRCLE

NORTH BUILDING | Bristol, PA

Distance to

I-95	0.7 mi
Route 13	1.8 mi
PA Turnpike (East)	2.6 mi
PA Turnpike (West)	4.4 mi
NJ Turnpike	5.2 mi
Center City Philadelphia	20 mi

OWNED BY

**Camber
Real Estate
Partners**

**MP MARCUS
PARTNERS**

Jeff Licht, SIOR

+1 215 396 2900 ext 101
jeff.licht@naimertz.com

Jared Licht

+1 215 395 2900 ext 105
jared.licht@naimertz.com

Scott Mertz, SIOR

+1 856 802 6529
scott.mertz@naimertz.com

NAI Mertz

210 E. Street Road, Suite 3B | Feasterville-Trevose, PA 19053
+1 215 396 2900 | naimertz.com

NO WARRANTY OR REPRESENTATION, EXPRESS OR IMPLIED, IS MADE AS TO THE ACCURACY OF THE INFORMATION CONTAINED HEREIN, AND THE SAME IS SUBMITTED SUBJECT TO ERRORS, OMISSIONS, CHANGE OF PRICE, RENTAL OR OTHER CONDITIONS, PRIOR SALE, LEASE OR FINANCING, OR WITHDRAWAL WITHOUT NOTICE, AND OF ANY SPECIAL LISTING CONDITIONS IMPOSED BY OUR PRINCIPALS NO WARRANTIES OR REPRESENTATIONS ARE MADE AS TO THE CONDITION OF THE PROPERTY OR ANY HAZARDS CONTAINED THEREIN ARE ANY TO BE IMPLIED.

NAIMertz

COMMERCIAL REAL ESTATE SERVICES, WORLDWIDE