

Suite A, B and shared
restroom corridor

9164 sf

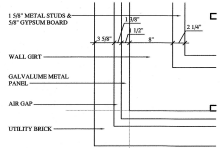

2 ENLARGED FLOOR PLAN @ BUILDING CORNER
A-1 1/8" = 1'-0"

1 FLOOR PLAN
A-1 1/8" = 1'-0"

NOTE TO GENERAL CONTRACTOR:

1. NOTIFY ARCHITECT IMMEDIATELY OF ANY DISCREPANCIES IN DIMENSIONS IN WALL LAYOUT AS NEEDED FOR PROPER CONSTRUCTION.
2. ALL INTERIOR WALLS SHALL HAVE ADEQUATE STRENGTH TO RESIST THE LOADS TO WHICH THEY ARE SUBJECTED BUT NOT LESS THAN A HORIZONTAL LOAD OF 5 PSF PER 1607.13 2012 NCSCB.

WALL LEGEND

A1 = 3" METAL STUDS @ 16" O.C. TO 12'-0"
 A1F INSTALL RIGID INSULATION AND 5/8" GYPSUM BOARD BOTH SIDES OF STUD - FULL HEIGHT.

A2 = 5" METAL STUDS @ 16" O.C. TO ROOF DECK ABOVE. INSTALL R-19 BATT INSULATION AND 5/8" GYPSUM BOARD BOTH SIDES OF WALL - FULL HEIGHT.

A3 = 5" METAL STUDS @ 15" O.C. TO 12'-0". INSTALL R-19 BATT INSULATION AND 5/8" GYPSUM BOARD BOTH SIDES OF WALL - FULL HEIGHT.

A4 = 1" METAL STUDS @ 16" O.C. TO 12'-0"
 A4F INSTALL 5/8" GYPSUM BOARD FINISH SIDE OF STUD - FULL HEIGHT.

NOTE: ALL WALLS ARE TYPE A1 UNLESS OTHERWISE NOTED.

GENERAL NOTES:

1. EXTERIOR DIMENSIONS ARE OUT TO OUT OF MASONRY. INTERIOR DIMENSIONS ARE CENTERLINE TO CENTERLINE.
2. FIELD VERIFY ALL DIMENSIONS.



REVISIONS

NO.	DATE	DESCRIPTION

Project No. 1813
 Scale:
 Date Drawn: 7/23/18
 Sheet Title: FLOOR PLAN