



OFFICE/ REDEVELOPMENT OPPORTUNITY

221 W. Cherry Street
Nevada, Missouri





HIGHLIGHTS

- Former office service center with 76,500 SF of office space in downtown Nevada, MO
- Three story brick office building with a full basement
- Property sale includes the existing cubicles, private office furniture as well as conference rooms and other support areas furnishings
- 1.23 acre site with 53 parking stalls
- Property can be accessed from three streets with the main access point on Cherry Street
- The site has easy access from U.S. Route 54 and Interstate 49
- Property was originally built for Farm & Home Savings and Loan
- C-2 Zoning - General Business District
- Great opportunity for a growing company to locate within Vernon County which offers a pro-business climate
- Vernon County is home to the nationally ranked Cottey College, Crowder College, Midwest Welding Institute and the Nevada Regional Technical Center. These institutions provide a wide range of degree options which provides a solid pipeline of talent.
- Sale Price: \$1,600,000

221 W CHERRY STREET



BUILDING RECEPTION



SMALL KITCHEN



BASEMENT BREAK ROOM



BUILDING DOCK DOOR



1ST FLOOR PLAN

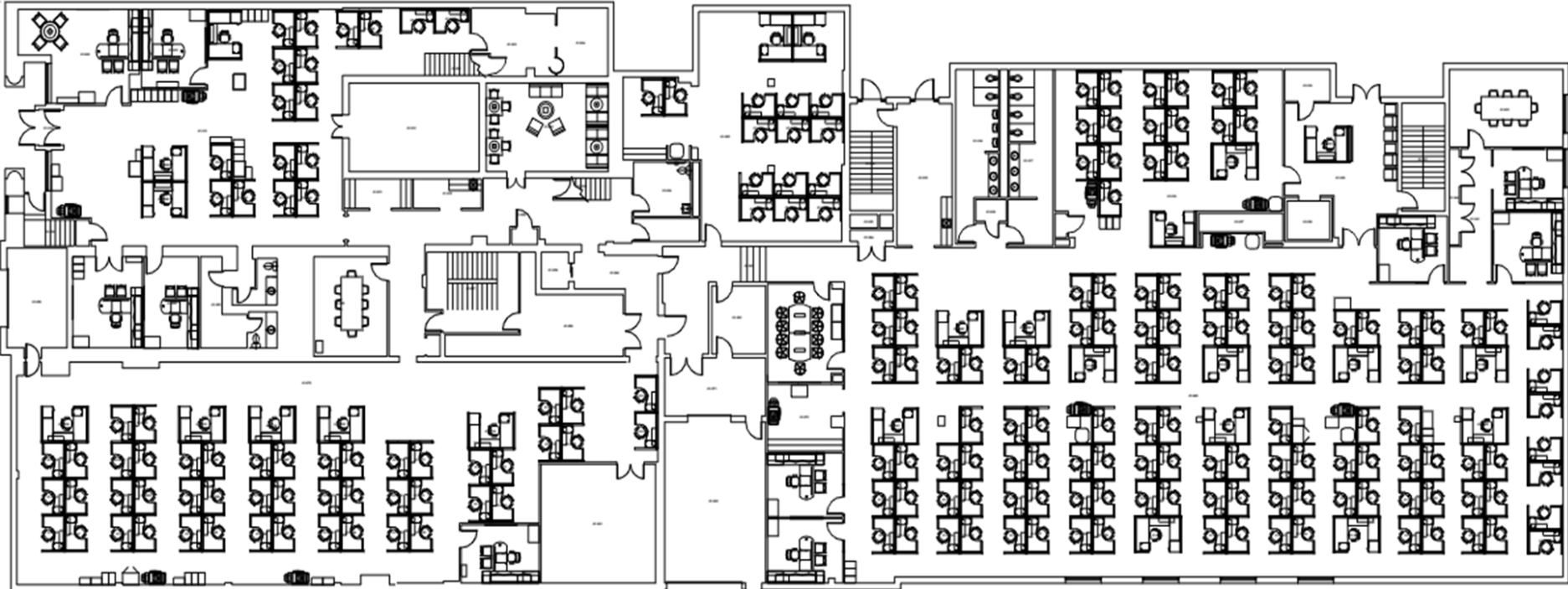

1ST FLOOR PHOTOS



2ND FLOOR PLAN



2ND FLOOR PHOTOS



LOCATION AERIAL

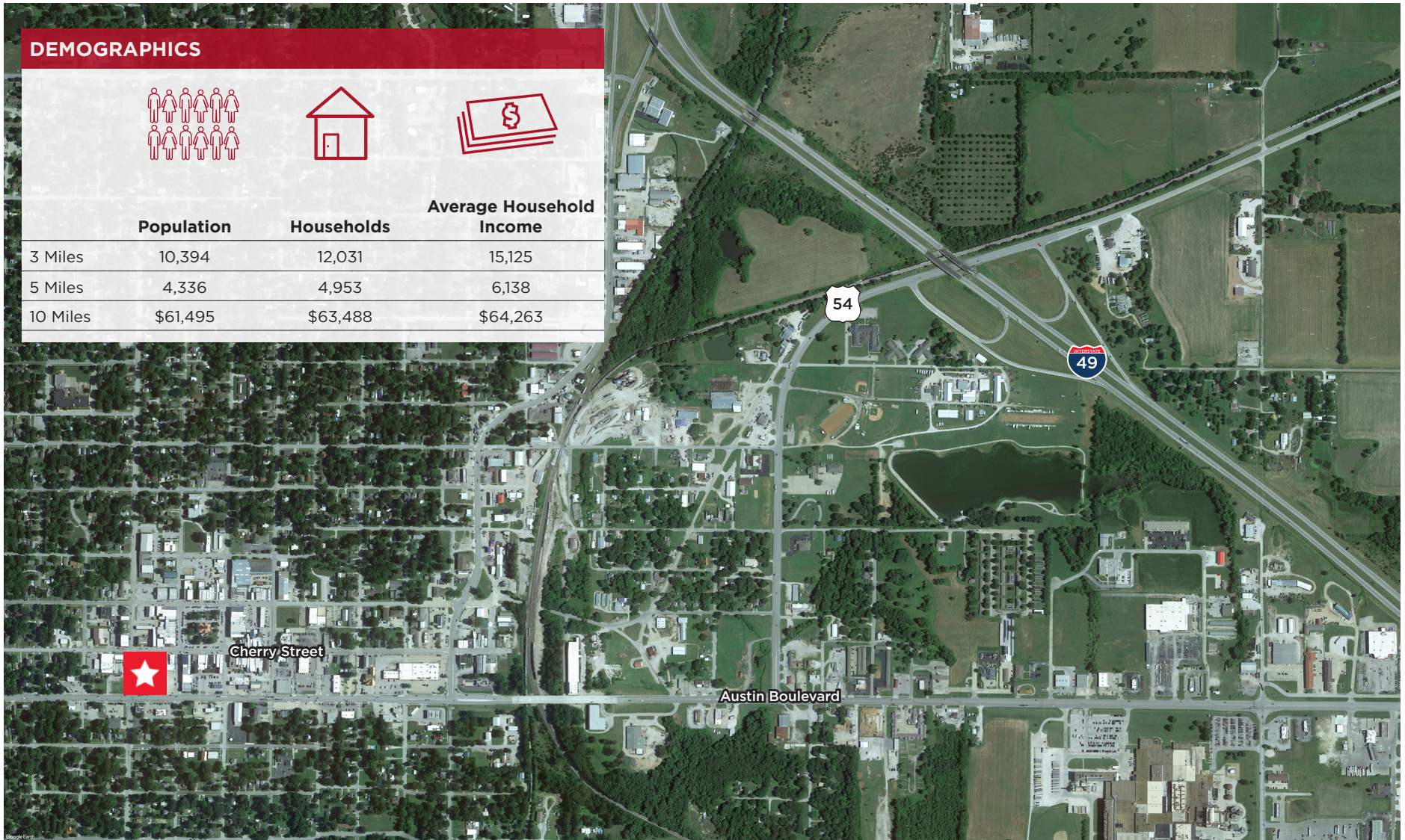



Marty Gilchrist, CCIM

Senior Associate

marty.gilchrist@cushwake.com

Direct +1 816 216 5655

4600 Madison Avenue, Suite 800

Kansas City, MO 64112

Main +1 816 221 2200

Fax +1 913 273 1398

cushmanwakefield.com