



PROPERTY OVERVIEW

The Boulos Company is pleased to present the availability of 5 Executive Drive, located in Hudson, New Hampshire with 23,200± SF of industrial space available for lease. The office area is fully heated and air-conditioned. The warehouse is fully heated. There is a restroom in the office and warehouse area. The building is fully sprinklered.

The building is situated in Sagamore Industrial Park, a designated Economic Revitalization Zone, offering incentives and business tax credits to qualifying companies. The property is conveniently located within 1.8 miles of Exit 2 off the Everett Turnpike, offering quick and easy access to the Massachusetts border. The Manchester-Boston Regional Airport is within a 20-minute ride. Retail neighbors include Market Basket, Walmart, Sam's Club, DCU, Starbucks, Dunkin' Donuts, Burger King, McDonald's, Jersey Mike's and others.

HIGHLIGHTS

- 23,200± SF available
- 18'-20' clear height
- Suitable for R&D/light manufacturing
- 1600 amps, 3-phase power
- (3) loading docks and 2 drive-in doors (14'x14')
- Ample parking
- Quick & easy highway access
- Minutes to the Massachusetts border
- Retail and restaurants nearby
- Lease rate: \$11.00-\$12.00/SF NNN

FOR LEASE | INDUSTRIAL SPACE

5 EXECUTIVE DRIVE | HUDSON, NH 03051



PROPERTY SPECIFICATIONS

• BUILDING TYPE	Industrial	• UTILITIES	Municipal water/sewer
• BUILDING SIZE	35,200± SF	• POWER	1,600 amps/3-phase
• AVAILABLE SF	23,200± SF	• HVAC	Natural gas; heat and A/C in office area. Warehouse is fully heated.
• LOT SIZE	5.03± acres	• LOADING	(3) loading docks, (2) drive-in doors 14'x14
• YEAR BUILT	1976	• COLUMN SPACING	40' from center
• ZONING	Industrial	• LEASE RATE	\$11.00-12.00/SF NNN
• PARKING	Ample		



FOR LEASE | INDUSTRIAL SPACE

5 EXECUTIVE DRIVE | HUDSON, NH 03051



FLOOR PLAN

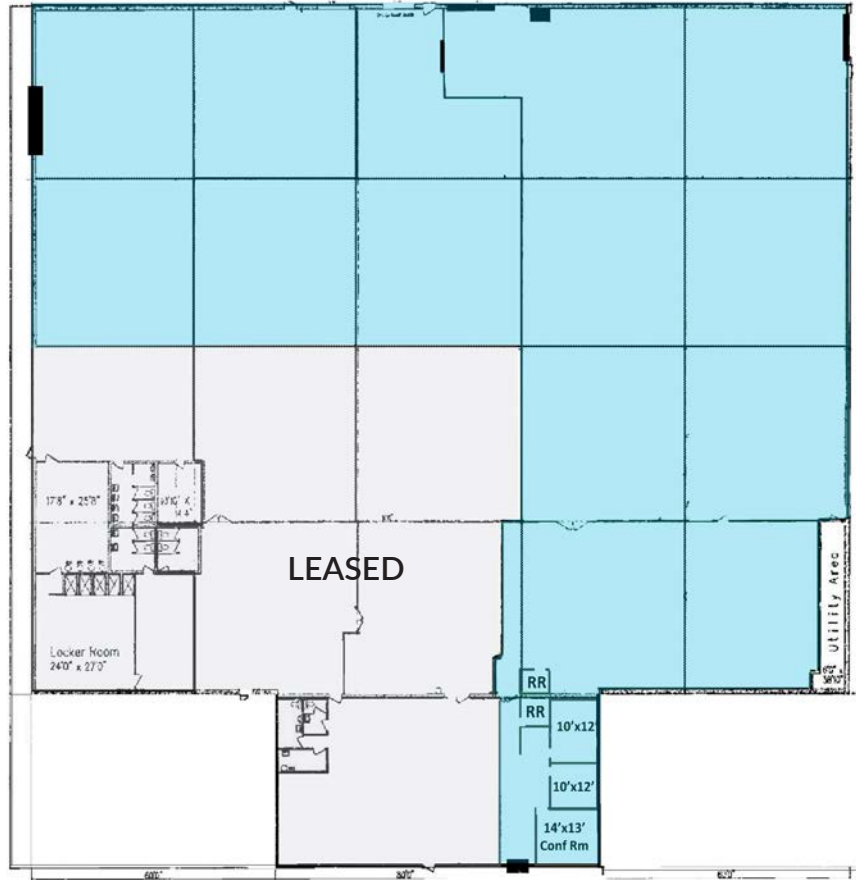

AVAILABLE SPACE

23,200± SF

LOCAL ECONOMIC OVERVIEW

Hudson, New Hampshire, is home to approximately 25,620 residents and serves as a popular bedroom community for the Greater Boston area. A member of Hillsborough County, Hudson is bordered by the New Hampshire communities of Nashua, Merrimack, Litchfield, Londonderry, Windham, Pelham and Tyngsborough, Massachusetts. The town sits on the Massachusetts-New Hampshire line. It is conveniently located directly across the Merrimack River from the bustling city of Nashua with Manchester just 20 miles away—making the town highly accessible to three of New England's largest employment hubs and an attractive relocation destination.

Two major airports service the Hudson area: Boston-Manchester Regional Airport in Manchester, New Hampshire, and Logan International Airport in Boston, Massachusetts. Boston-Manchester Regional Airport is only 25 minutes away from Hudson and serves a variety of national destinations, and daily shuttle buses between Nashua and Logan Airport run consistently.

FOR LEASE | INDUSTRIAL SPACE

5 EXECUTIVE DRIVE | HUDSON, NH 03051



CONTACT US



ROGER DIEKER
MANAGING BROKER | PARTNER
+1 603 540 8315 C
+1 603 333 1333 T
RDIEKER@BOULOS.COM



MIKE TAMPOSI
PARTNER
+1 603 315 4348 C
+1 603 333 1333 T
MTAMPOSI@BOULOS.COM



NICK DENISCO
ASSOCIATE
+1 978 239 8128 C
+1 603 333 1333 T
NDENISCO@BOULOS.COM

©2025 Boulos Holdings, LLC d/b/a The Boulos Company. All rights reserved. This information has been obtained from sources believed reliable, but has not been verified for accuracy or completeness. You should conduct a careful, independent investigation of the property and verify all information. Any reliance on this information is solely at your own risk. The Boulos Company and The Boulos Company logo are service marks of The Boulos Company, Inc. and Boulos Holdings, LLC. All other marks displayed on this document are the property of their respective owners. Photos herein are the property of their respective owners. Use of these images without the express written consent of the owner is prohibited.



650 Elm Street, Suite 102, Manchester, NH 03101



603.333.1333



www.boulos.com



State of New Hampshire
OFFICE OF PROFESSIONAL LICENSURE AND CERTIFICATION
DIVISION OF LICENSING AND BOARD ADMINISTRATION
7 Eagle Square, Concord, NH 03301-4980
Phone: 603-271-2152

BROKERAGE RELATIONSHIP DISCLOSURE FORM
(This is Not a Contract)

This form shall be presented to the consumer at the time of first business meeting, prior to any discussion of confidential information

**Right Now,
You Are a
Customer**

As a customer, the licensee with whom you are working is not obligated to keep confidential the information that you might share with him or her. As a customer, you should not reveal any confidential information that could harm your bargaining position.

As a customer, you can expect a real estate licensee to provide the following customer-level services:

- To disclose all material defects known by the licensee pertaining to the on-site physical condition of the real estate;
- To treat both the buyer/tenant and seller/landlord honestly;
- To provide reasonable care and skill;
- To account for all monies received from or on behalf of the buyer/tenant or seller/landlord relating to the transaction;
- To comply with all state and federal laws relating to real estate brokerage activity; and
- To perform ministerial acts, such as showing property, preparing, and conveying offers, and providing information and administrative assistance.

To Become a Client

Clients receive more services than customers. You become a client by entering into a written contract for representation as a seller/landlord or as a buyer/tenant.

As a client, in addition to the customer-level services, you can expect the following client-level services

- Confidentiality;
- Loyalty;
- Disclosure;
- Lawful Obedience; and
- Promotion of the client's best interest.
- For seller/landlord clients this means the agent will put the seller/landlord's interests first and work on behalf of the seller/landlord.
- For buyer/tenant clients this means the agent will put the buyer/tenant's interest first and work on behalf of the buyer/tenant.

Client-level services also include advice, counsel, and assistance in negotiations.

For important information about your choices in real estate relationships, please see page 2 of this disclosure form.

I acknowledge receipt of this disclosure as required by the New Hampshire Real Estate Commission (Pursuant to Rea 701.01).
I understand as a customer I should not disclose confidential information.

Name of Consumer (Please Print)

Name of Consumer (Please Print)

Signature of Consumer

Date

Signature of Consumer

Date

Provided by: Name & License #

Date

(Name and License # of Real Estate Brokerage Firm)

_____ consumer has declined to sign this form
(Licensees Initials)

Types of Brokerage Relationships commonly practiced in New Hampshire

SELLER AGENCY (RSA 331-A:25-b)

A seller agent is a licensee who acts on behalf of a seller or landlord in the sale, exchange, rental, or lease of real estate. The seller is the licensee's client, and the licensee has the duty to represent the seller's best interest in the real estate transaction.

BUYER AGENCY (RSA 331-A:25-c)

A buyer agent is a licensee who acts on behalf of a buyer or tenant in the purchase, exchange, rental, or lease of real estate. The buyer is the licensee's client, and the licensee has the duty to represent the buyer's best interests in the real estate transaction.

SINGLE AGENCY (RSA 331-A:25-b; RSA 331-A:25-c)

Single agency is a practice where a firm represents the buyer only, or the seller only, but never in the same transaction. Disclosed dual agency cannot occur.

SUB-AGENCY (RSA 331-A:2, XIII)

A sub-agent is a licensee who works for one firm but is engaged by the principal broker of another firm to perform agency functions on behalf of the principal broker's client. A sub-agent does not have an agency relationship with the customer.

DISCLOSED DUAL AGENCY (RSA 331-A:25-d)

A disclosed dual agent is a licensee acting for both the seller/landlord and the buyer/tenant in the same transaction with the knowledge and written consent of all parties.

The licensee cannot advocate on behalf of one client over another. Because the full range of duties cannot be delivered to both parties, written informed consent must be given by all clients in the transaction.

A dual agent may not reveal confidential information without written consent, such as:

1. Willingness of the seller to accept less than the asking price.
2. Willingness of the buyer to pay more than what has been offered.
3. Confidential negotiating strategy not disclosed in the sales contract as terms of the sale.
4. Motivation of the seller for selling nor the motivation of the buyer for buying.

DESIGNATED AGENCY (RSA 331-A:25-e)

A designated agent is a licensee who represents one party of a real estate transaction and who owes that party client-level services, whether or not the other party to the same transaction is represented by another individual licensee associated with the same brokerage firm.

FACILITATOR (RSA 331-A:25-f)

A facilitator is an individual licensee who assists one or more parties during all or a portion of a real estate transaction without being an agent or advocate for the interests of any party to such transaction. A facilitator can perform ministerial acts, such as showing property, preparing and conveying offers, and providing information and administrative assistance, and other customer-level services listed on page 1 of this form. This relationship may change to an agency relationship by entering into a written contract for representation, prior to the preparation of an offer.

ANOTHER RELATIONSHIP (RSA 331-A:25-a)

If another relationship between the licensee who performs the service and the seller, landlord, buyer or tenant is intended, it must be described in writing and signed by all parties to the relationship prior to services being rendered.