

10939 Fischer Road

San Antonio, TX

Key Facts

Property type	Industrial space
---------------	------------------

Building size	283,818 SF
---------------	------------

Space available	98,280 SF
-----------------	-----------



Contact Us

Learn more about this property or schedule a tour by reaching out to our local investment and leasing officer.

Barney Sinclair

+1 (214) 476-6554

barney.sinclair@eqtpartners.com

Caleb Parikh

+1 (404) 824-3904

caleb.parikh@eqtpartners.com

10939 Fischer Road

San Antonio, TX

Building Specifications

Availability: 98,280 SF

8,524 SF office space

100% HVAC warehouse space

32' clear height

25 dock-high doors

1/1000 car parking ratio

Up to 20 trailer parking spaces available

ESFR sprinklers

LED lighting

Direct access to IH-35 & Loop 410

Adjacent to UP Intermodal facility



Contact Us

Learn more about this property or schedule a tour by reaching out to our local investment and leasing officer.

Barney Sinclair

+1 (214) 476-6554

barney.sinclair@eqtpartners.com

Caleb Parikh

+1 (404) 824-3904

caleb.parikh@eqtpartners.com

10939 Fischer Road

San Antonio, TX

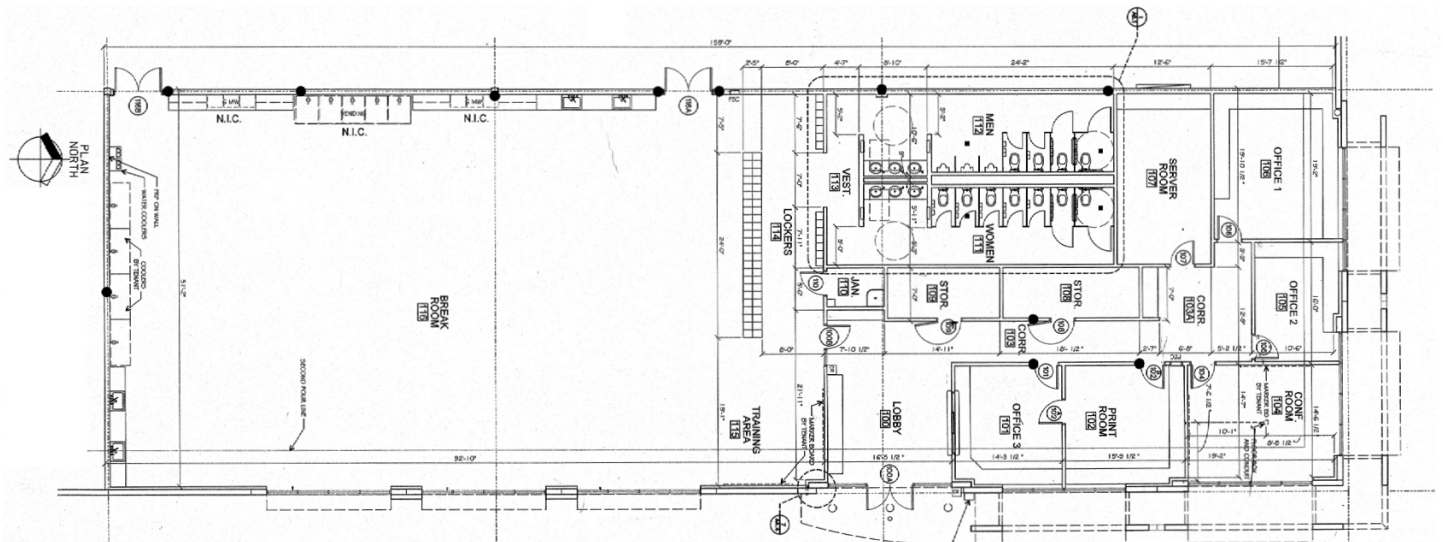

8,524 SF office space



Contact Us

Learn more about this property or schedule a tour by reaching out to our local investment and leasing officer.

Barney Sinclair

+1 (214) 476-6554

barney.sinclair@eqtpartners.com

Caleb Parikh

+1 (404) 824-3904

caleb.parikh@eqtpartners.com

10939 Fischer Road

San Antonio, TX

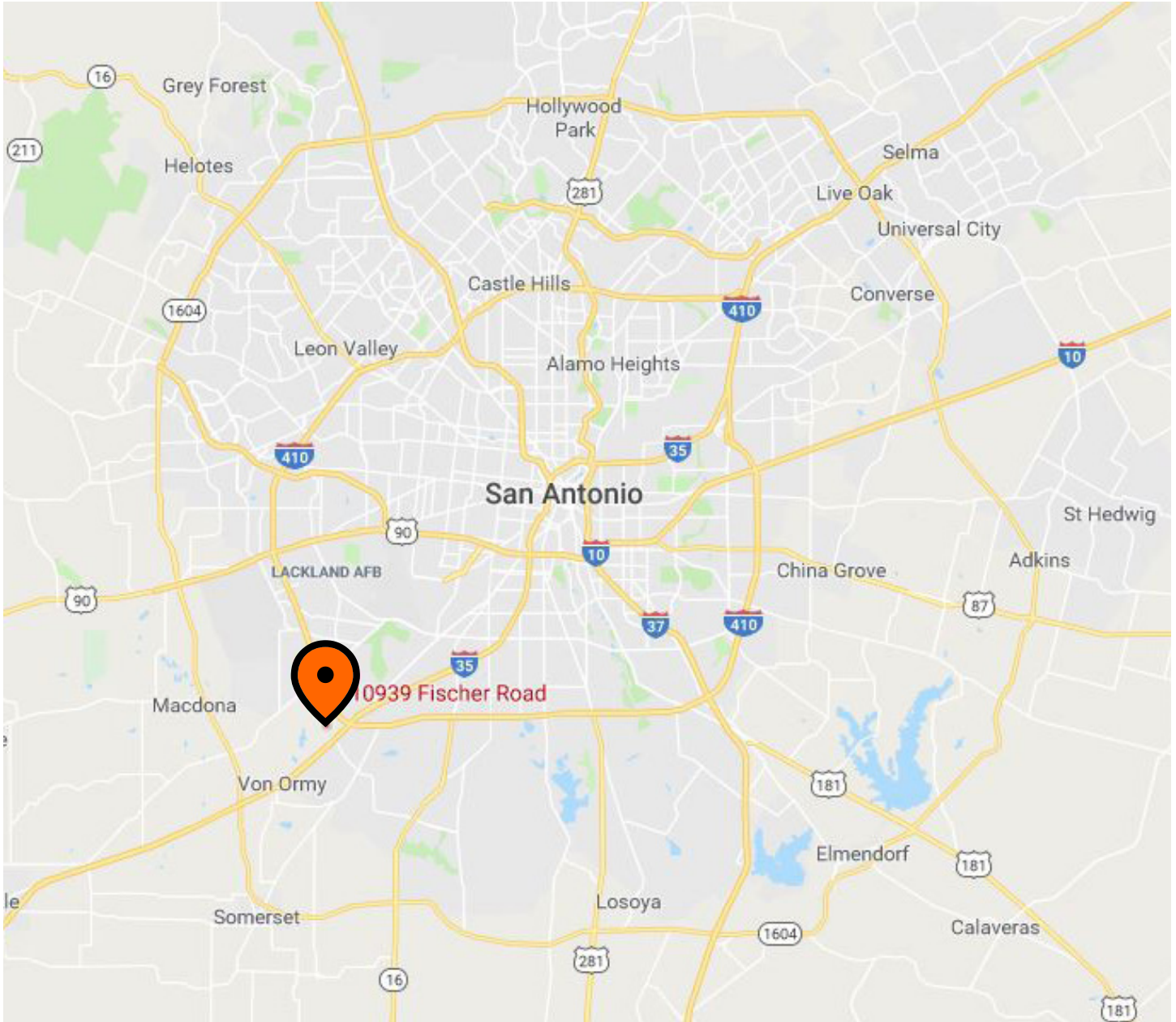

Contact Us

Learn more about this property or schedule a tour by reaching out to our local investment and leasing officer.

Barney Sinclair

+1 (214) 476-6554

barney.sinclair@eqtpartners.com

Caleb Parikh

+1 (404) 824-3904

caleb.parikh@eqtpartners.com