

FOR SALE /// ±10,242 SF

241-251 GEMINI AVENUE

DIVISIBLE INDUSTRIAL BUILDING

BREA | CA 92821



FOR MORE INFORMATION, CONTACT:

DENNIS HOLT

Executive Vice President

P: 949.242.1714

dennis.holt@daumcommercial.com

CADRE #01948978

PAUL GINGRICH

Executive Vice President

P: 714.941.5333

paul.gingrich@daumcommercial.com

CADRE #01299770

CHRIS MIGLIORI

President

P: 714.941.5320

chris.migliori@daumcommercial.com

CADRE #00972843

DAUM
COMMERCIAL REAL ESTATE SERVICES

D/AQ Corp. #01129558. Maps Courtesy ©Google & ©Microsoft. Although all information is furnished regarding for sale, rental or financing is from sources deemed reliable, such information has not been verified and no express representation is made nor is any to be implied as to the accuracy thereof, and it is submitted subject to errors, omissions, changes of price, rental or other conditions, prior sale, lease or financing, or withdrawal without notice.

FOR SALE /// ±10,242 SF

241-251 GEMINI AVENUE

DIVISIBLE INDUSTRIAL BUILDING

BREA | CA 92821

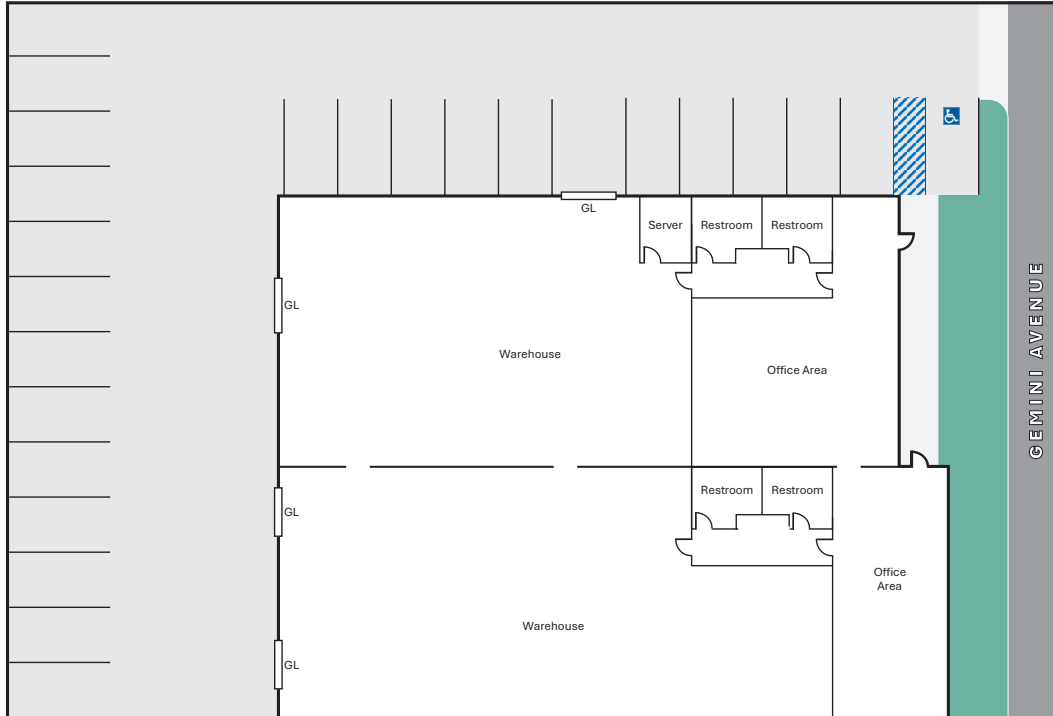

PROPERTY HIGHLIGHTS:

- ±10,242 SF Industrial Building
- Divisible into 2 Units
- Separately Metered
- Four (4) Ground Level Loading Doors
- 400 Amps of Power (Verify)
- 16'-17' Warehouse Clearance Height
- Recently Renovated
- Concrete Tilt-Up Construction
- Possible Fenced Yard (Verify)
- ±22,466 SF Parcel
- Abundant Parking: 24 Stalls Plus Street Parking
- M2 Zoning
- Convenient Access to 57 Freeway

FOR MORE INFORMATION, CONTACT:

DENNIS HOLT

Executive Vice President

P: 949.242.1714

dennis.holt@daumcommercial.com

CADRE #01948978

PAUL GINGRICH

Executive Vice President

P: 714.941.5333

paul.gingrich@daumcommercial.com

CADRE #01299770

CHRIS MIGLIORI

President

P: 714.941.5320

chris.migliori@daumcommercial.com

CADRE #00972843

DAUM
COMMERCIAL REAL ESTATE SERVICES

D/AQ Corp. #01129558. Maps Courtesy ©Google & ©Microsoft. Although all information is furnished regarding for sale, rental or financing is from sources deemed reliable, such information has not been verified and no express representation is made nor is any to be implied as to the accuracy thereof, and it is submitted subject to errors, omissions, changes of price, rental or other conditions, prior sale, lease or financing, or withdrawal without notice.

FOR SALE /// ±10,242 SF

241-251 GEMINI AVENUE

DIVISIBLE INDUSTRIAL BUILDING

BREA | CA 92821



FOR MORE INFORMATION, CONTACT:

DENNIS HOLT

Executive Vice President

P: 949.242.1714

dennis.holt@daumcommercial.com

CADRE #01948978

PAUL GINGRICH

Executive Vice President

P: 714.941.5333

paul.gingrich@daumcommercial.com

CADRE #01299770

CHRIS MIGLIORI

President

P: 714.941.5320

chris.migliori@daumcommercial.com

CADRE #00972843

DAUM
COMMERCIAL REAL ESTATE SERVICES

D/AQ Corp. #01129558. Maps Courtesy ©Google & ©Microsoft. Although all information is furnished regarding for sale, rental or financing is from sources deemed reliable, such information has not been verified and no express representation is made nor is any to be implied as to the accuracy thereof, and it is submitted subject to errors, omissions, changes of price, rental or other conditions, prior sale, lease or financing, or withdrawal without notice.

CORPORATE NEIGHBORS & NEARBY AMENITIES

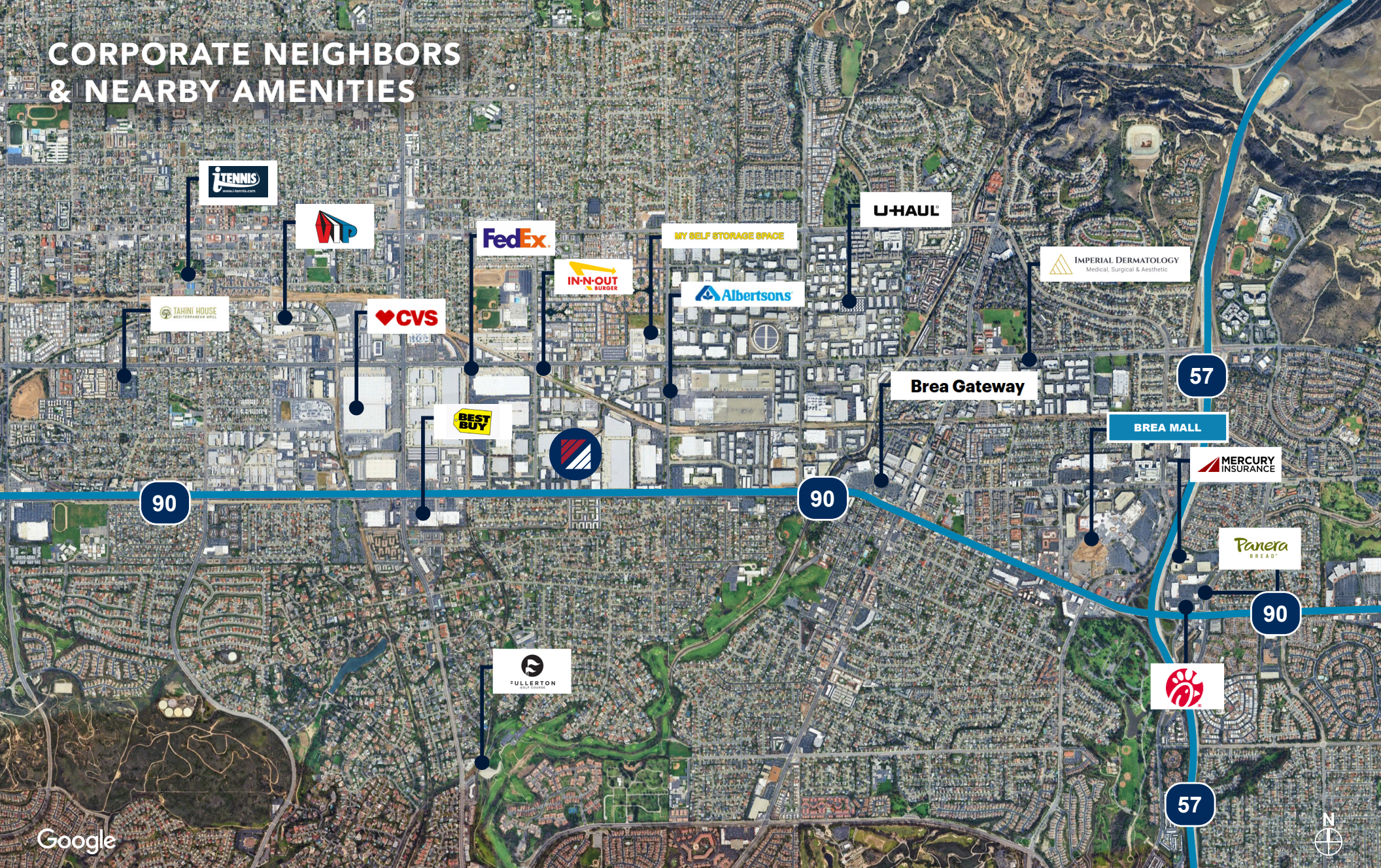

Google

FOR MORE INFORMATION, CONTACT:

DENNIS HOLT

Executive Vice President

P: 949.242.1714

dennis.holt@daumcommercial.com

CADRE #01948978

PAUL GINGRICH

Executive Vice President

P: 714.941.5333

paul.gingrich@daumcommercial.com

CADRE #01299770

CHRIS MIGLIORI

President

P: 714.941.5320

chris.migliori@daumcommercial.com

CADRE #00972843

DAUM
COMMERCIAL REAL ESTATE SERVICES

D/AQ Corp. #01129558. Maps Courtesy ©Google & ©Microsoft. Although all information is furnished regarding for sale, rental or financing is from sources deemed reliable, such information has not been verified and no express representation is made nor is any to be implied as to the accuracy thereof, and it is submitted subject to errors, omissions, changes of price, rental or other conditions, prior sale, lease or financing, or withdrawal without notice.