



winter
BOSTON, MA

NEW LOWER PRICE | \$38/SF



BUILDING SIZE

150,183 SF on 10 Floors



AVAILABLE SPACE

6th Floor: 15,853 RSF

7th Floor: 8,034 RSF

10th Floor: 6,744 RSF



ASKING RENT

\$38/SF



TERM

Negotiable



Boston Realty Advisors



Boston Realty Advisors is pleased to present 6,744 RSF, 8,034 RSF, and 15,853 RSF for lease at One Winter Street, available immediately. This 10th floor penthouse suite offers fantastic views of Boston as well as 24-hour security, and is next to Boston's busiest transportation hub.

The property is owned and managed by The Druker Company, Ltd.

AMENITIES

- Food court within building
- 24-hour building security
- Full floor identity
- Walking distance to MBTA Commuter Rail and Orange, Red, Silver, Blue & Green Lines
- Affordable parking nearby
- Close to several restaurants, hotels and shops
- Part of Downtown Boston Business Improvement District

6th FLOOR PLAN - 15,853 RSF



AS BUILT

7th FLOOR PLAN - 8,034 RSF



10th FLOOR PLAN - 6,744 RSF

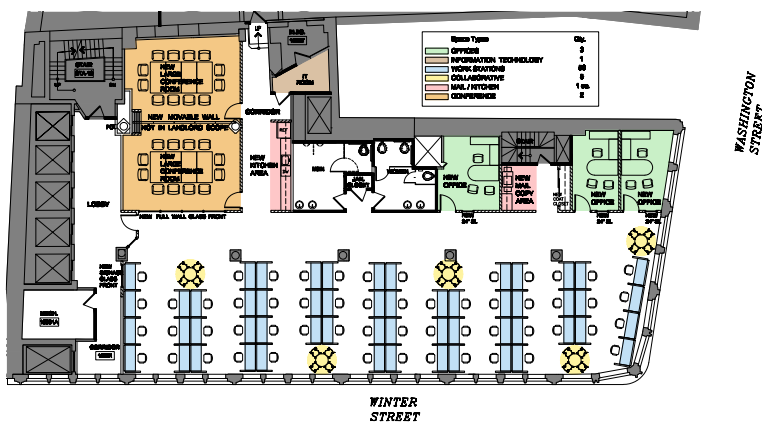

WINTER STREET



BONNY L. DOORAKIAN

617.850.9655

bdoorakian@bradvisors.com



Boston Realty Advisors

ENTREPRENEURIAL AGILITY. INSTITUTIONAL EXPERTISE.

136 Newbury Street | Boston, MA 02116 | 617.375.7900 | BRAdvisors.com

© Copyright Boston Realty Advisors. All rights reserved. The information contained here has been obtained through sources deemed reliable but cannot be guaranteed as to its accuracy. Any information of special interest should be obtained through independent verification.