

FOR LEASE
THE CENTER OF COMMERCE BLDG 200
4306 SHADER ROAD | ORLANDO, FL 32808



32,659 SF AVAILABLE NOW



The Center of Commerce is a 300± acre Class A business and industrial park, that is beautifully landscaped and maintained. The Park contains 29 buildings totaling in excess of 1.4 million SF. The current ownership owns and controls 14 of those buildings totaling 1,253,103 SF, and has just completed two (2) new buildings totaling an additional 221,216 SF.

Leasing Contacts:

William "Bo" Bradford, CCIM, SIOR
bbradford@lee-associates.com
D 321.281.8502

Tim Perry, CCIM, SIOR
tperry@lee-associates.com
D 321.281.8515

All information furnished regarding property for sale, rental or financing is from sources deemed reliable, but no warranty or representation is made to the accuracy thereof and same is submitted to errors, omissions, change of price, rental or other conditions prior to sale, lease or financing or withdrawal without notice. No liability of any kind is to be imposed on the broker herein.

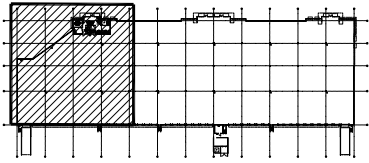

KEY PLAN

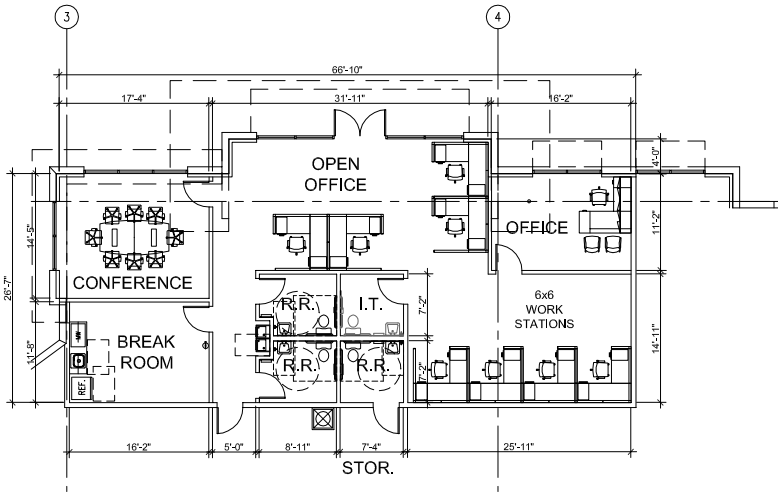

FLOOR PLAN - 1,977 SF

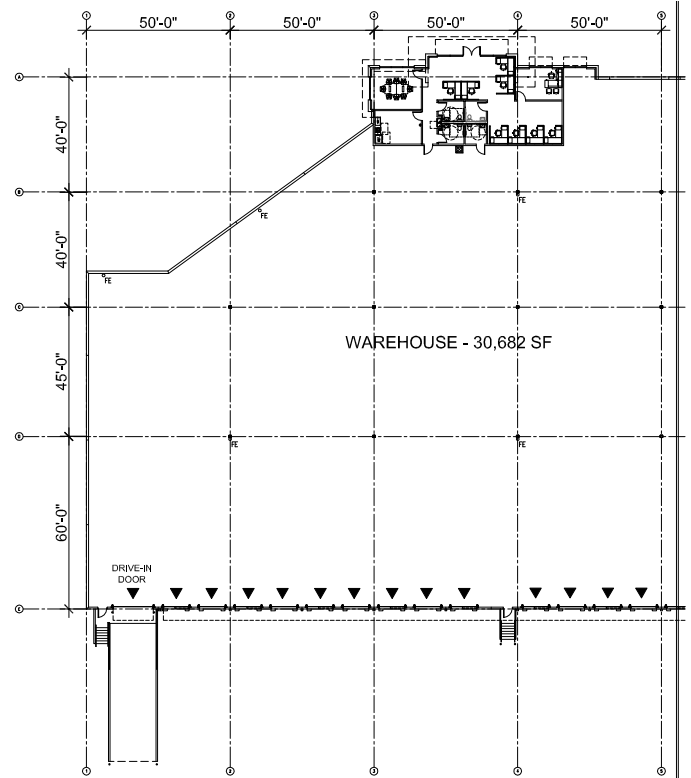

OVERALL PLAN - 32,659 SF

AVAILABILITY

BUILDING SF:	108,101 SF
AVAILABLE SF:	32,659
OFFICE SF:	1,977 SF
CLEAR HEIGHT:	32'
BUILDING DEPTH:	185'
SPRINKLER:	ESFR
TRUCK COURT:	190' Shared including a 60' concrete apron
LEASE RATE:	\$10.95/SF NNN
OP EX:	\$3.15/SF

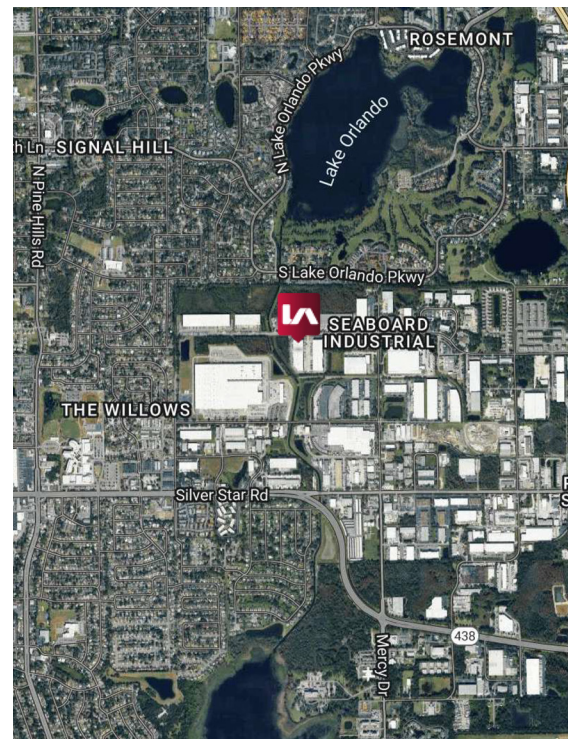

SUITE PHOTOS



THE CENTER OF COMMERCE BLDG 200

4306 SHADER ROAD | ORLANDO, FL 32808

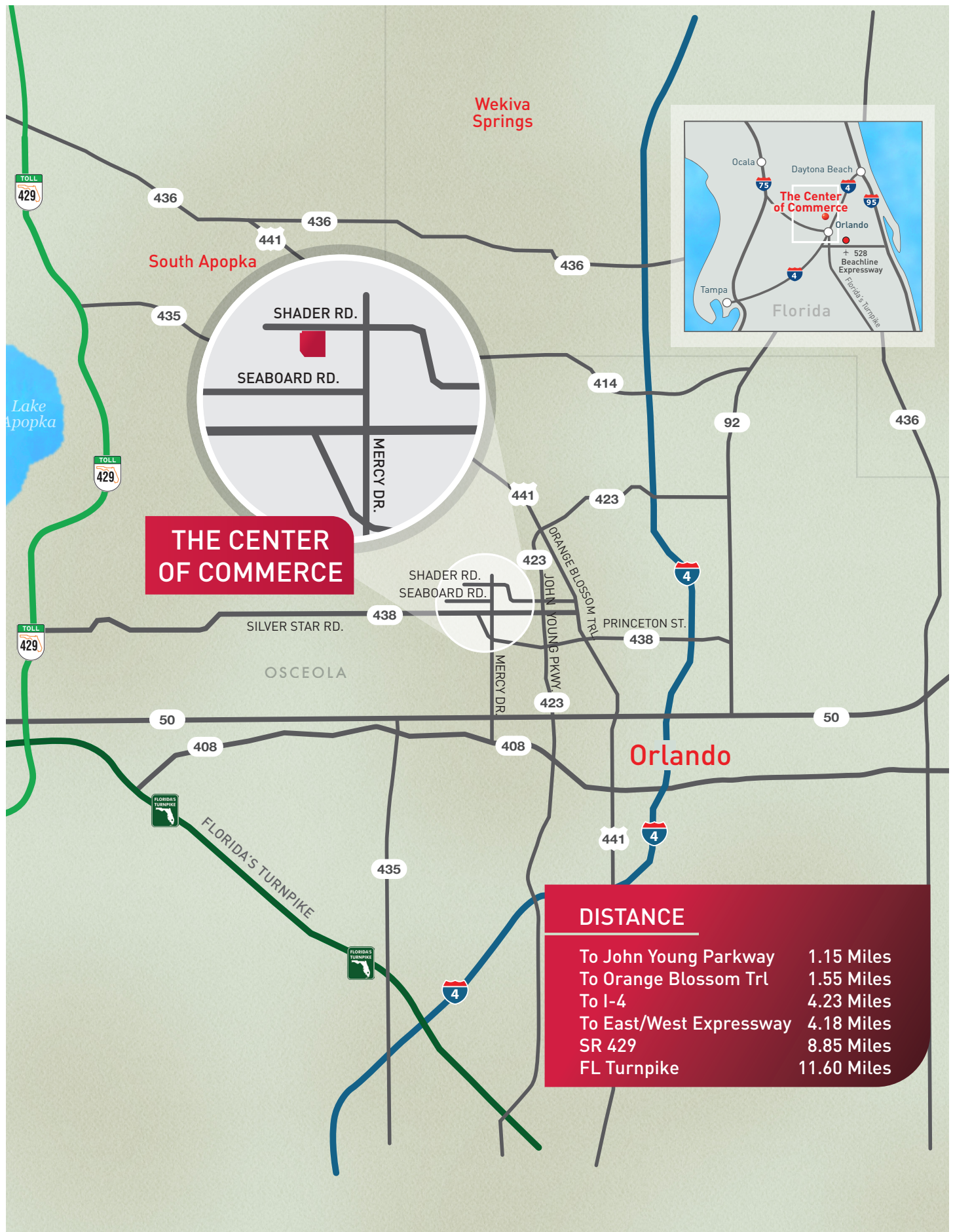

THE CENTER OF COMMERCE

DISTANCE	
To John Young Parkway	1.15 Miles
To Orange Blossom Trl	1.55 Miles
To I-4	4.23 Miles
To East/West Expressway	4.18 Miles
SR 429	8.85 Miles
FL Turnpike	11.60 Miles