

JANSEN CENTER

West of SWC Blue Diamond Rd & Decatur Blvd
Las Vegas, NV 89139

418,000
ANNUAL VISITS
Placer.ai 2025



CALL US FOR
MORE INFO

DAN ADAMSON

702.550.4934 | dan@roicre.com
Lic # B.0026992.CORP

CHRIS WALDBURGER, CCIM

702.483.3683 | chris@roicre.com
Lic # S.0190814



roicre.com

PROPERTY HIGHLIGHTS

JANSEN CENTER
Blue Diamond & Decatur W-SWC
Las Vegas, NV 89139

±2,600 SF
WITH DRIVE-THRU

±4,000 SF
WITH NO DRIVE-THRU

- State of the art design at the popular Blue Diamond Retail/Restaurant Corridor
- This center has excellent cross access with the adjacent center, which is anchored by EOS Fitness
- Direct access from Blue Diamond Rd
- Exposure to over 83,000 vehicles per day (combined)
- Close proximity to affluent neighborhoods and master planned communities

 **±0.43 AC**
Parcel Size

 **General Commercial (C-2)**
Zoning

 **176-13-801-050**
Parcel Number



SITE AERIAL

JANSEN CENTER
Blue Diamond & Decatur W-SWC
Las Vegas, NV 89139



PROPERTY SITE PLAN

JANSEN CENTER
Blue Diamond & Decatur W-SWC
Las Vegas, NV 89139

±2,600 SF
WITH DRIVE-THRU

±4,000 SF
WITH NO DRIVE-THRU

±0.43 AC
PARCEL SIZE

Suite	Tenant	Size (SF)
101-102	The Breakfast Spot	3,285
103	Beauty Factory MedSpa	1,460
104	Drop Sauna	1,680
105-106	Pullman Bread & UNO Katsu Sando	2,520
107-108	MJ Nails & Spa	2,800
109	Apricot Lane Boutique	1,460
110	Smoothie King	1,460
111	Tacotarian	1,825
PAD	AVAILABLE	2,600

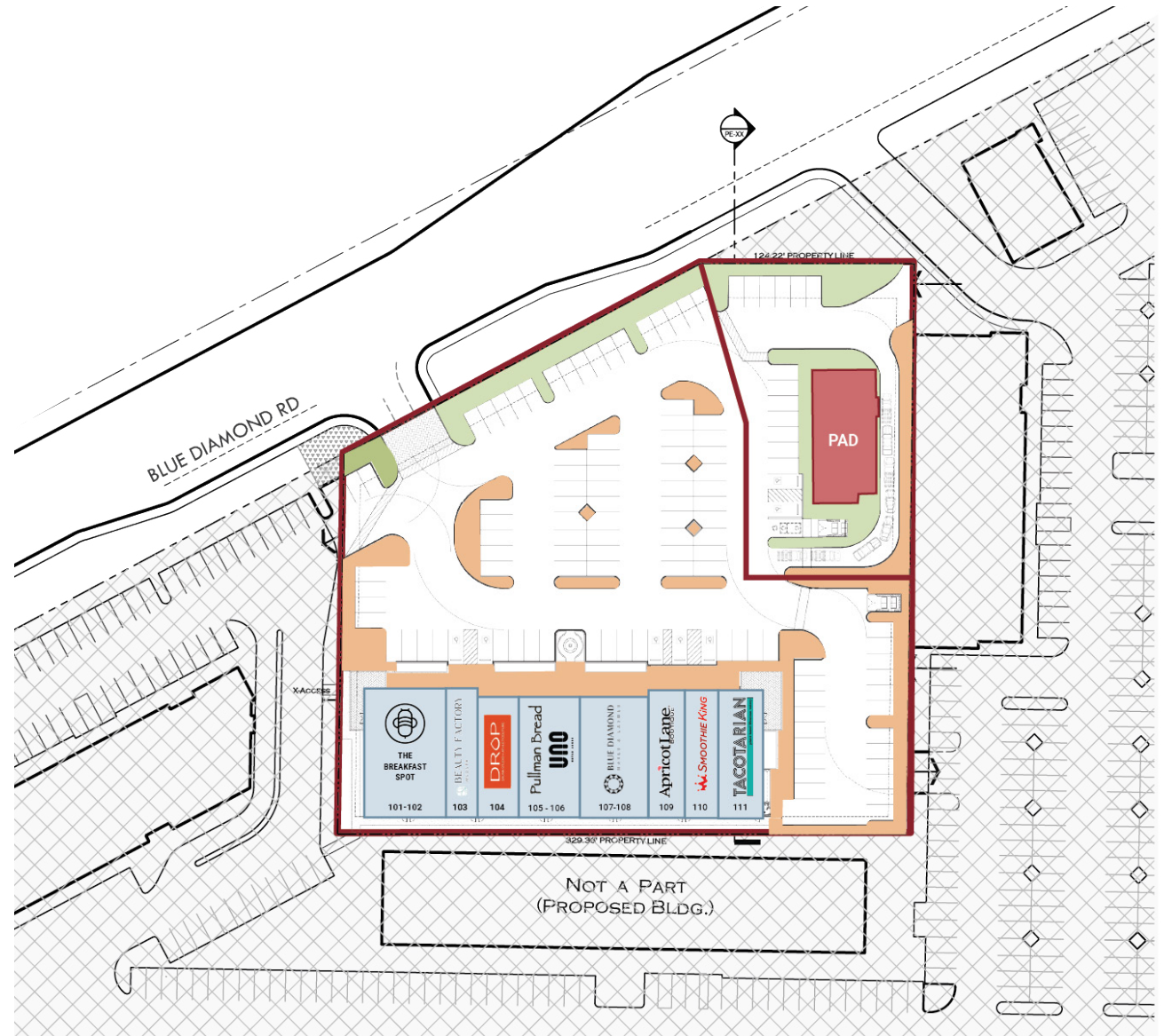

AREA DEMOGRAPHICS



POPULATION

1 Mile	3 Miles	5 Miles
9,449	121,565	340,706



AVERAGE HOUSEHOLD INCOME

1 Mile	3 Miles	5 Miles
\$143,337	\$127,711	\$124,808



TRAFFIC COUNTS

Blue Diamond Rd	Decatur Blvd
65,000 VPD	19,900 VPD

Sources:
SitesUSA 2025
TRINA, NV DOT 2024

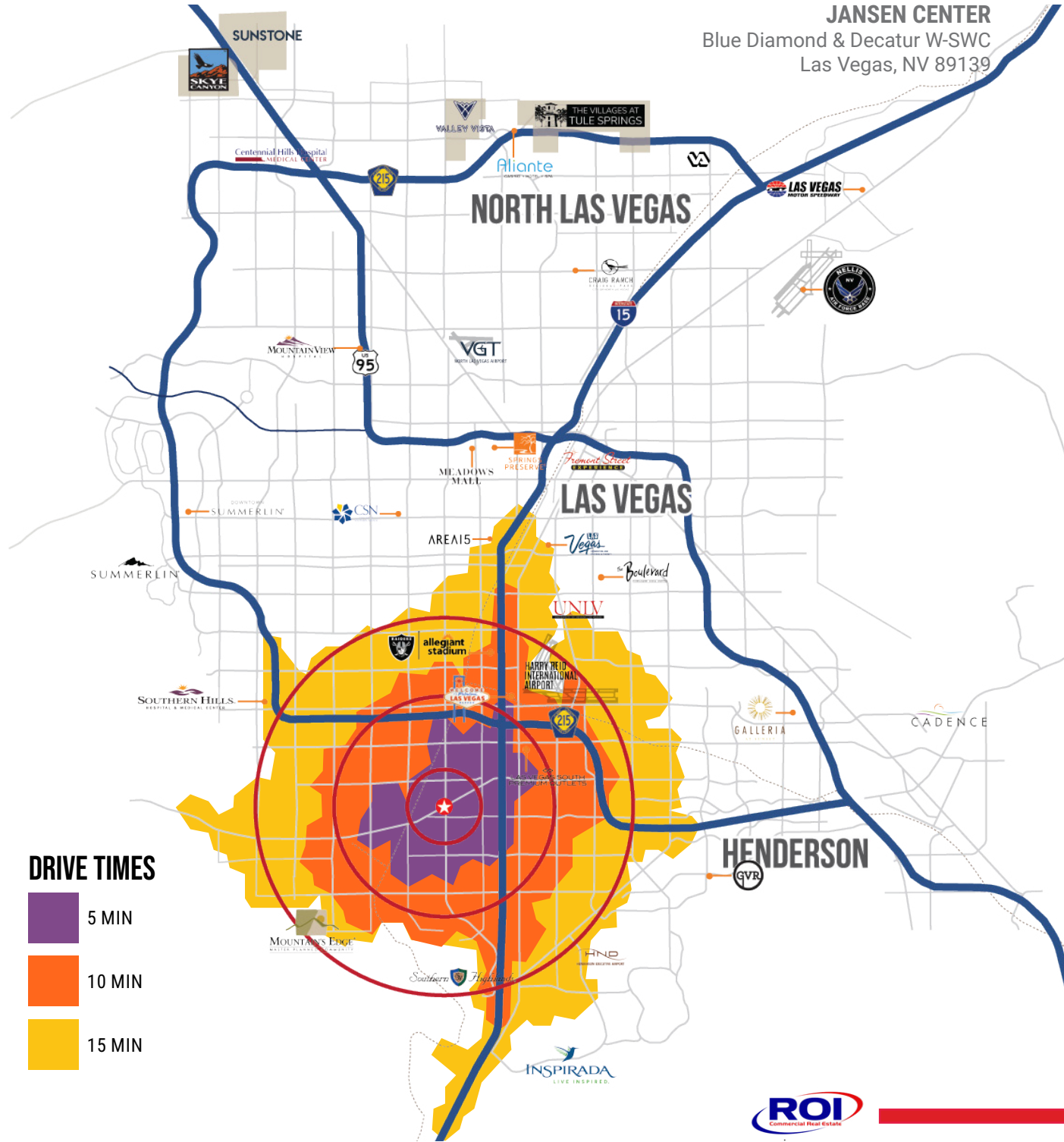

JANSEN CENTER

WEST OF SWC BLUE DIAMOND RD & DECATUR BLVD
LAS VEGAS, NV 89139





www.roicre.com



 9121 W Russell Rd
Suite 111
Las Vegas, NV 89148

CALL US FOR MORE INFO

DAN ADAMSON

-  702.550.4934
-  dan@roicre.com
-  NV Lic# B.0026992.CORP

CHRIS WALDBURGER, CCIM

-  702.483.3683
-  chris@roicre.com
-  NV Lic S.0190814

Let's Stay Connected!

-  roicre
-  @roicre
-  @roi.cre
-  roicre/

DISCLAIMER

All information contained herein is from sources we deem reliable, and we have no reason to doubt its accuracy; however, no guarantee or responsibility is assumed thereof, and it shall not form any part of future contracts. Properties are submitted subject to errors and omissions and all information should be carefully verified. All measurements quoted herein are approximate.

Demographics are provided by SitesUSA using data from private and government sources deemed to be reliable. The information herein is provided without representation or warranty.

Georeferenced data herein are provided by Placer Labs, Inc. and is provided without representation or warranty.

Photos contained herein are property of their respective owners. Photos do not guarantee the current condition of the property.

02/10/26