



# FOR LEASE

2300 Mayflower Ave,  
Apopka, FL 32703



|                    |   |
|--------------------|---|
| <b>Building:</b>   | 2,400 ± SF  |
| <b>Office:</b>     | 300 ± SF  |
| <b>Warehouse:</b>  | 2,100 ± SF  |
| <b>Clear Ht:</b>   | 14'   |
| <b>Doors:</b>      | (2) Grade 12x12   |
| <b>Year Built:</b> | 1997  |
| <b>Lot Size:</b>   | 0.34 Ac   |
| <b>Add. Feat:</b>  | <ul style="list-style-type: none"><li>Fenced Lot</li><li>21' Overhang</li></ul> |
| <b>Lease Rate:</b> | Call for details  |

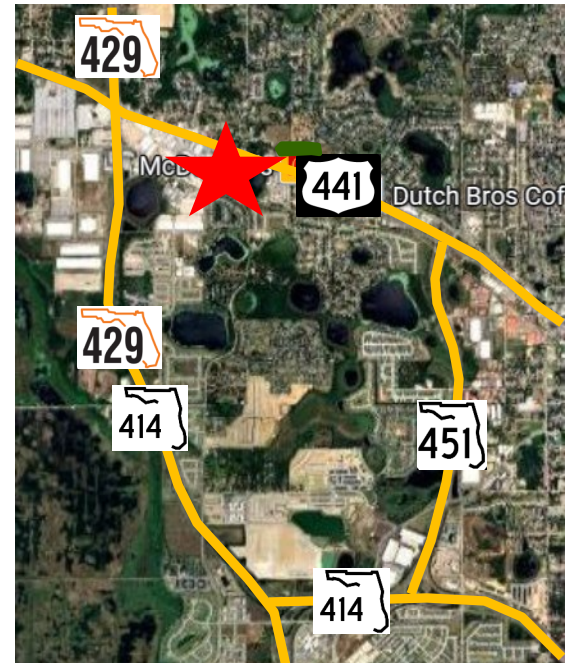

McNulty Group, Inc. is the agent of the Landlord or Seller of this property and will be paid by the Landlord or Seller. All information furnished with respect to the subject property has been obtained from sources deemed reliable. No representation as to accuracy thereof is made. This offering is subject to errors, omissions, prior sales or withdrawal without notice.

## Chuck McNulty

Broker

[Chuck@mcnultygroupinc.com](mailto:Chuck@mcnultygroupinc.com)

(407) 619-4245 Direct

## McNulty Group Inc.

2315 Lynx Lane, Suite 6

Orlando, Florida 32804

407-532-3441





# FOR LEASE

2300 Mayflower Ave,

Apopka, FL 32703

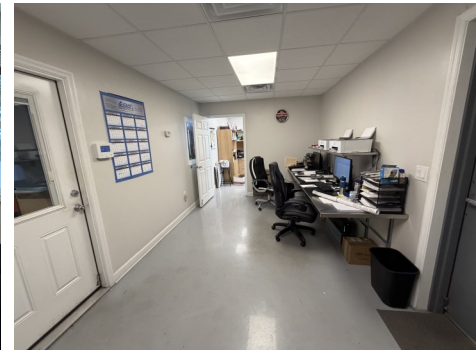
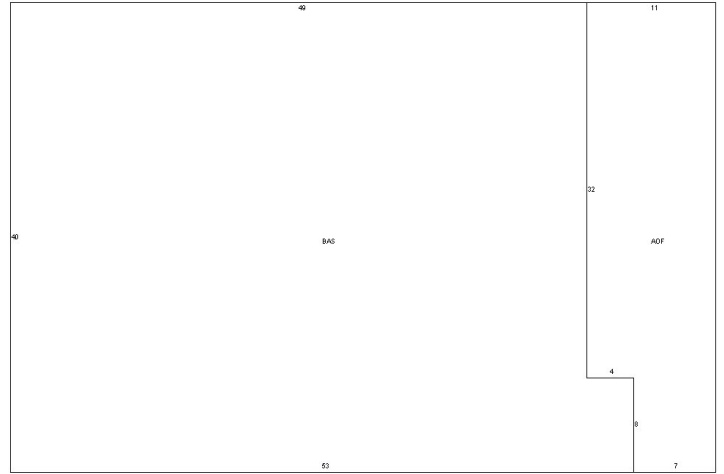

**Chuck McNulty**

Broker

[Chuck@mcnultygroupinc.com](mailto:Chuck@mcnultygroupinc.com)

(407) 619-4245 Direct

[mcnultygroupinc.com](http://mcnultygroupinc.com)

**McNulty Group Inc.**

2315 Lynx Lane, Suite 6

Orlando, Florida 32804

407-532-3441