

# 2500 WEST NORTH AVENUE

wicker park/humboldt park / chicago, il



MID-AMERICA<sup>®</sup> URBAN

AVAILABLE IMMEDIATELY



# 2500 WEST NORTH AVENUE

wicker park/humboldt park / chicago, il

## SPACE DETAILS

### ADDRESS

2500 W North Avenue  
Chicago, Illinois

North & Western Avenue

### AVAILABILITY

1,200 SF - 4,800 SF

### AREA TENANTS



### FEATURES

Shopping center services Chicago's Humboldt Park, Bucktown, Wicker Park, West Town and Logan Square neighborhoods

Just west of the busy intersection of North Avenue and Western Avenue with approximately 51,700 VPD

- 20,700 VPD on North Avenue
- 31,000 VPD on Western Avenue

Rare surface parking available

4.5M annual weekday riders on the North Avenue CTA bus

5.2M annual weekday riders on the Western Avenue CTA bus

1/2 mile north of AMITA Health Saints Mary and Elizabeth Hospital - 495 Beds, 900+ employees



### DEMOGRAPHICS

	.25M	.5M	1M
AVG HOUSEHOLD INCOME	\$91,703	\$99,420	\$100,336
POPULATION	5,363	20,000	73,538
DAYTIME POPULATION	3,207	14,900	50,380

# 2500 WEST NORTH AVENUE

wicker park/humboldt park / chicago, il

AREA RETAIL AERIAL



# 2500 WEST NORTH AVENUE

wicker park/humboldt park / chicago, il

SITE PLAN

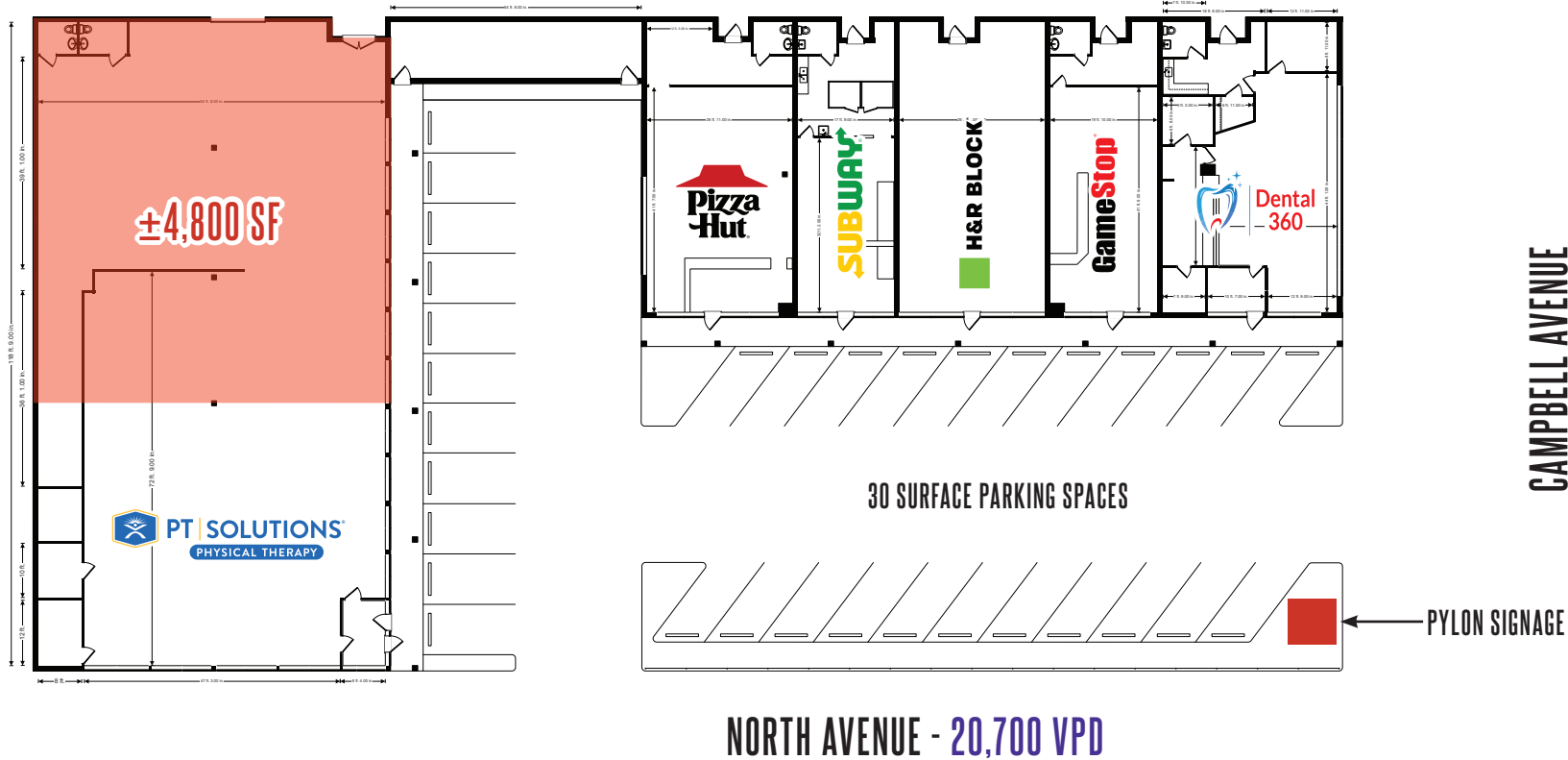

## SPACE DETAILS

1,220 SF - 4,800 SF



# 2500 WEST NORTH AVENUE

wicker park/humboldt park / chicago, il

DEMISED SITE PLAN

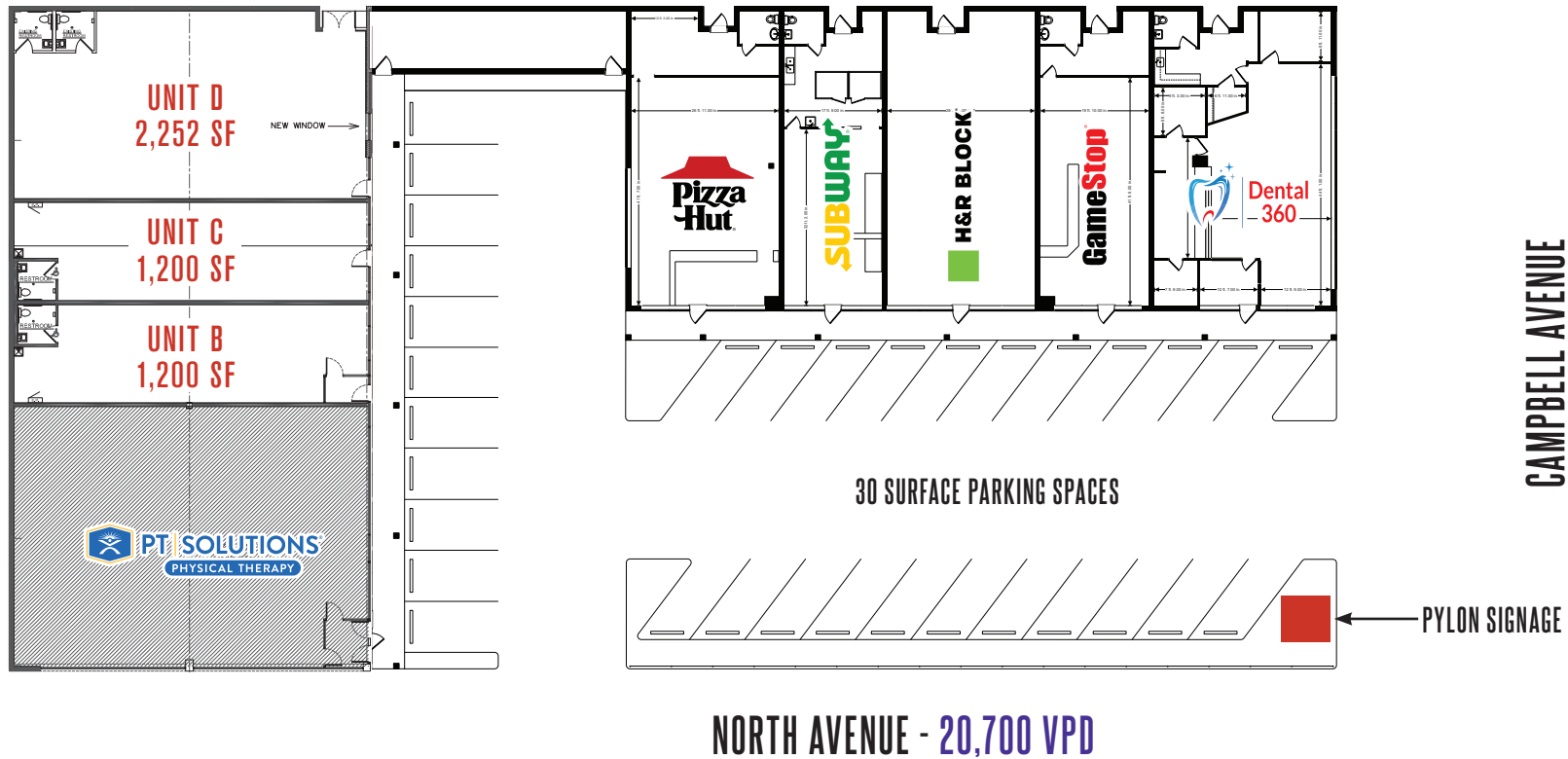

## SPACE DETAILS

1,200 SF - 4,800 SF



# 2500 WEST NORTH AVENUE

wicker park/humboldt park / chicago, il

EXTERIOR SITE PHOTO



let's **BIG**  
talk.

**IDEAS?**

**PAUL BRYANT**

Mid-America Real Estate Corporation

630.954.7354

[PBryant@MidAmericaGrp.com](mailto:PBryant@MidAmericaGrp.com)

**WESTIN KANE**

Mid-America Real Estate Corporation

630.954.7447

[WKane@MidAmericaGrp.com](mailto:WKane@MidAmericaGrp.com)



**MID-AMERICA<sup>®</sup> URBAN**