

210 Crossways Park Drive
Woodbury, NY

GLA: 24,000 SF
Parking: 5 : 1,000
120 Cars

New Ownership – Major Building Renovations



Available: 17,057 RSF – Will Divide

- Comments:**
- High Ratio of Window to Floor Area
 - Build-To-Suit New Installations for Tenants
 - Directly Metered Electric
 - Tenant-Controlled HVAC
 - Dedicated Tenant Bathrooms
 - 24 Hour / 7 Day Access
 - Verizon and Lightpath in Building
 - Building Pylon Signage Available
 - Abundant and Convenient Parking
 - Ability to Create Isolated Office Environment
 - Dedicated Long-Term Ownership

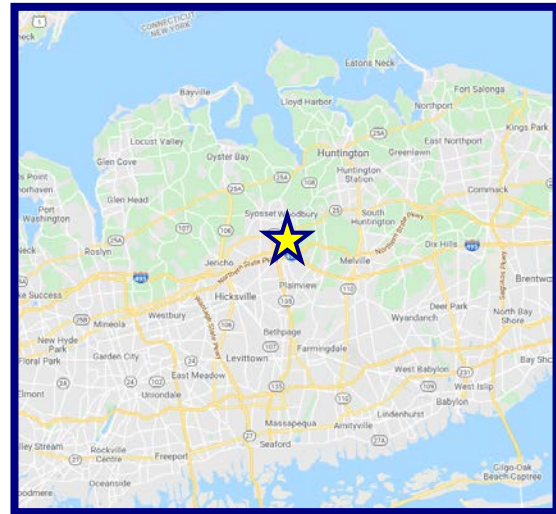

Floor Plan On Reverse

For Further Information and Inspection, Contact Exclusive Agent:

Franklin S. Zuckerbrot

LL Comp Broker

718-512-0295

fz@s-z.com

Sholom & Zuckerbrot Realty LLC
Established 1962
Exclusive Leasing and Managing Agents



ONE FULL COMMISSION in accordance with our principal's schedule of rates and conditions (copy of which is available upon request) will be paid to the procuring broker executing our brokerage agreement who consummates a lease which has been fully executed by both parties thereto.

Kaufman Astoria Studios 35-11 35th Avenue, LIC, NY 11106 (718) 392-5959 Fax (718) 937-6546

Although all information is from sources deemed reliable, and no representation is made as to the accuracy thereof, it is submitted subject to errors, omissions, changes of price, prior sale, or withdrawal without notice

Floor Plan

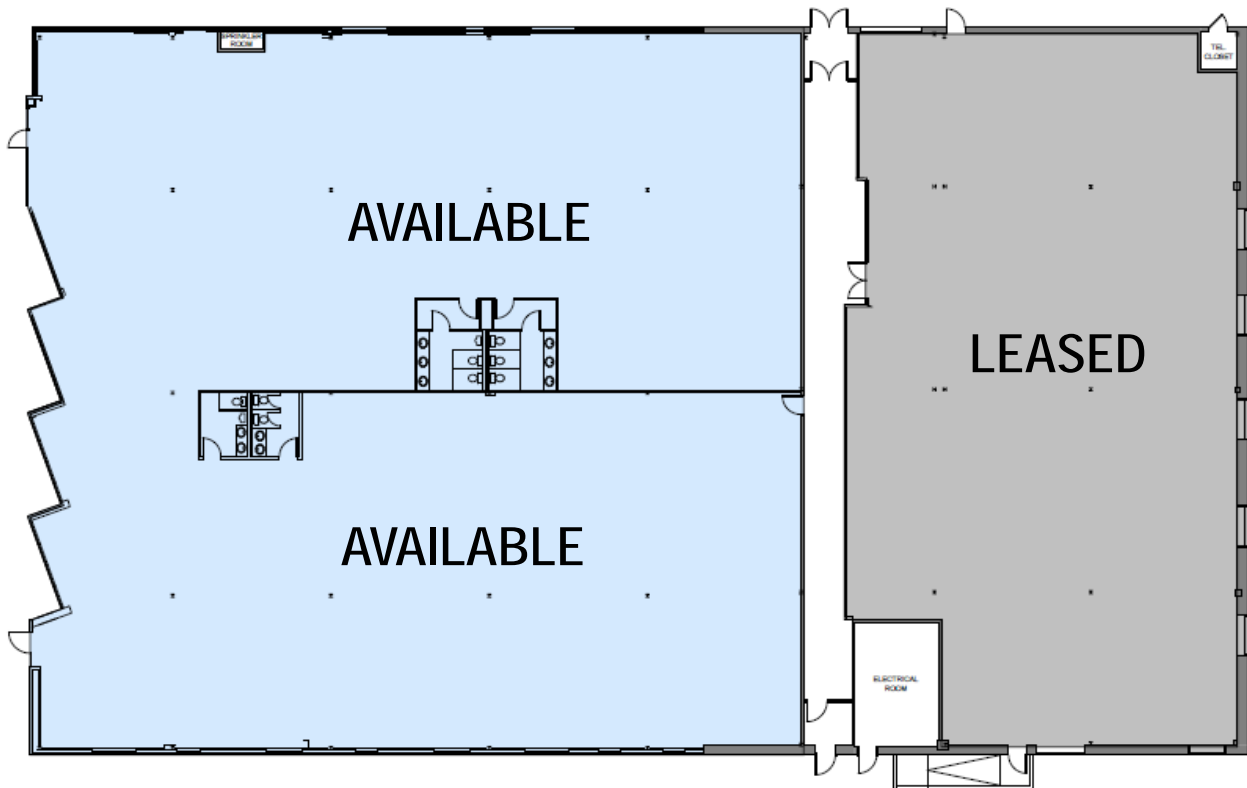

17,057 Total RSF
Will Divide

For Further Information and Inspection, Contact Exclusive Agent:

Franklin S. Zuckerbrot

LL Comp Broker

718-512-0295

fz@s-z.com



ONE FULL COMMISSION in accordance with our principal's schedule of rates and conditions (copy of which is available upon request) will be paid to the procuring broker executing our brokerage agreement who consummates a lease which has been fully executed by both parties thereto.

Kaufman Astoria Studios 35-11 35th Avenue, LIC, NY 11106 (718) 392-5959 Fax (718) 937-6546

Although all information is from sources deemed reliable, and no representation is made as to the accuracy thereof, it is submitted subject to errors, omissions, changes of price, prior sale, or withdrawal without notice