

LOT 4
BLOCK 2
PLAN 1322952

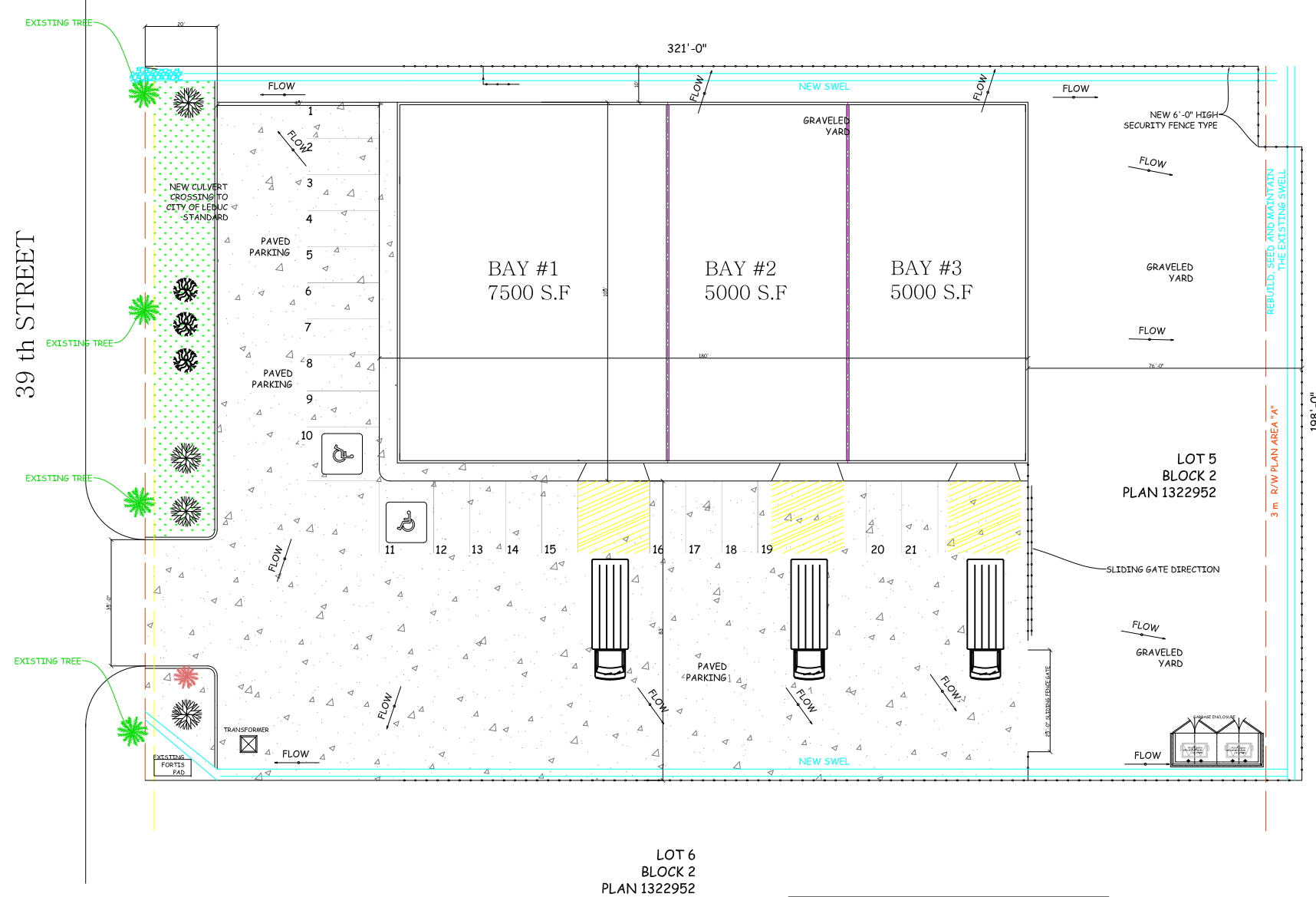

LOT 6
BLOCK 2
PLAN 1322952

LOT SIZE: 1.45 ACRE
BUILDING FOOT PRINT SIZE: 17 500 S.F.
PAVED PARKING SIZE: 12 175 S.F.
GRAVELED YARD SIZE: 15 048 S.F.



SITE PLAN
SCALE: 1"=20'-0"

- LEGEND:**
- SECURITY FENCE
 - GRASE
 - RIPRAP DRAINAGE

PROPOSED LANDSCAPING				
SYMBL	COMMON NAME	CALIPER	HEIGHT	QUANTITY
	WHITE SPRUCE (PICEA GLUCCA)		2.5m	4
	SWEDISH COLUMNAR (POPULUS TREMULA ERECTA)	60mm		4
	CHOKECHERRY (PRUNUS VIRGINIANA)	60mm	600mm	2
	SHRUBBY CINQUEFOIL (POTENTILLA FRUTICOSA)		600mm	3
	BAR HARBOUR JUNIPER (JUNIPERUS HORIZONTALIS)		600mm	3

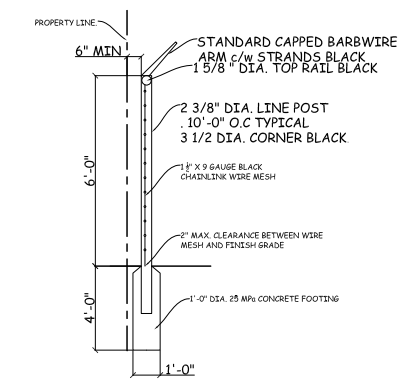

SECURITY FENCE DETAIL

GENERAL NOTES

LEGAL DESCRIPTIONS
ADDRESS: 6205 -39 TH STREET, LEDUC, T9E 0Z3
LOT: 5
BLOCK: 2
PLAN: 1322952
LEDUC, AB.

ZONING
LI: LIGHT INDUSTRIAL

BUILDING INFORMATION
TWO STOREY OFFICE AND ONE STOREY SHOP
FACING ONE STREET
NOT SPRINKLRED
27'-00" EAVE HEIGHT
SINGLE SLOPE 12:12 SLOPE TO 30'-0"
NONCOMBUSTIBLE CONSTRUCTION

SHOP: 12 850 S.F.
OFFICE: 4 650 S.F.
MEZZANINE: 4 650 S.F.
TOTAL BUILDING FOOT PRINT = 17 500 S.F.

OCCUPANCY STATUS
MAJOR OCCUPANCY F DIVISION 2
SHOP
11 180 S.F.
CONSIDERED UNDER SENTENCE 3.2.2.76
ALBERTA BUILDING CODE - 2019 EDITION
MINOR OCCUPANCY D
OFFICE
5 810 S.F.
CONSIDERED UNDER SENTENCE 3.2.2.76
ALBERTA BUILDING CODE - 2019 EDITION
MEZZANINE
5 810 S.F.
CONSIDERED UNDER SENTENCE 3.2.2.76
ALBERTA BUILDING CODE - 2019 EDITION

PARKING COMPONENT
TOTAL STALLS= 25 STALLS

LANDSCAPING COMPONENT
TOTAL SITE AREA - 63 162 S.F.
9 % OF SITE AREA - 5 684 S.F.

TREES REQ'D .1/ 483.9 S.F.
= 5 684 / 483.9 = 11.75 = 12 TREES
TREES PROVIDED = 10 TREES
6 SHRUBS = 2 TREE
EXISTING TREES = 4 TREES

07-05-2024	PRELIMINARY	RV0
------------	-------------	-----

REVIEWS

CONSULTANT:

CUSTOMER:

Aritech Materials LTD

7611 Sparrow Drive, Unit 206, Leduc, AB Canada, T9E 0H3
Phone: 780.612.4177
EMAIL: satishk@nanochemazone.com

Project:

ARITECH BUILDING
6205 - 39TH STREET
LEDUC, AB, T9E 0Z3

DRW TITLE:

SITE PLAN

CONTRACTOR:

ABSK BUILDERS STRUCTURES INC

3603- 75 AVENUE, LEDUC, AB, Canada, T9E 0K3
MAILING ADDRESS: POBOX 1130- NISKU, AB T9E 8A8
Phone: 780.446.2549/ 780.974.7361

conception	project no.	814
drawn	CAD file	CADFILE
approved	client file	
scale	plot date	07-05-2024
sheet number	rev	
A-1	RV-0	

05-02-2024 PRELIMINARY RV0

REVIEWS

CONSULTANT:

CUSTOMER:

ARITECH Materials LTD

7611 Sparrow Drive, Unit 206, Leduc, AB
Canada, T9E 0H3
Phone: 780.612.4177
EMAIL: satishk@nanochemazone.com

Project:

ARITECH BUILDING
6205 - 39TH STREET
LEDUC, AB, T9E 0Z3

DRW TITLE:

MAIN FLOOR PLAN

CONTRACTOR:

ABSK BUILDERS STRUCTURES INC
3234 Winspear cr. sw, Edmonton, T6X 1P2
Phone: 780.446.2549
Email: abskinc@gmail.com

conception	project no.	814
drawn	CAD file	CADFILE
approved	client file	
scale	plot date	07-05-2024
sheet number	rev	
A-4	RV-0	

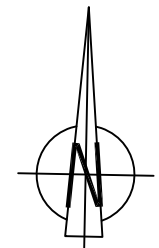
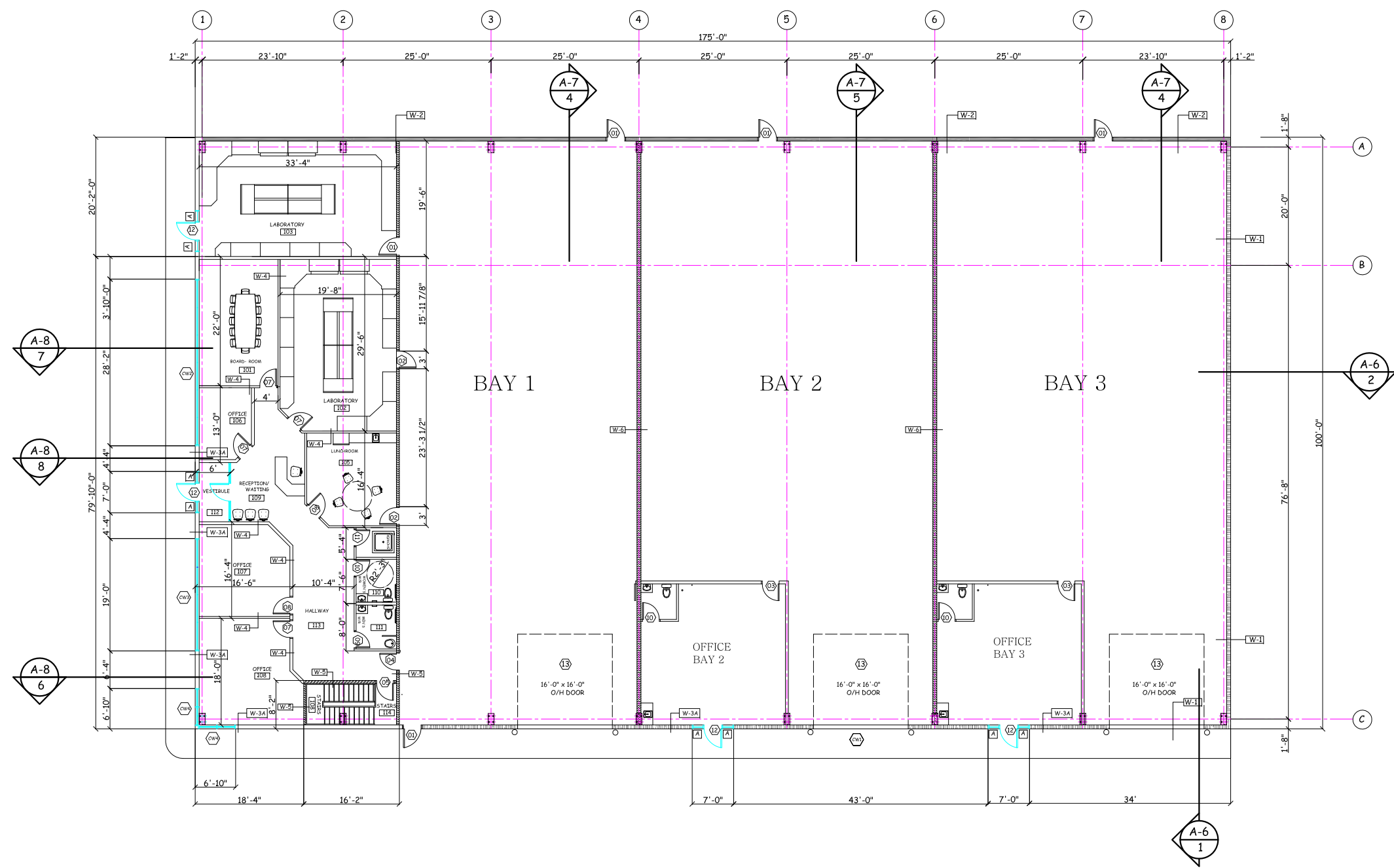

MAIN FLOOR PLAN

SCALE: 1" = 100"

WALL LEGEND

<p>W-1 [Pattern]</p> <p>1 HR. FIRE RATED ULC #W803 ASSEMBLY</p> <p>R30 PRE-FINISHED ROCK WOOL INSULATED PANELS 120MM METAL CF GIRTS (GALVANIZED) EXPOSED BUILDING FRAME (SHOP PRIMED)</p>	<p>W-3 [Pattern]</p> <p>2 HR. FIRE RATED ULC #U301 ASSEMBLY</p> <p>ABOVE ELEV. 103'-0" PRE-FINISHED ROCK WOOL INSULATED PNALES 50MM 6 STEEL PURLINS (GALVANIZED) ROCK WOOL BATT INSULATION 6 m11 POLY VAPOUR BARRIER 1 LAYERS 5/8 " TYPE "X" GYPSUMBOARD TAPED + PAINTED</p>	<p>W-3A [Pattern]</p> <p>3/4 HR. FIRE RATED ULC #W302 ASSEMBLY</p> <p>ABOVE ELEV. 103'-2" PRE-FINISHED ROCK WOOL INSULATED PANELS 50 MM STEEL PURLIS (GALVANIZED) FIBERGLASS BATT INSULATION 6 m11 POLY VAPOUR BARRIER 1/2 "TYPE "X" GYPSUMBOARD TAPED + PAINTED</p>	<p>W-4 [Pattern]</p> <p>1/2 " GYPSUMBOARD TAPED + PAINTED 3 5/8 " STEEL STUDS @ 16" O.C. 1/2 " GYPSUMBOARD TAPED + PAINTED</p>	<p>W-6 [Pattern]</p> <p>2 HR. FIRE RATED ULC #W803/W302 ASSEMBLY</p> <p>2 LAYERS 5/8 " TYPE "X" GYPSUMBOARD TAPED 6" Steel STUDS @ 16" O.C. ROCKWOOL BATT INSULATION 2 LAYERS 5/8 " TYPE "X" GYPSUMBOARD TAPED</p>	<p>W-5 [Pattern]</p> <p>1 HR. FIRE RATED ULC #W301 ASSEMBLY</p> <p>5/8 " TYPE "X" GYPSUMBOARD TAPED + PAINTED 2x6 STEEL STUDS @ 16" O.C. FIBERGLASS BATT INSULATION 5/8 " TYPE "X" GYPSUMBOARD TAPED + PAINTED</p>
<p>W-2 [Pattern]</p> <p>2 HR. FIRE RATED ULC #W803 ASSEMBLY</p> <p>R30 PRE-FINISHED ROCK WOOL INSULATED PANELS 120MM METAL CF GIRTS (SHOP PRIMED) EXPOSED BUILDING FRAME (SHOP PRIMED)</p>	<p>ELEV. 100'-0" TO 103'-2" CULTURED STONE BUILDING PAPER 1 LAYERS 5/8 " EXTERIOR GYPSUMBORD 2x6 STUDS @ 16" O ROCK WOOL INSULATION 6 m11 PLOY VAPOUR BARRIER 1 LAYERS 5/8 " TYPE "X" GYPSUMBOARD TAPED + PAINTED</p>	<p>ELEV. 100'-0" TO 103'-2" CULTURED STONE BUILDING PAPER 1/2 " PLYWOOD SHEATING 2x6 STUD @ 16" O/C FIBERGLASS BATT INSULATION 6m11 POLY VAPOUR BARRIER 1/2 " TYPE "X" GYPSUMBOARD TAPED + PAINTED</p>			

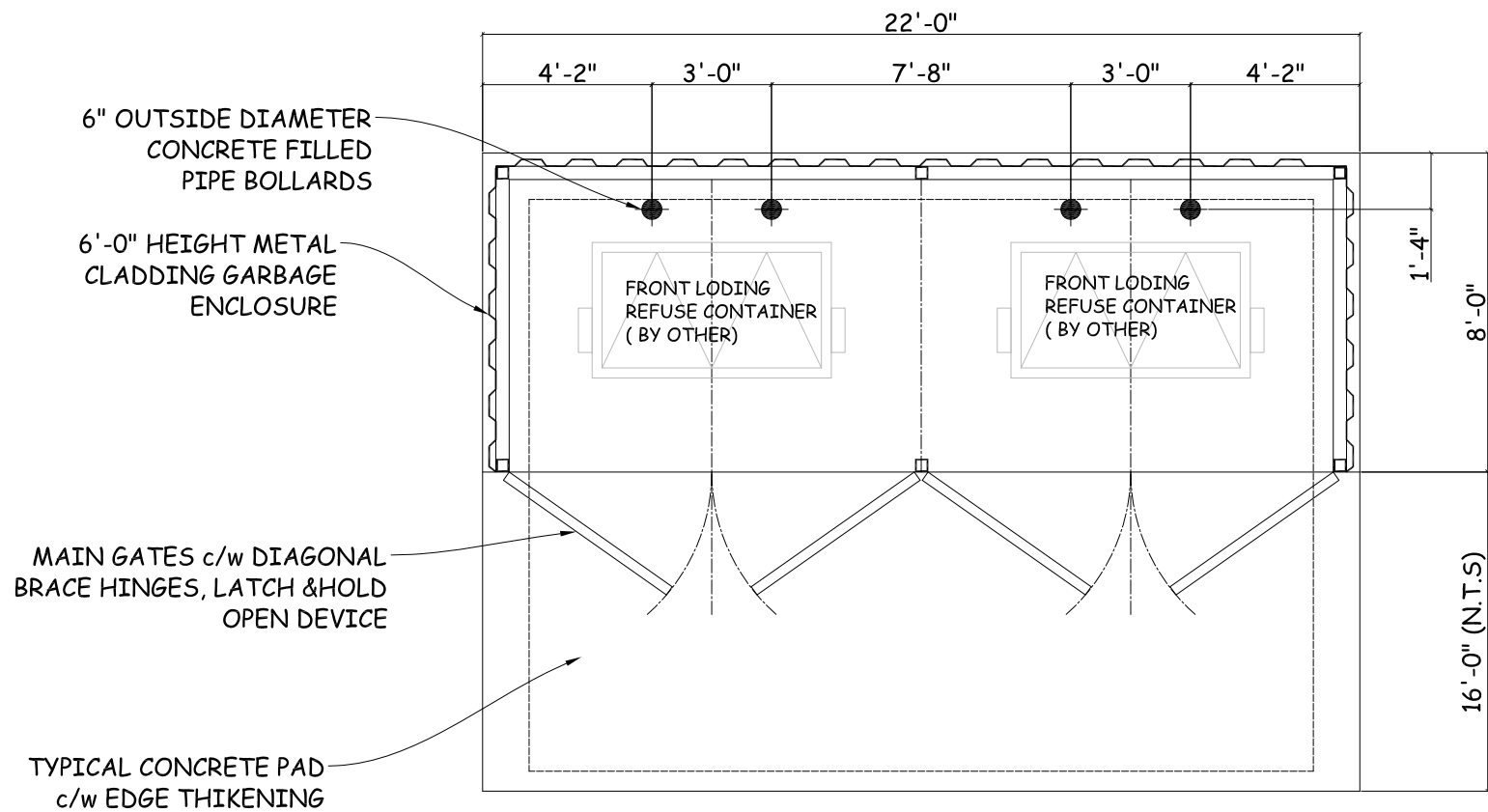

DOUBLE STEEL REFUSE CONTAINER ENCLOSURE

SCALE: 1"=20'-0"

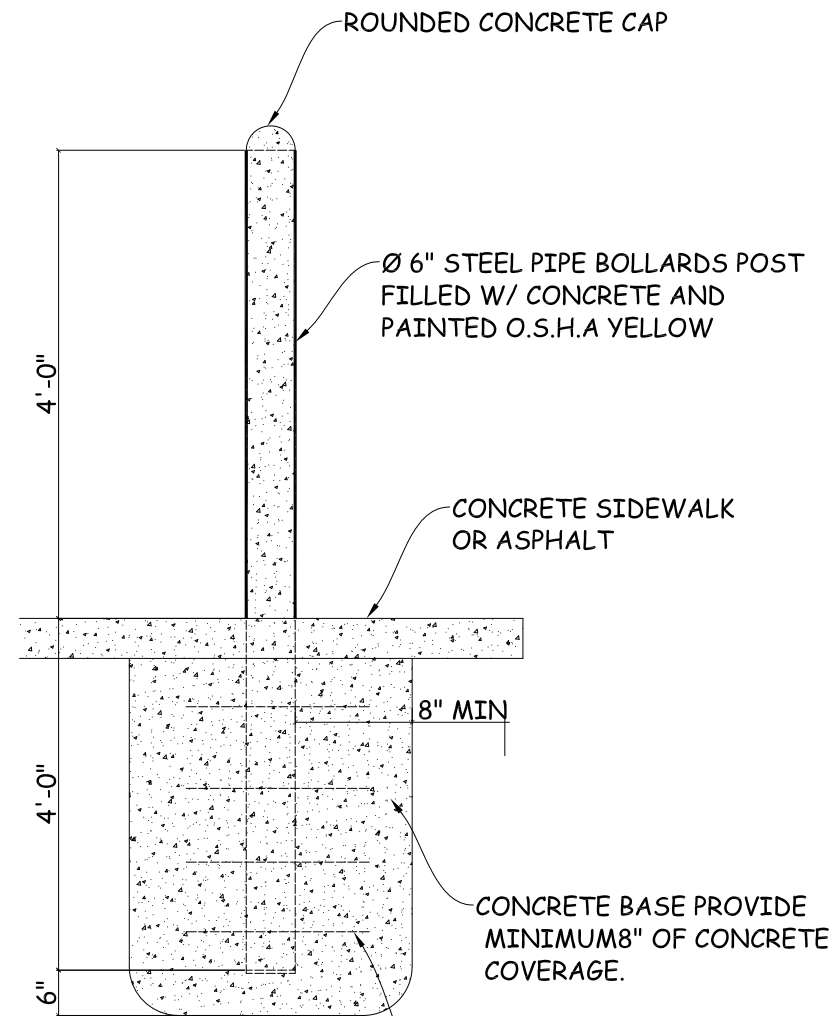

BOLLAR DETAIL

10m STEEL TIES @ 16" O.C

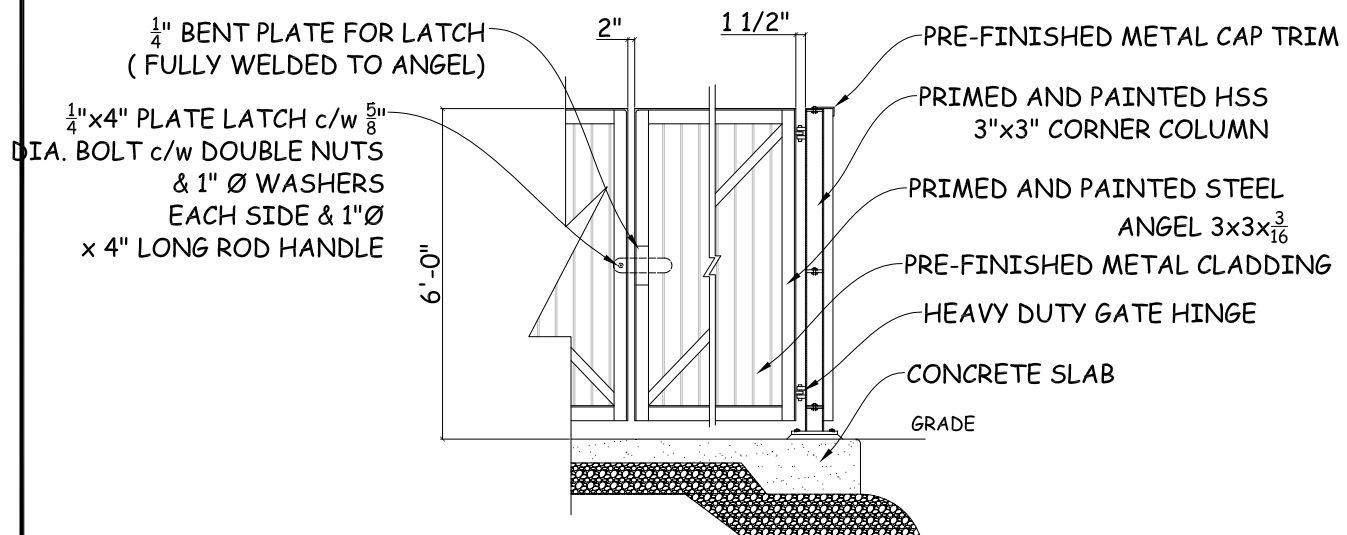

STEEL ENCLOSURE GATE CONSTRUCTION

SCALE: 1"=20'-0"

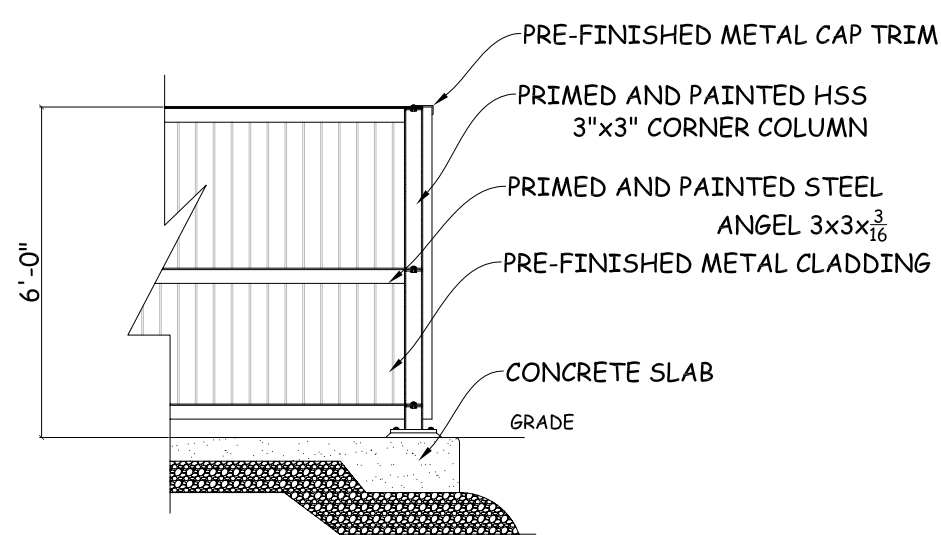

METAL CLADDING REFUSE SECTION

SCALE: 1"=20'-0"

07/05/2024	ISSUED FOR PERMIT	RV0
REVIEWS		

CONSULTANT:

Aritech Materials LTD

7611 Sparrow Drive, Unit 206, Leduc, AB
Canada, T9E 0H3
Phone: 780.612.4177
EMAIL: satishk@nanochemazone.com

Project:

**ARITECH BUILDING
6205 - 39TH STREET
LEDUC, AB, T9E 0Z3**

DRW TITLE: **DETAIL**

CONTRACTOR: **ABSK BUILDERS
STRUCTURES INC**

3234 Winspear Cr Sw, Edmonton, AB, Canada, T16X 1P2
Phone: 780.446.2549
Email: abskinc@gmail.com

conception	S.M	project no.	814
drawn	N.J	CAD file	CADFILE
approved	S.M	client file	
scale		plot date	07-05-2024
sheet number			rev

A-10 **RV-0**

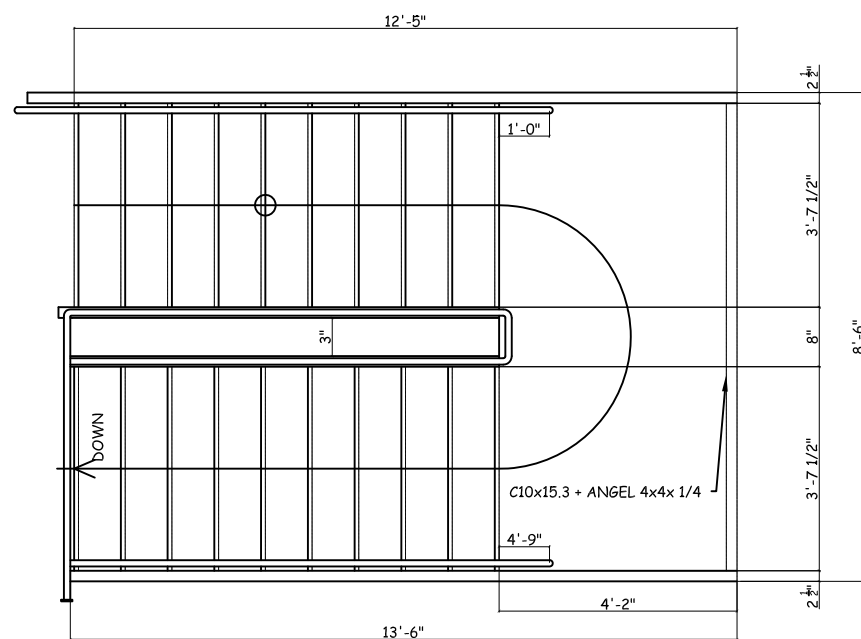
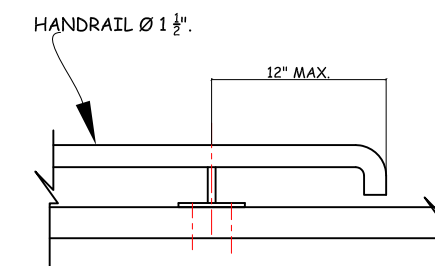
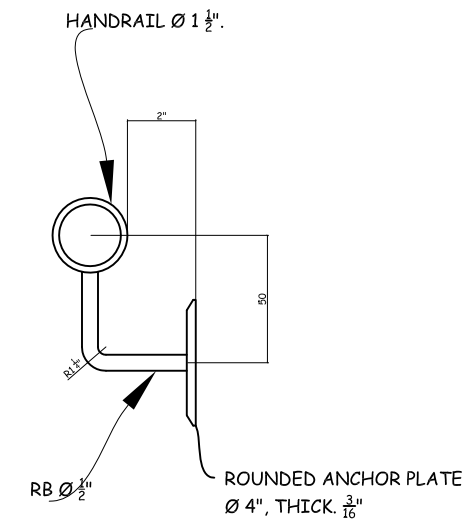
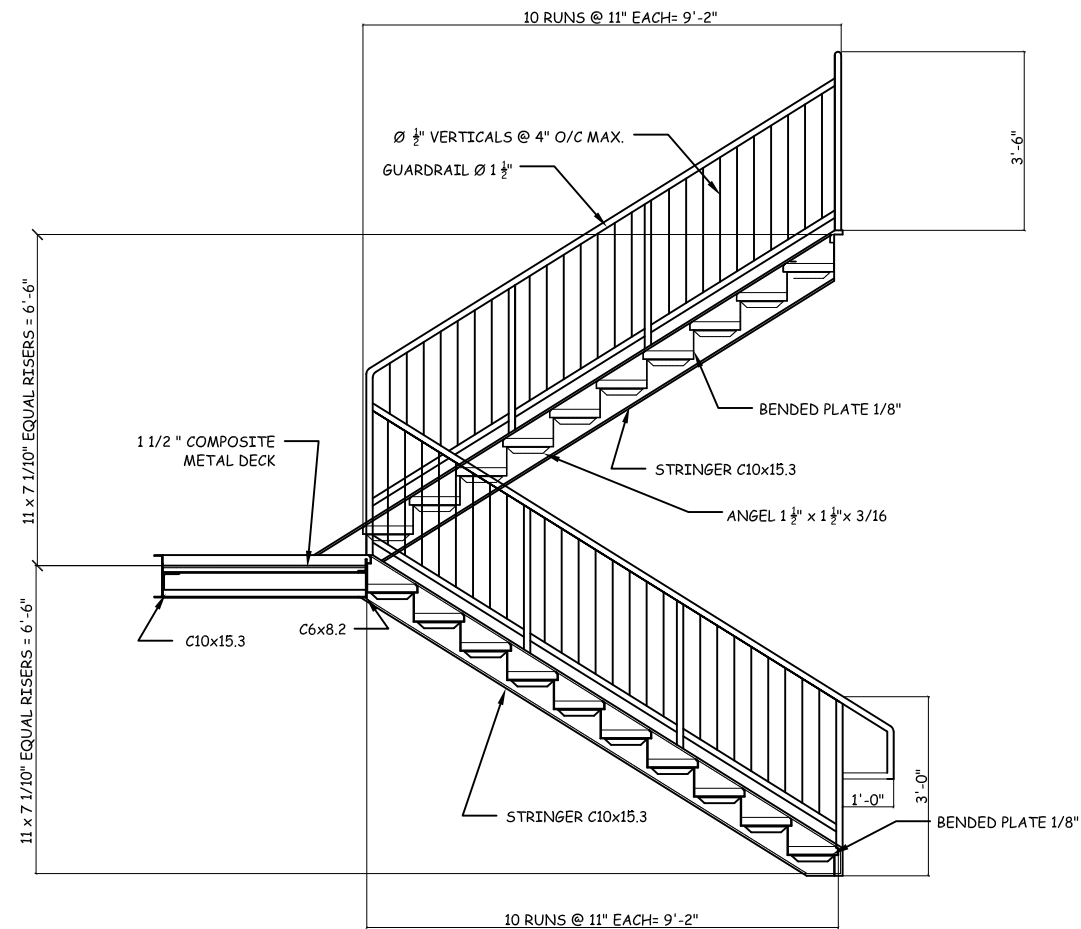

STAIRS

HANDRAIL DETAIL

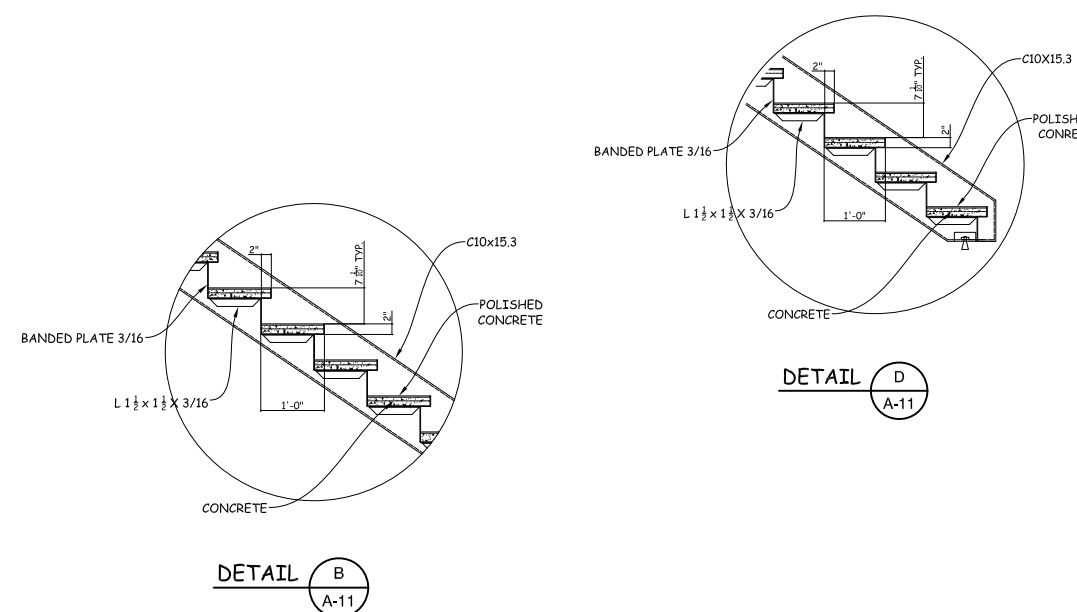

07/05/2024	ISSUED FOR PERMIT	RV0
REVIEWS		

CONSULTANT:

CUSTOMER:

Aritech Materials LTD

7611 Sparrow Drive, Unit 206, Leduc, AB
Canada, T9E 0H3
Phone: 780.612.4177
EMAIL: satishk@nanochemazone.com

Project:

**ARITECH BUILDING
6205 - 39TH STREET
LEDUC, AB, T9E 0Z3**

DRW TITLE: **STAIRS**

CONTRACTOR: **ABSK BUILDERS STRUCTURES INC**

3234 Winspear Cr Sw, Edmonton, AB, Canada, T1T6X1P2
Phone: 780.446.2549
Email: abskinc@gmail.com

conception	project no.	814
drawn	CAD file	CADFILE
approved	client file	
	plot date	07-05-2024
sheet number	rev	

A-11 **RV-0**