



FOR LEASE/SALE

±4,330 SF INDUSTRIAL/FLEX SPACE

800 S. ROCHESTER AVE. | UNIT A | ONTARIO, CA

PROPERTY HIGHLIGHTS

- ±4,330 SF Available
- High-Image Industrial/ Flex Space
- (1) One Ground Level Loading
- 2003 Year Built
- Clear Height 18'
- Immediate Freeway Access to 15, 10 & 60 Freeways
- Professionally Managed Business Park
- Ample On-Site Parking
- Close Proximity to Retail Amenities

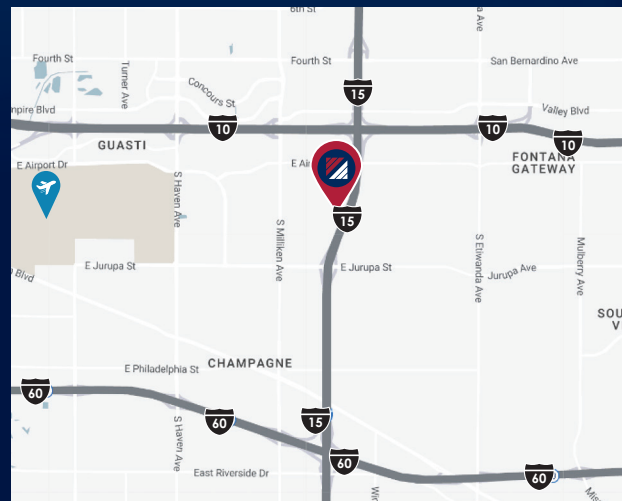

FOR MORE INFORMATION, PLEASE CONTACT:

NOAH SAMARIN
EXECUTIVE V.P. | PRINCIPAL
M: 714.812.1289
noah.samarin@daumcommercial.com
CADRE #01755814

DAVID GORES
VICE PRESIDENT
M: 909.720.9437
david.gores@daumcommercial.com
CADRE # 01502471

NICK CANTU
ASSOCIATE V.P.
M: 714.787.9454
nick.cantu@daumcommercial.com
CADRE # 02016719

COLE FIKSE
ASSOCIATE
M: 951.808.2491
cfikse@daumcommercial.com
CADRE # 02226649

Although all information is furnished regarding for sale, rental or financing from sources deemed reliable, such information has not been verified and no express representation is made nor is any to be implied as to the accuracy thereof, and it is submitted subject to errors, omissions, changes of price, rental or other conditions, prior sale, lease or financing, or withdrawal without notice. All Maps provided courtesy of Google Maps, Bing Maps, and Google Earth. D/AQ Corp. # 01129558



FOR LEASE/SALE

±4,330 SF INDUSTRIAL/FLEX SPACE

800 S. ROCHESTER AVE. | UNIT A | ONTARIO, CA

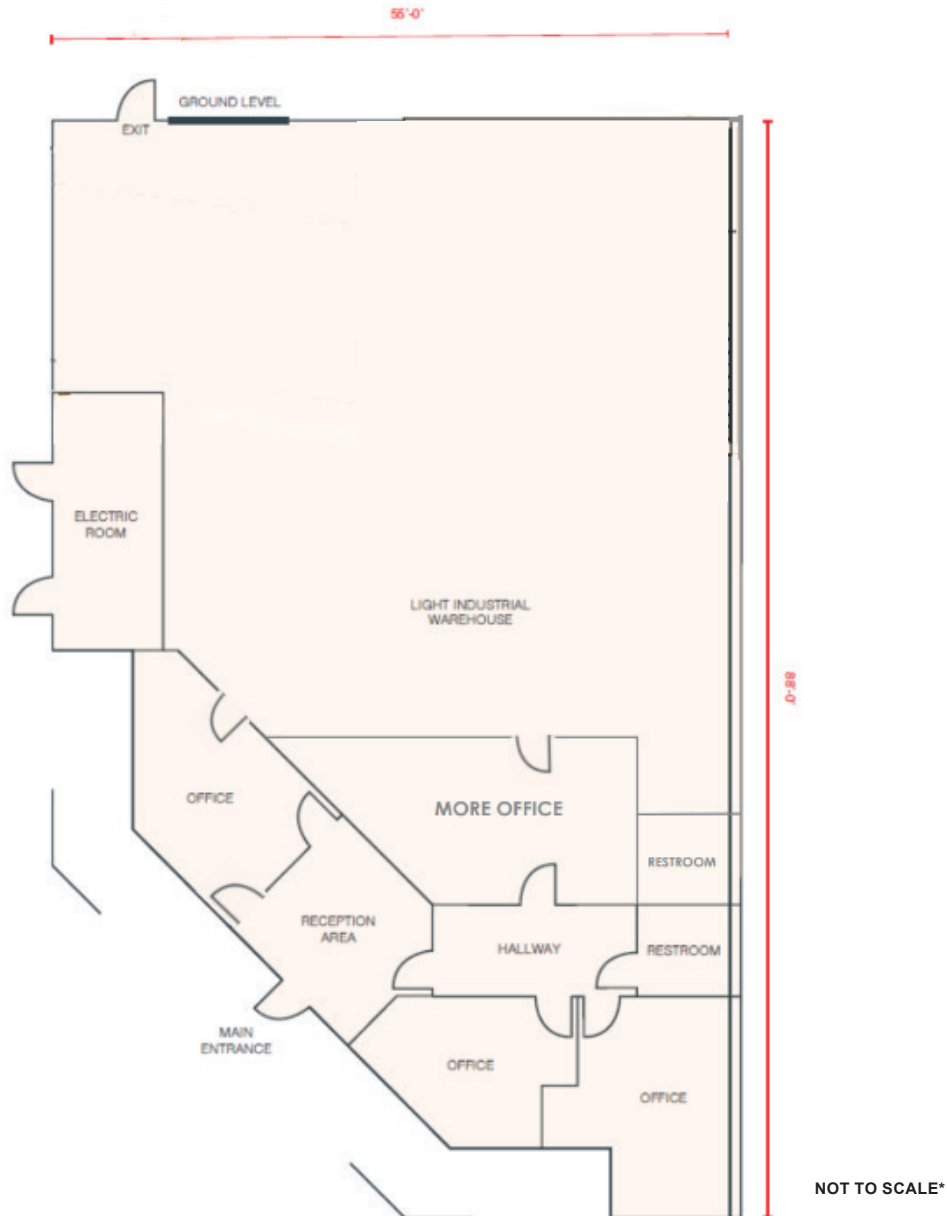

FOR MORE INFORMATION, PLEASE CONTACT:

NOAH SAMARIN

EXECUTIVE V.P. | PRINCIPAL

M: 714.812.1289

noah.samarin@daumcommercial.com

CADRE #01755814

DAVID GORES

VICE PRESIDENT

M: 909.720.9437

david.gores@daumcommercial.com

CADRE # 01502471

NICK CANTU

ASSOCIATE V.P.

M: 714.787.9454

nick.cantu@daumcommercial.com

CADRE # 02016719

COLE FIKSE

ASSOCIATE

M: 951.808.2491

cfikse@daumcommercial.com

CADRE # 02226649

Although all information is furnished regarding for sale, rental or financing from sources deemed reliable, such information has not been verified and no express representation is made nor is any to be implied as to the accuracy thereof, and it is submitted subject to errors, omissions, changes of price, rental or other conditions, prior sale, lease or financing, or withdrawal without notice. All Maps provided courtesy of Google Maps, Bing Maps, and Google Earth. D/AQ Corp. # 01129558



SGC
INDUSTRIAL
TEAM

FOR LEASE/SALE

±4,330 SF INDUSTRIAL/FLEX SPACE

800 S. ROCHESTER AVE. | UNIT A | ONTARIO, CA



FOR MORE INFORMATION, PLEASE CONTACT:

NOAH SAMARIN
EXECUTIVE V.P. | PRINCIPAL
M: 714.812.1289
noah.samarin@daumcommercial.com
CADRE #01755814

DAVID GORES
VICE PRESIDENT
M: 909.720.9437
david.gores@daumcommercial.com
CADRE # 01502471

NICK CANTU
ASSOCIATE V.P.
M: 714.787.9454
nick.cantu@daumcommercial.com
CADRE # 02016719

COLE FIKSE
ASSOCIATE
M: 951.808.2491
cifikse@daumcommercial.com
CADRE # 02226649

Although all information is furnished regarding for sale, rental or financing from sources deemed reliable, such information has not been verified and no express representation is made nor is any to be implied as to the accuracy thereof, and it is submitted subject to errors, omissions, changes of price, rental or other conditions, prior sale, lease or financing, or withdrawal without notice. All Maps provided courtesy of Google Maps, Bing Maps, and Google Earth. D/AQ Corp. # 01129558

