

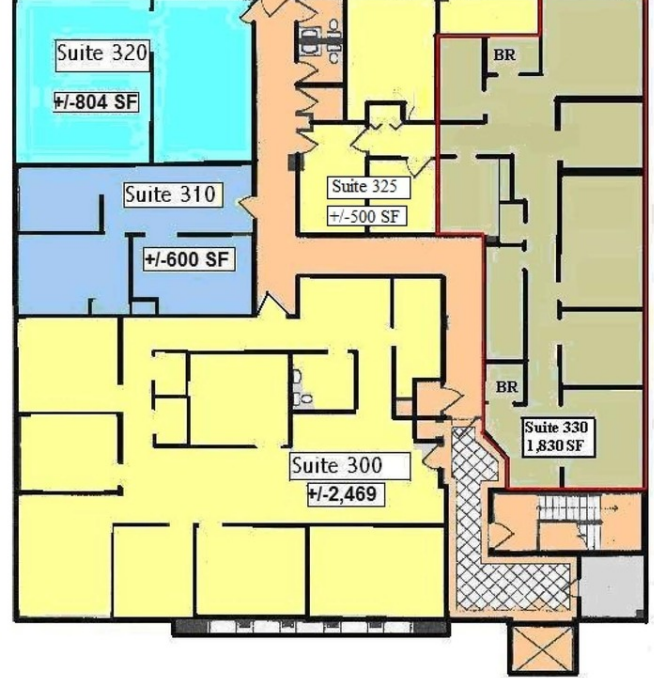

570 MEMORIAL CIRCLE

Ormond Beach, FL 32174

LEASE



OFFERING SUMMARY

Available SF:	1,830 SF
Lease Rate:	\$12.50 SF/yr (NNN)
Lot Size:	1.21 Acres
Year Built:	1984
Building Size:	23,000 SF
Zoning:	B-1
Market:	East Central Florida

CBCBENCHMARK.COM

Ed Schwarz
O: 386 672 8530 | C: 386 405 7388
eschwarz@cbcbenchmark.com

PROPERTY OVERVIEW

Exceptional professional office space available in central Ormond Beach location. 3 story multi-tenant office building. Unit 330 currently leased to attorneys office will be available December 2020. Tenant pays share of utilities. Pass-throughs @ \$3.50/SF. Lease terms negotiable. Well maintained office building with medical and other professional services in building. Shaded Green Area on Floor Plan is Unit 330. Elevator and On Site Management. Featured space includes some furniture. Close to Trails Shopping Center off Nova Road and near Granada Blvd. Minutes to I-95. First floor medical offices are also available. Call or email Ed for additional information.

PROPERTY HIGHLIGHTS

- B-1 Zoning
- Well Maintained Professional Building
- Minutes to I-95
- Professional/Clinics/Labs/Medical



**COLDWELL
BANKER
COMMERCIAL
BENCHMARK**