

±16,948 SF INDUSTRIAL BUILDING SUBLEASE



131

Brea Canyon Road | Walnut, California

NAICapital
COMMERCIAL REAL ESTATE SERVICES, WORLDWIDE

Jack Chang | Vice President

21660 Copley Dr. Ste 320, Diamond Bar, CA 91765

D: 909.348.0616 | jchang@naicapital.com



131 Brea Canyon Rd.

Walnut, CA 91789

Property Details

Property Type	Warehouse/Distribution
Building Size	16,948 SF
Office	±4,000 SF
Clear Height	18' - 22'
Power	1600A - 277/400V
Truck Loading	2
Ground Level Doors	2
Parking	31
Construction Type	CTU
Year Built	1991



Site Plan

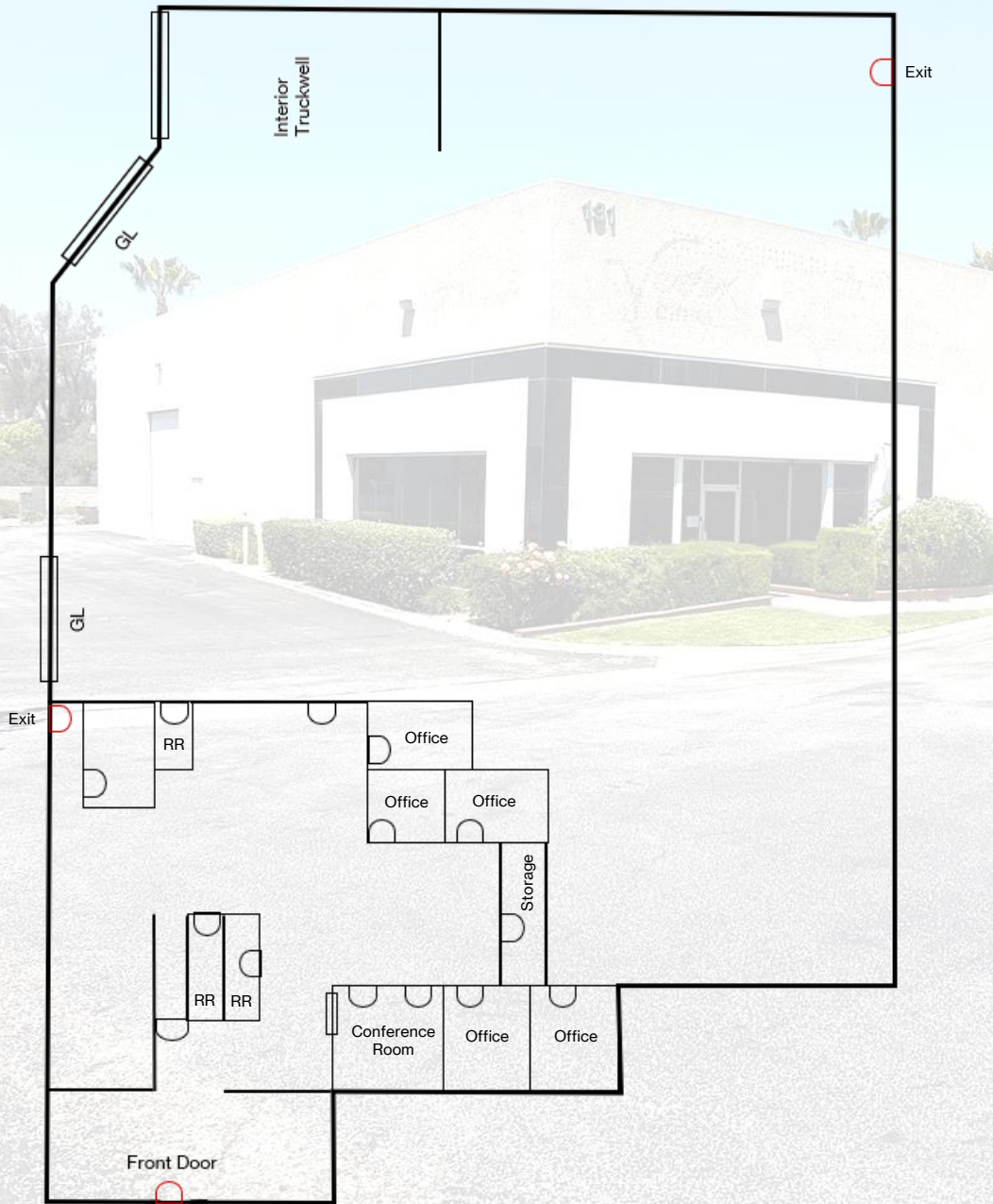

131 Brea Canyon Rd.

Walnut, CA 91789

Highlights:

- Has loading docks
- Central location from 60 & 10 Fwys
- Large yard
- Large office
- High Power



NAICapital
COMMERCIAL REAL ESTATE SERVICES, WORLDWIDE

Jack Chang | Vice President

21660 Copley Dr. Ste 320, Diamond Bar, CA 91765

D: 909.348.0616 | jchang@naicapital.com