

# OFFICE AVAILABLE FOR LEASE

300 & 314 W 15th Street, Vancouver, WA



## SPACES AVAILABLE:

**BUILDING 300** | Suite 205:  
Private Executive Office 125 SF +/-  
Lease Rate \$650 Per Month  
Minimum 1-Year Term

**BUILDING 314** | Suite 300:  
956 SF +/- Includes, 2 Private Offices,  
Open Workspace and/or Cubicles  
Lease Rate \$2,400 Per Month  
Minimum 3-Year Term

**Brandi M. Ho, Broker**  
360.823.5112 [Brandi@MAJCRE.com](mailto:Brandi@MAJCRE.com)

## MAJ COMMERCIAL REAL ESTATE

300 W 15th Street, Ste 200, Vancouver WA  
Office: 360.699.4494 | [www.MAJCRE.com](http://www.MAJCRE.com)

## BUILDING AMENITIES:

- Class A, Professional Office Building
- Located Downtown Vancouver, Just Two Blocks from New Seasons
- Use of 2nd & 3rd Floor Conference Rooms (subject to scheduling/availability)
- Janitorial Service, 2 Days a Week
- Shared Common Area Kitchen/s
- Secured Building, Convenient Key Fob Access Provided For After Hours
- Elevator Served
- Common Area Restrooms
- Garage/Covered Guest Parking

# OFFICE AVAILABLE FOR LEASE

Building 300, 2nd Floor, Suite 205



# Building 314, 2nd Floor, Suite 300

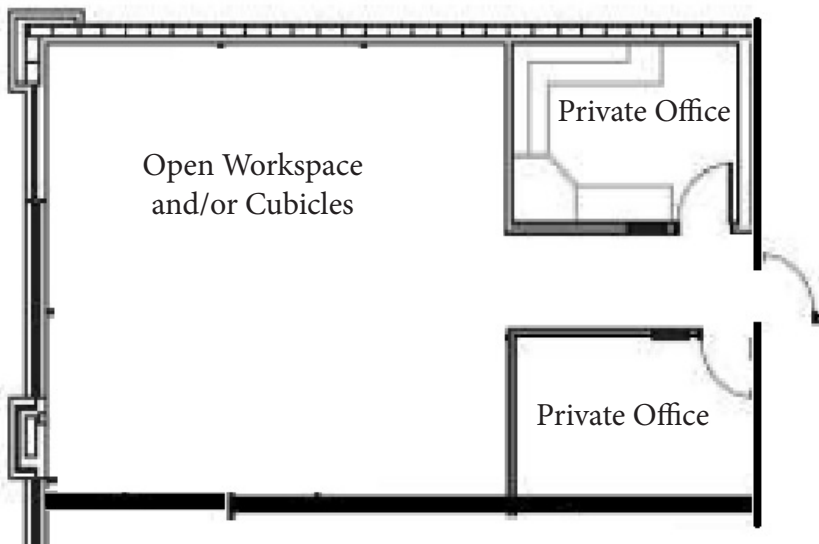

**Brandi M. Ho, Broker**

360.823.5112 Brandi@MAJCRE.com

**MAJ COMMERCIAL REAL ESTATE**

300 W 15th Street, Ste 200, Vancouver WA

Office: 360.699.4494 | www.MAJCRE.com