

MISSION PACIFIC CENTER

1450 W Mission Rd., San Marcos, CA 92069

**CORNER RETAIL
SPACE AVAILABLE**

**RETAIL SPACE ±1,350 - ±1,500 SF
AVAILABLE**

MISSION PACIFIC CENTER

1450 W Mission Rd.
San Marcos, CA 92069

- Neighborhood strip retail center
- Mix of residential and daytime employment population
- Near Palomar College (21,141 students)
- Located at the signalized corner of W. Mission Rd. (±14,00 ADT) & N. Pacific St.
- Corner location available
- 60 parking spaces
- Please do not disturb tenants

±1,350 SF - ±1,500 SF AVAILABLE

TENANTS

SORRENTO'S
PIZZA

AAA
ELITE SPA

SWAN
NAILS & SPA

SUE THAI OM



COMPETITION AERIAL



AT THE Valley of Discovery, San Marcos

WALK
SCORE
71

Very Walkable
Most errands can be accomplished on foot.

TRANSIT
SCORE
66

Good Transit
Many nearby public transportation options.

BIKE
SCORE
51

Bikeable
Some bike infrastructure.

*walkscore.com





POPULATION

1 mile	15,708
3 miles	93,137
5 miles	206,114



DAYTIME POPULATION

1 mile	15,003
3 miles	80,929
5 miles	160,783



AVERAGE HOUSEHOLD INCOME

1 mile	\$112,242
3 miles	\$129,522
5 miles	\$150,201

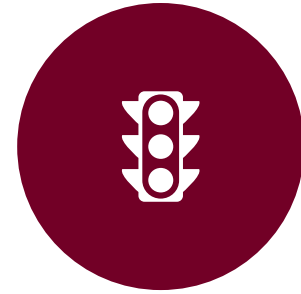

TRAFFIC COUNTS

W Mission Rd.
14,219 ADT

N Las Posas Rd.
22,024 ADT

FLOURISHING FAMILIES

Flourishing couples and multi-generational families living a wide range of lifestyles in suburbia.
13.9% of population

FAMILY UNION

Conventional Gen X families living suburban and city lifestyles.
12.9% of population

BOOMING WITH CONFIDENCE

Mature and upscale couples living in suburban homes.
11.9% of population

AREA DEMOGRAPHICS



SITE PLAN

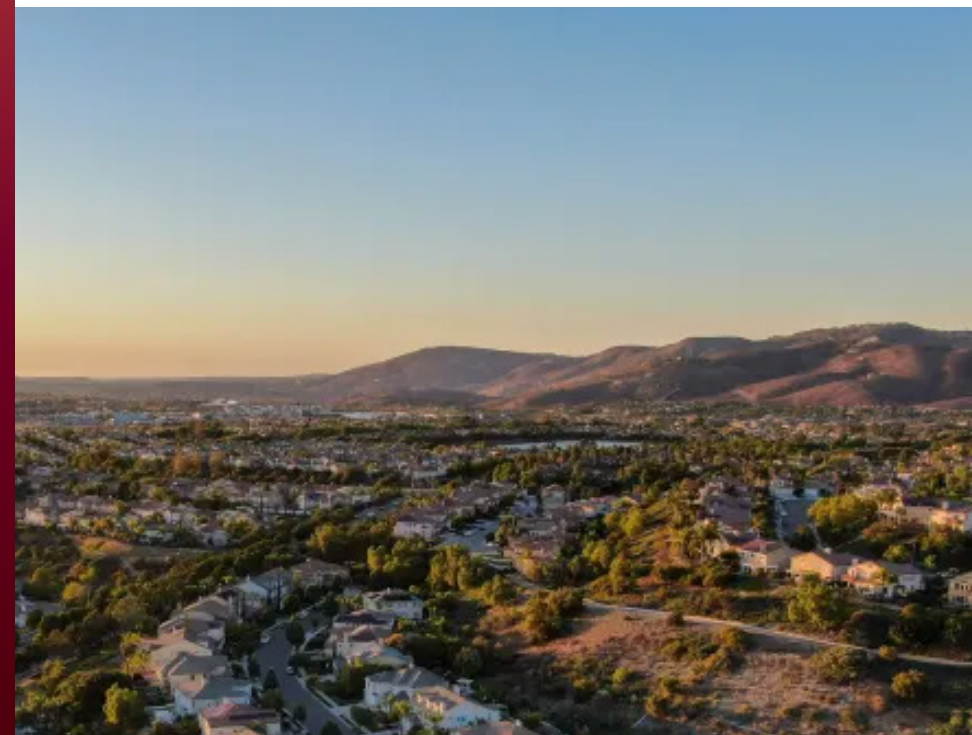
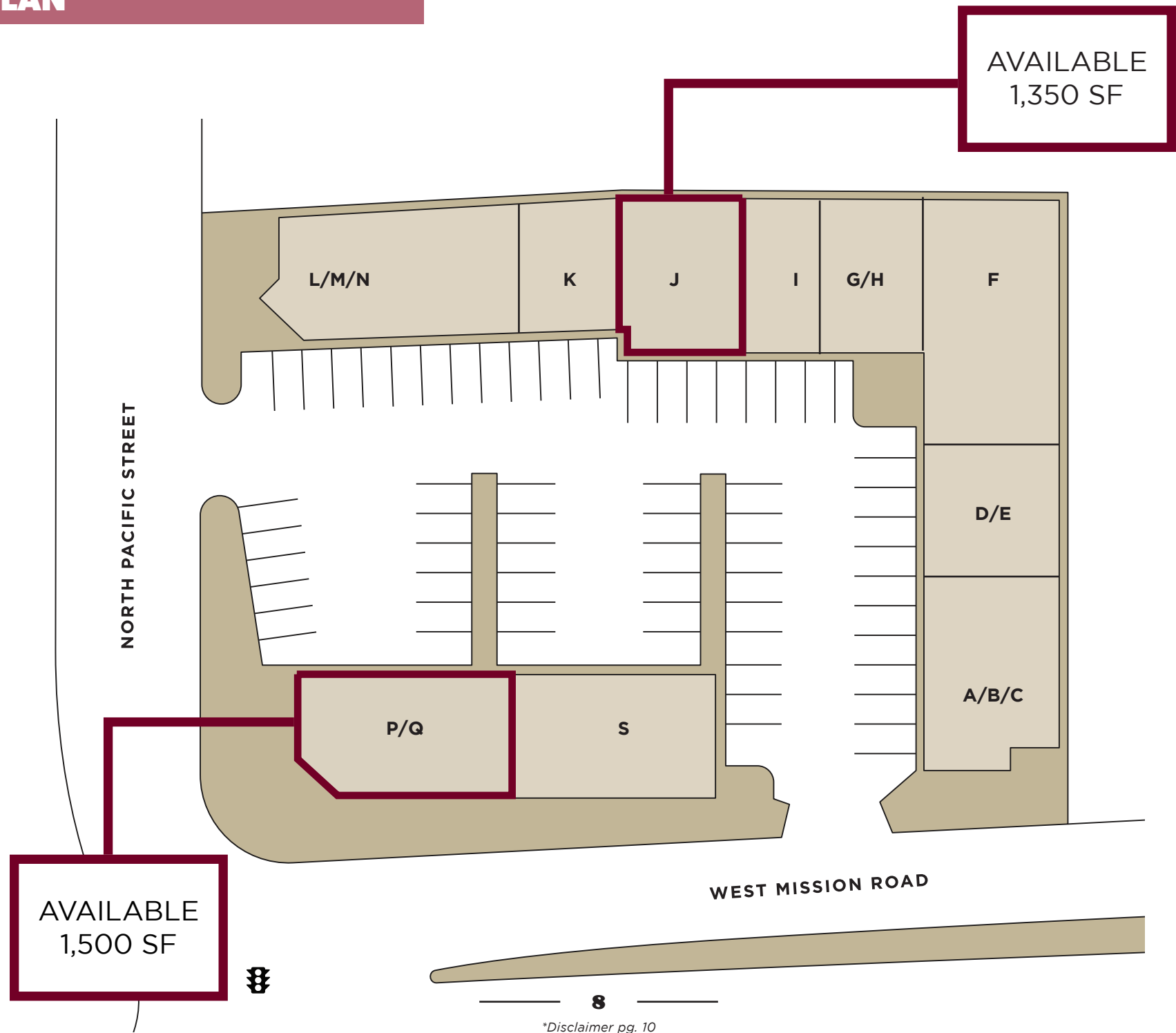

*DISCLAIMER

*All information regarding this property is deemed to be reliable, however, no representation, guarantee or warranty is made to the accuracy thereof and is submitted subject to errors, omissions, change of price or withdrawal without notice.

*Figures and statements appearing on this form represent our best knowledge and belief based on information gathered regarding the above property. This analysis is to be taken, therefore, as an estimate and not as a guarantee or warranty. Information contained herein is subject to independent verification and no liability for errors or omissions is assumed. You should rely on your own independent analysis and investigation regarding the above property and on the advice of your legal counsel and tax consultant.

*Any site plans and maps contained herein is not a representation, warranty or guarantee as to size, location, or identity of any tenant, and the improvements are subject to such changes, additions, and deletions as the architect, landlord, or any governmental agency may direct.

*Demographics contained herein are produced using private and government sources deemed to be reliable. The information herein is provided without representation or warranty. Additional information available upon request.

*Any geofencing data herein is provided by Placer Labs, Inc. (www.placer.ai) and is provided without representation or warranty.

*Photos contained herein are property of their respective owners. Use of these photos without the express written consent of the owner is prohibited. Photos do not guarantee the current condition of the property.



MISSION PACIFIC CENTER

1450 W Mission Rd., San Marcos, CA 92069

FOR LEASING INFORMATION

LUKE NGUYEN

858.633.1810

lnguyen@flockeavoyer.com

CA DRE No.: 02050070

**FLOCKE &
AVOYER**
Commercial Real Estate