



DOMAIN

DRIVE

EXETER, NEW HAMPSHIRE



Class A Office/Flex/R&D Space
Available For Lease

NEWMARK

Building Specifications

Building Size

First Floor:	198,575 SF
Second Floor:	64,911 SF
Total	263,486 SF
Lot Size	33 Acres
Parking:	924 spaces at 100 Domain with the ability to add 150 additional spaces. 130 spaces at 200 Domain via easement.
Elevators:	1 Beckwith hydraulic elevator with 4,000-lbs capacity 1 handicapped lift
Loading:	9 loading docks (3 for common usage)
Roof:	Fully adhered EPDM, 2011
Construction:	Steel frame with masonry brick exterior
Foundation:	5" slab on grade
Year Built/Renovated:	1984/2012
Zoning:	Industrial
Column Spacing:	25'25'
Finished Ceiling Height:	9-12' in office, 24' clear in warehouse

Power:	Public Service Company of New Hampshire 4,000 Amps @ 480/277 Volts Total
Emergency Power:	One (1) 45 kW generator for life safety
Natural Gas:	Unitil
Fire Protection:	Wet System. 2000 gpm, 100 psi via on-site detention pond Simplex fire alarm system
Telecommunications:	Bayring, FairPoint Communications, Fiber and Copper
Bathrooms:	5 bathroom cores; 1 shower core
HVAC:	20 rooftop mounted units, gas-fired for heating. Combination CAV and VAV Systems
Amenities:	Café, fitness center, yoga room and showers

Floor Plans

First Floor

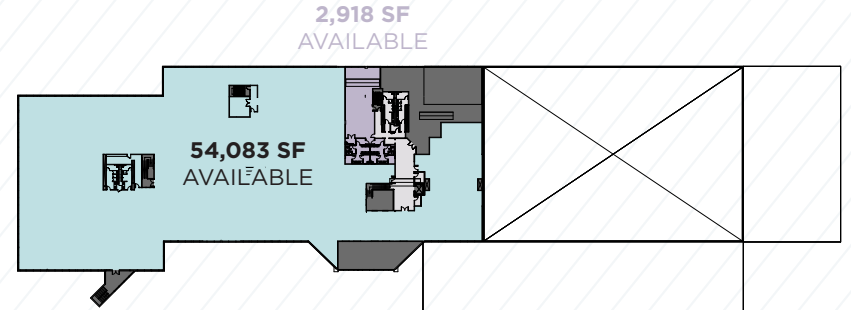
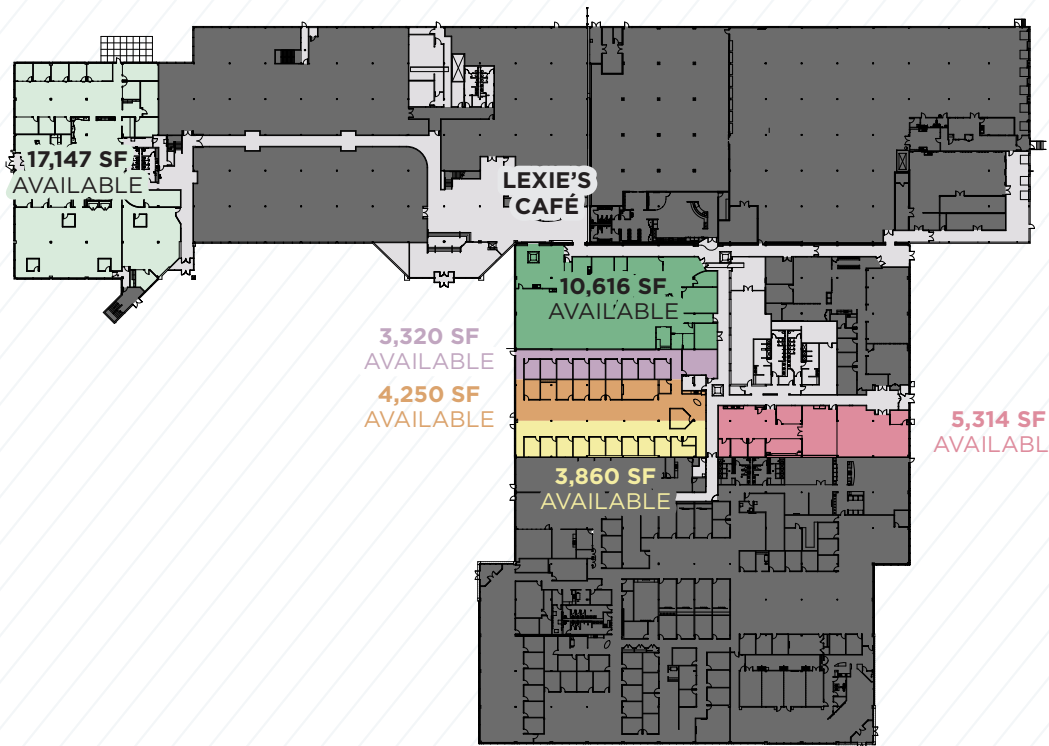

Second Floor Existing Conditions

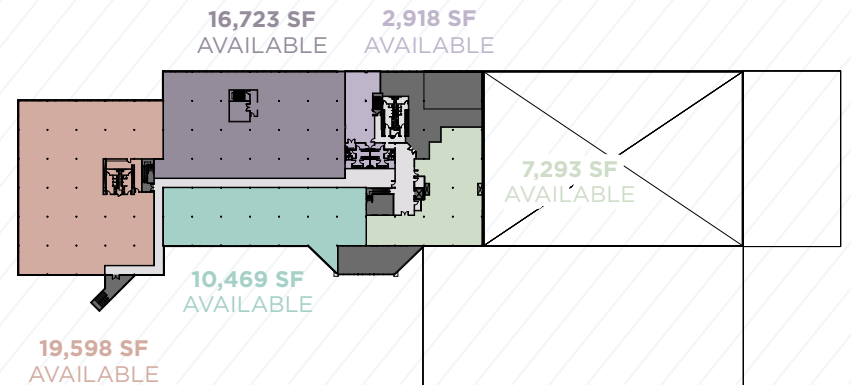

Second Floor Subdivision Plan

New Lobby



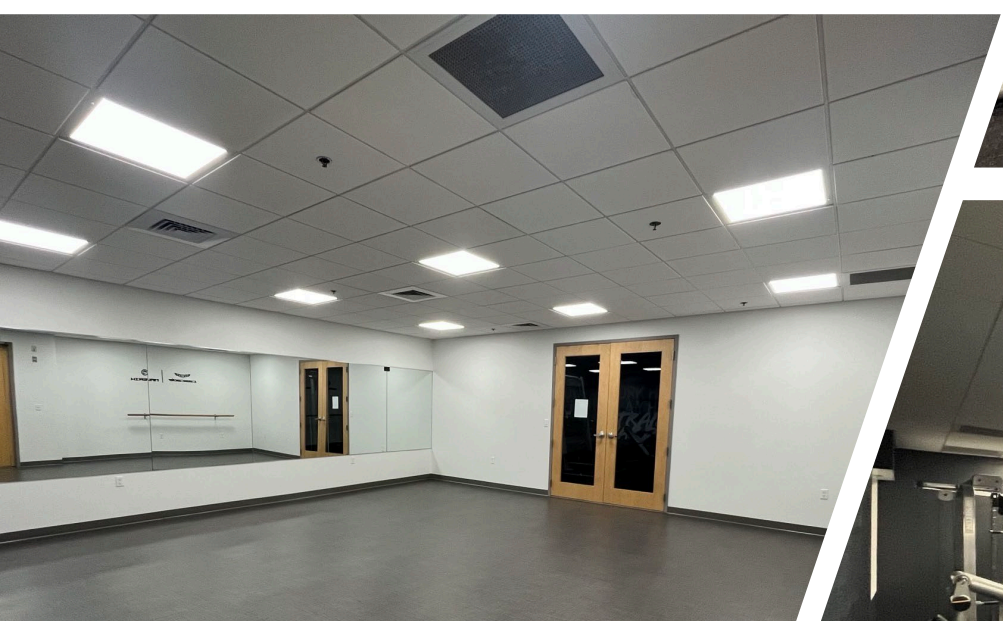

Fitness Center



Entrance / Break Rooms



Office Space



1/2 MILE FROM ROUTE 111

Starbucks COFFEE, McDonalds, [Dog Logo]

MARKET BASKET, Jersey Mike's SUBS

shaws Supermarkets

DUNKIN', THIRSTY MOOSE

110 Grill, FAIRFIELD INN Marriott, Hampton Inn

CORPORATE NEIGHBORS

Itac-nix

Timberland, ups

KITTERY
20 MINS

PORTSMOUTH
15 MINS

MANCHESTER
30 MINS

100 DOMAIN DRIVE

HAMPTON
7 MINS

BOSTON
50 MINS

100 DOMAIN DRIVE

THE HOME DEPOT, Smuttynose BREWING CO.

DUNKIN', Marshalls

SUBWAY, CVS

shaws Supermarkets

FOR MORE INFORMATION, PLEASE CONTACT:

J.R. McDonald
jr.mcdonald@nmrk.com
617.863.8502

Tyler McGrail
tyler.mcgrail@nmrk.com
617.863.8511

NEWMARK