



## AVAILABLE SPACES

**Ground Floor** ±50,000 USF

## LOCATION HIGHLIGHTS

- Proximity to LIE; Seaford/Oyster Bay Expressway and Northern State Parkway; Bethpage Long Island Railroad and NICE bus stops; 30 mins to all major airports
- Located on 1.2 Million SF campus with 24/7 access and gated security

## SPACE DETAILS

- Fully renovated
- On-Site Cafe
- Parking Ratio - 5:1
- Large parking lot in campus

Lease Rate: Upon request

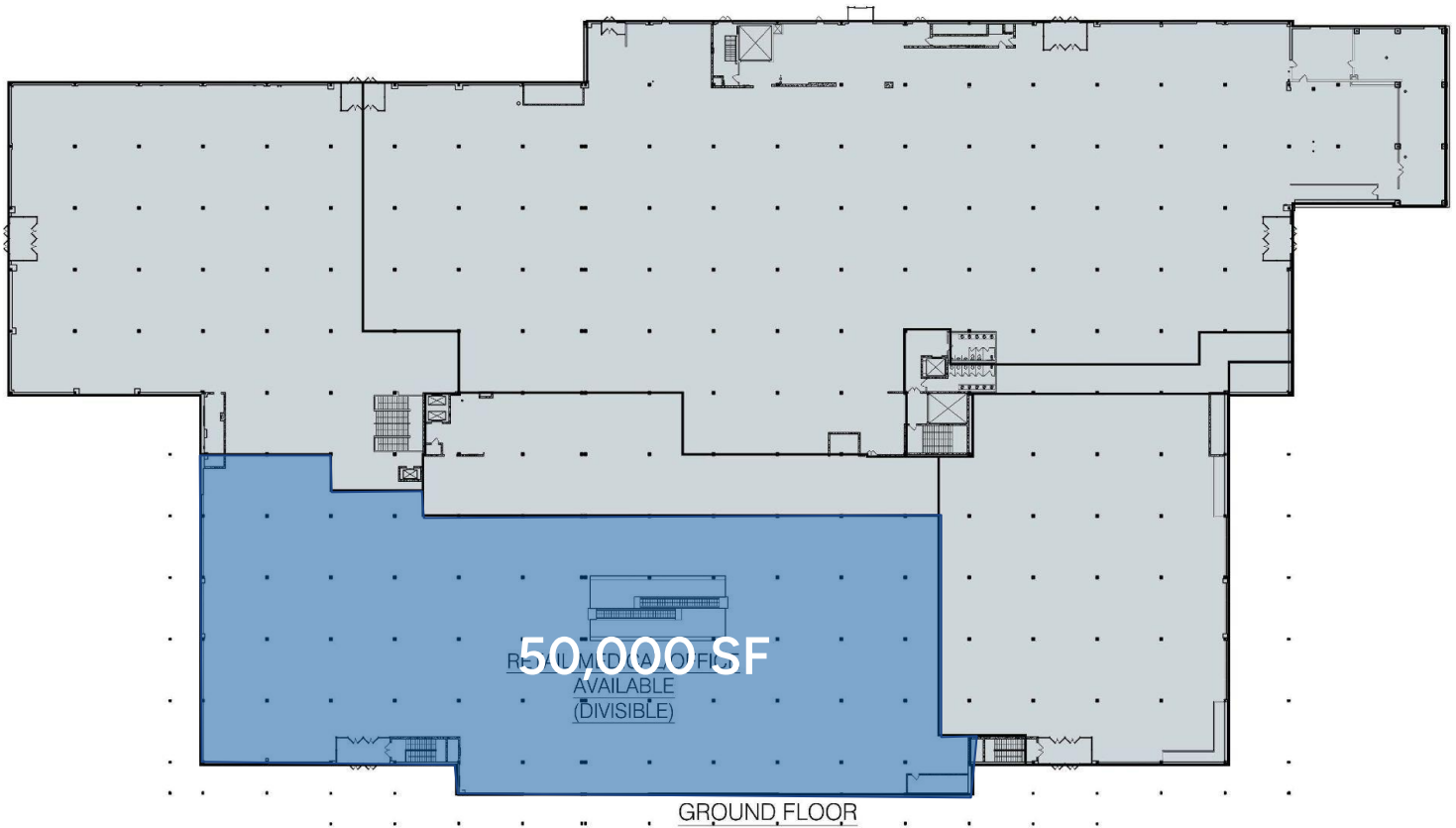

---

NORTH  
BROADWAY

---



The information contained herein has either been provided by publicly available data or obtained from sources that we deem reliable. The information is subject to errors, omissions, modifications, and to any listing condition not otherwise provided. We have no reason to doubt the accuracy of the details herein but provide no guarantee to its reliability. All zoning, measurements, allowable uses and all other information herein must be independently verified.

STEEL EQUITIES  
999 S. OYSTER BAY ROAD  
SUITE 200  
BETHPAGE, NY 11714

**Jason Miller**  
516.662.2210 Cell  
516.465.0009 Office  
[jmiller@steequities.com](mailto:jmiller@steequities.com)

**Christian Mazzie**  
631.559.7838 Cell  
516.465.0077 Office  
[cmazzie@steequities.com](mailto:cmazzie@steequities.com)