

FOR LEASE SOLANO BUSINESS PARK  
SUITES C, F and H - 17,563 (TAKE ALL OR PART)

2333 Courage Drive, Fairfield, CA

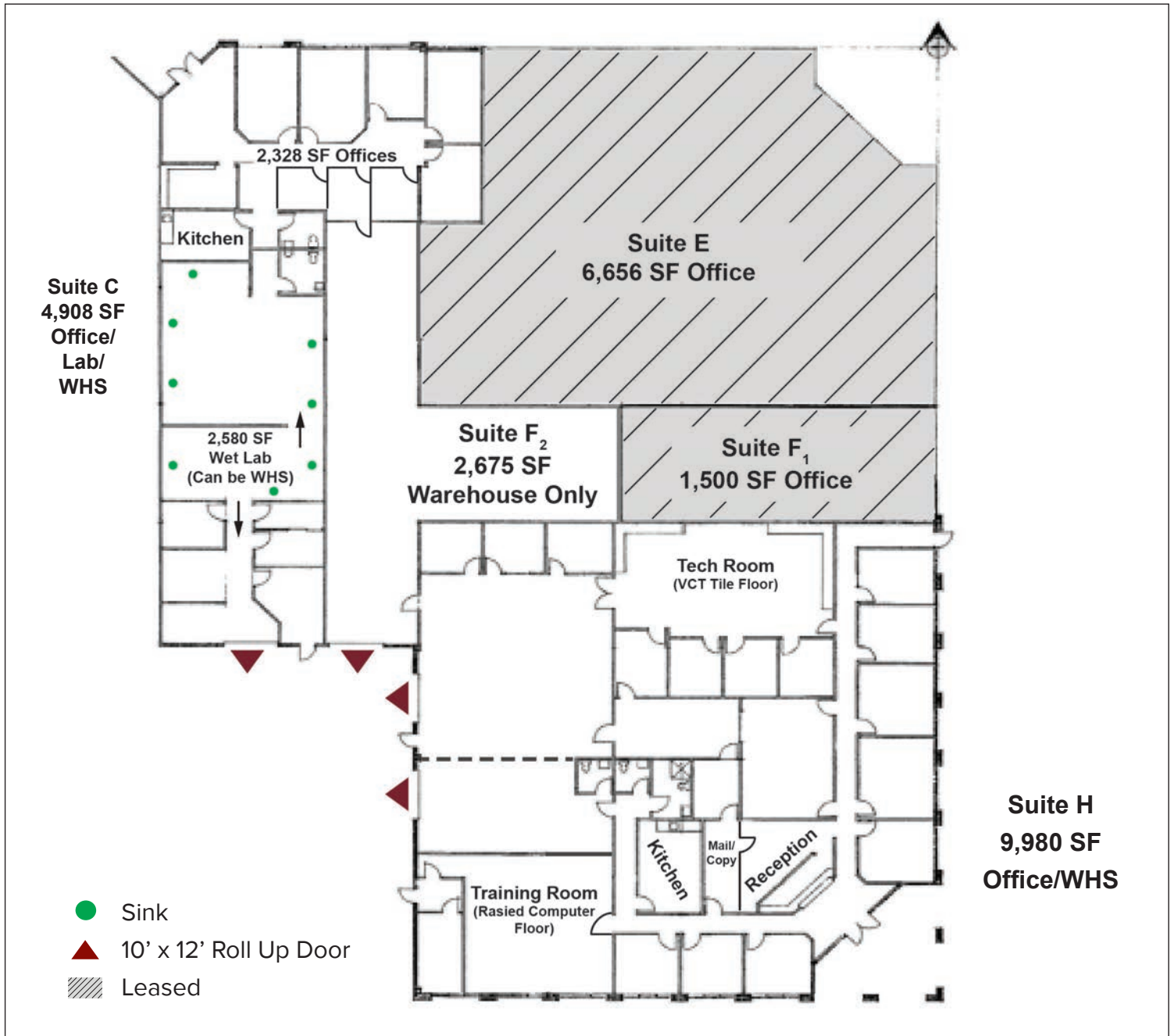

**Suite C:** ± 4,908 SF of finished office and highly improved wet lab. (Lab can be returned to warehouse)

**Suite F:** ± 2,675 SF of warehouse space.

**Suite H:** ± 9,980 SF of combination finished office and warehouse space.

**TOTAL: ± 17,563 SF**

**CHRIS PETRINI**

CA License No. 01020505  
chris@petrinicommercial.com  
Cell +1 510.507.8665

**PETRINI COMMERCIAL**

2333 Courage Drive, Suite H  
Fairfield, CA 94534  
www.petrinicommercial.com