

COMMERCIAL SPACE  
FOR LEASE



# ORCHARD MARKETPLACE

Market Center Way, Daleville, VA 24083



## DEVELOPMENT CORRIDOR

\$250 million in economic development projects since 2016 with over 1,500 housing units added to the development pipeline.



## GROCERY ANCHORED CENTER

New construction located on outparcels at Food Lion-anchored Orchard Marketplace



## AFFLUENT DEMOGRAPHICS

1-mile average household income is \$133,880



## BUSY COMMERCIAL ARTERIAL

Direct access and visibility from Roanoke Road (US 220) with over 27,000 AADT



## ATTRACTIVE CO-TENANTS

Join Food Lion, CVS, Dunkin' Donuts, Jersey Mike's, Ivy Rehab, Dairy Queen, Dominoes, YMCA, Hampton Inn, Carilion Clinic, and Lewis Gale Physicians

## HIGH QUALITY NEW CONSTRUCTION BUILDING

Join Dunkin' Donuts, Ivy Rehab, & Jersey Mike's





**1,300+ SF END CAP AVAILABLE**  
Premium Retail Space

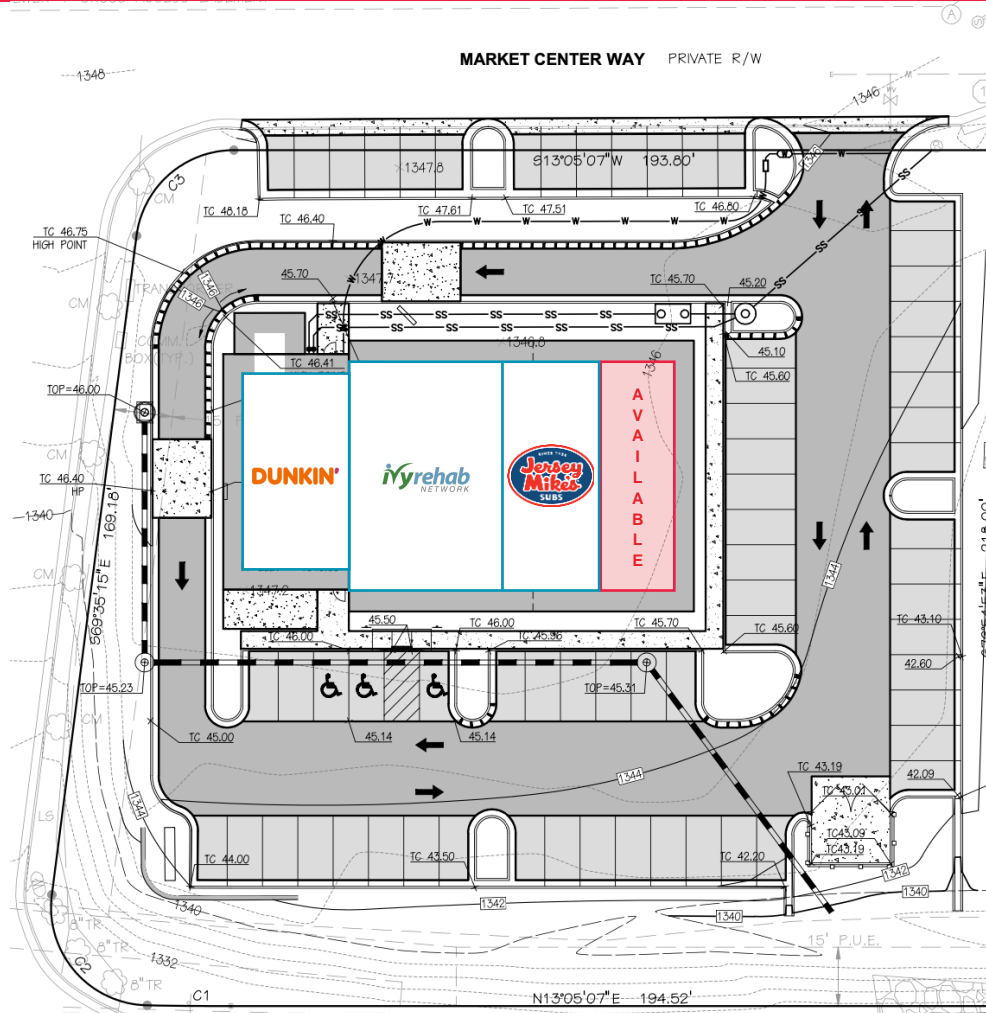

# TRACT B

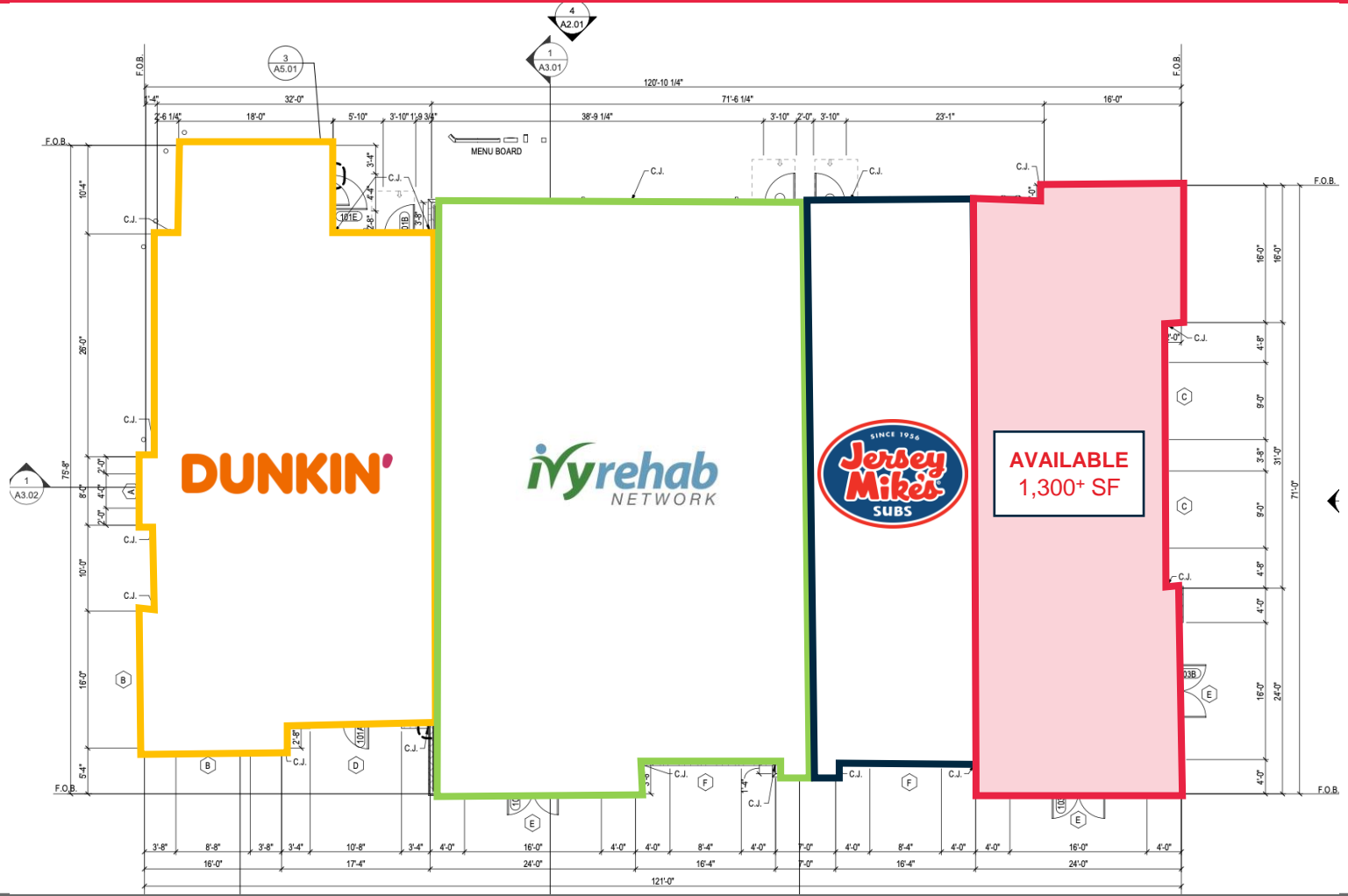

# TRACT D



Daleville town center

Bank of Botetourt

DQ

ROBES & GUNDS

Hampton  
by HILTON

Member One

Myrehab  
NETWORK

ROAD RUNNER  
EXPRESS

DUNKIN'

Jersey Mike's  
SANDWICHES

CVS  
pharmacy

DONICELLI  
MEATS & CHEESE

FOOD LION

CARLION

Domino's  
Pizzeria

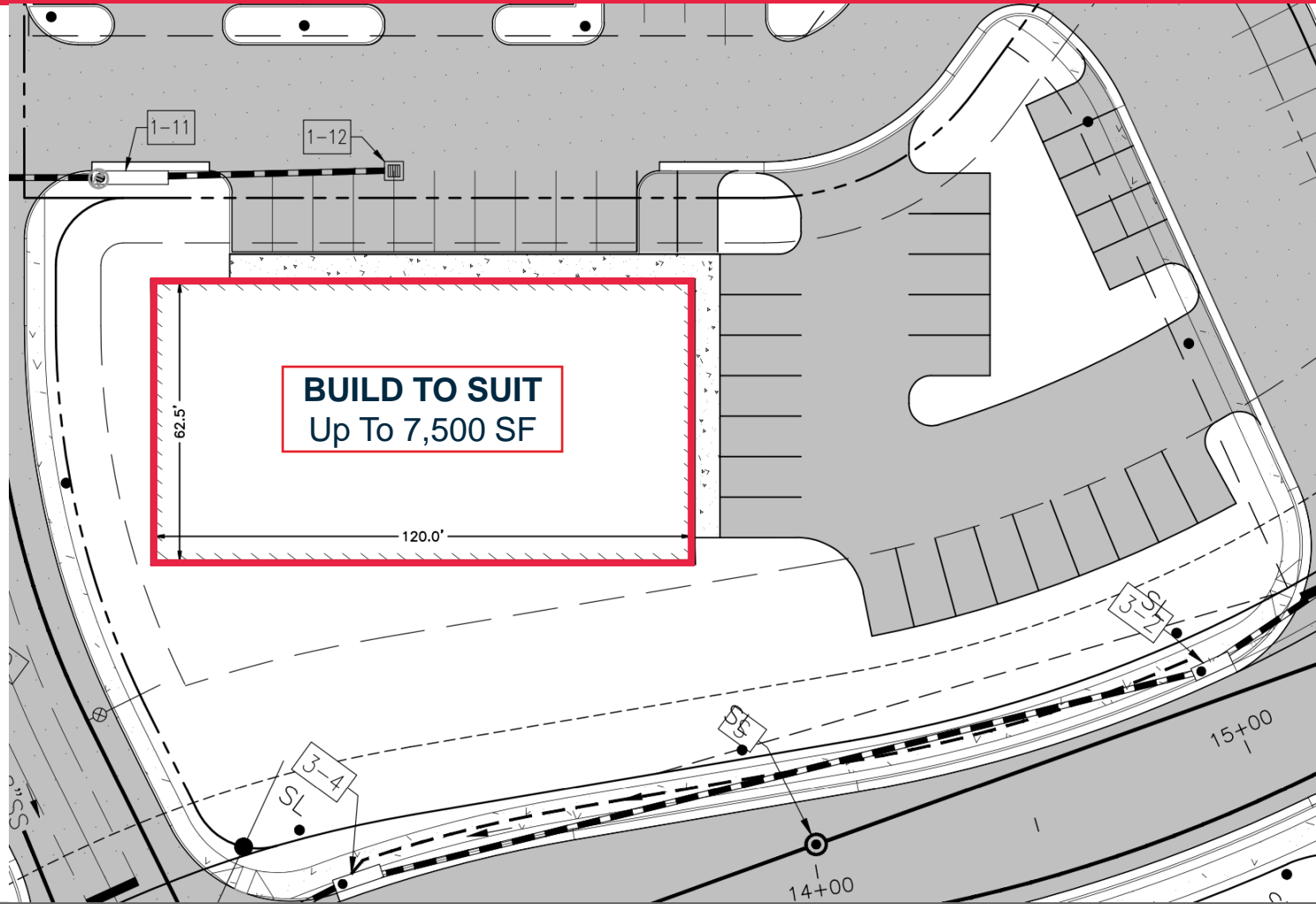



# SITE OVERVIEW



Daleville Town Center Apts.  
(215 Units)



Fieldstone Place (376 Units)

Roanoke Rd - US 220 (27,000 AADT)



# RETAIL MAP





METALSA



## SINCE 2016...

- **+/- \$250 million** in capital projects completed through 10 economic development initiatives, including 4 new companies and 6 expansions.
- **1,197** new full-time jobs have been announced.
- **10.5%** growth in manufacturing jobs.
- **11.6%** growth in manufacturing wages (avg. \$58,330 in 2021).
- **3.48%** growth private sector jobs.
- **17.8%** growth in private sector wages (avg. \$47,597 in 2021)



- A** **Fieldstone Place**  
288 Multifamily Units, 376 Total
- B** **The Preserve at Ashley**  
80 SFH
- C** **Roanoke Road Apartments**  
240 MF Units
- D** **Daleville Town Center Apts.**  
215 MF Units
- E** **The Reserve at Daleville**  
255 MF Units, 188 Built
- F** **Harvest at Blue Ridge**  
152 SFH, 123 SFA, 162 MF Units

Over 1,500 housing units have entered the development pipeline in Daleville since 2017, including 500+ single family homes and over 1,000 apartment units.





**17,729**

5 MILE 2023 POPULATION



**6,989**

5 MILE 2023 HOUSEHOLDS



**\$133,880**

1 MILE AVERAGE HH INCOME



**16,575**

5 MILE DAYTIME POPULATION

## KEY DEMOGRAPHICS

	1 Mile	3 Mile	5 Mile
2023 Estimated Total Population	2,096	7,171	17,729
2028 Projected Population	2,216	7,431	17,987
2023 Households	882	2,927	6,989
2023 Average Household Income	\$133,880	\$121,156	\$114,473
2023 Median Household Income	\$99,728	\$91,156	\$83,813
2023 Median Age	54.4	50.9	47.9
2023 Daytime Population	1,908	7,110	16,575

# CONTACT



**Clay Taylor**  
Senior Vice President  
804 819 9948  
[clay.taylor@thalhimer.com](mailto:clay.taylor@thalhimer.com)

**Wyatt Poats**  
Senior Associate  
540 767 3008  
[wyatt.poats@thalhimer.com](mailto:wyatt.poats@thalhimer.com)

*Independently Owned and Operated / A Member of the Cushman & Wakefield Alliance*

*Cushman Wakefield | Thalhimer ©2023. No warranty or representation, express or implied, is made to the accuracy or completeness of the information contained herein, and same is submitted subject to errors, omissions, change of price, rental or other conditions, withdrawal without notice, and to any special listing conditions, imposed by the property owner(s). As applicable, we make no representation as to the condition of the property (or properties) in question.*