

3001

IRWIN ROAD | MOUNT LAUREL, NJ



**IMMEDIATE HIGHWAY
ACCESS WITH MANY
AMENITIES NEARBY**



For More Information

JONATHAN KLEAR
+1 856 234 9600 ext 210
jonathan.klear@naimertz.com



NAI MERTZ DISCLAIMER: NO WARRANTY OR REPRESENTATION, EXPRESS OR IMPLIED, IS MADE AS TO THE ACCURACY OF THE INFORMATION CONTAINED HEREIN, AND THE SAME IS SUBMITTED SUBJECT TO ERRORS, OMISSIONS, CHANGE OF PRICE, RENTAL OR OTHER CONDITIONS, PRIOR SALE, LEASE OR FINANCING, OR WITHDRAWAL WITHOUT NOTICE, AND OF ANY SPECIAL LISTING CONDITIONS IMPOSED BY OUR PRINCIPALS NO WARRANTIES OR REPRESENTATIONS ARE MADE AS TO THE CONDITION OF THE PROPERTY OR ANY HAZARDS CONTAINED THEREIN ARE ANY TO BE IMPLIED. OUTLINES ARE APPROXIMATE AND SHOWN ONLY TO IDENTIFY THE PARCEL IN CONSIDERATION.

Availability	Two contiguous units 49,295 SF total Unit A: 24,628 SF Unit B: 24,667 SF
Ceiling Height	18'6"-19'8" clear
Sprinkler	100% wet system
Power	Up to 800 amps
Lighting	New LED lighting throughout
Zoning	I - Industry
Parking	Abundant parking available
HVAC	Gas heat in warehouse, S/S heat pumps in office
Location	1.0 mile to I-295 (Exit 40) 5.2 mi to NJ Turnpike (Exit 4) 11 miles to Philadelphia

FLOORPLAN

3001 IRWIN ROAD || MOUNT LAUREL, NJ

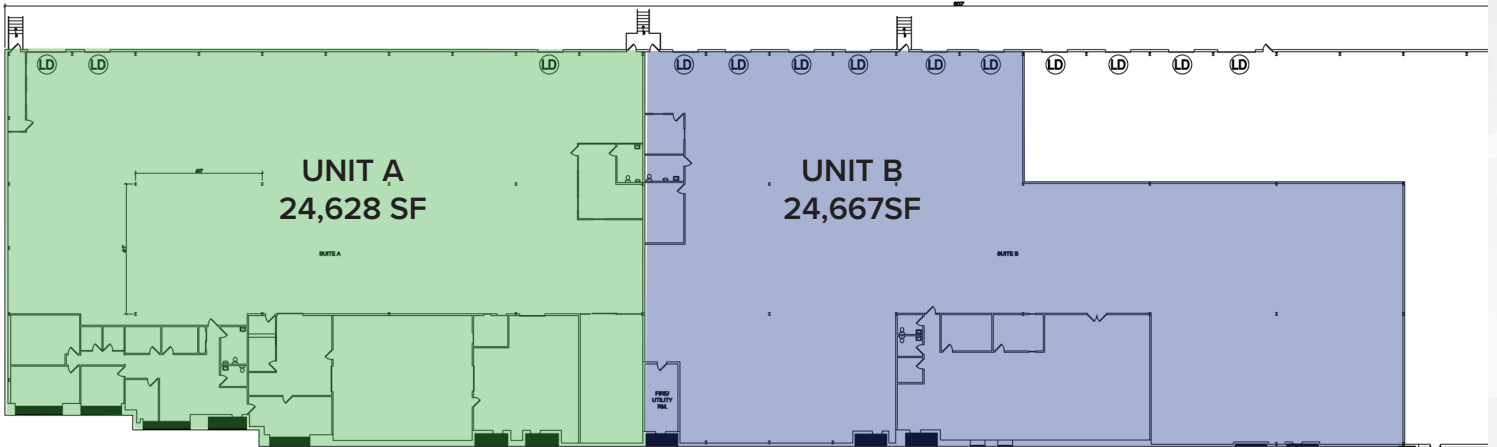

Loading: 2 tailgates, 1 drive-in door

Office Area: 2,111± SF. Includes bullpen area, IT room, 4 private offices, conference room, mens & womens restrooms

Other: Warehouse break room

Loading: 5 tailgates with levelers, 1 ramped drive-in

Office Area: 3,400± SF. 1 large conference room, 2 office restrooms

Other: Warehouse break room and 2 warehouse restrooms

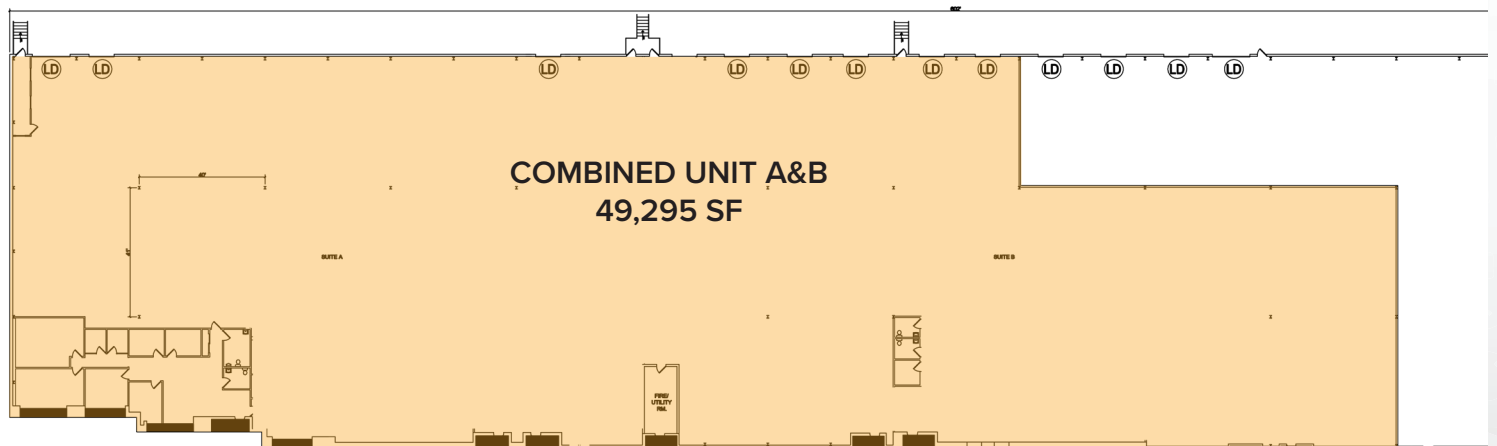

For More Information

JONATHAN KLEAR
+1 856 234 9600 ext 210
jonathan.klear@naimertz.com



NAI MERTZ DISCLAIMER: NO WARRANTY OR REPRESENTATION, EXPRESS OR IMPLIED, IS MADE AS TO THE ACCURACY OF THE INFORMATION CONTAINED HEREIN, AND THE SAME IS SUBMITTED SUBJECT TO ERRORS, OMISSIONS, CHANGE OF PRICE, RENTAL OR OTHER CONDITIONS, PRIOR SALE, LEASE OR FINANCING, OR WITHDRAWAL WITHOUT NOTICE, AND OF ANY SPECIAL LISTING CONDITIONS IMPOSED BY OUR PRINCIPALS NO WARRANTIES OR REPRESENTATIONS ARE MADE AS TO THE CONDITION OF THE PROPERTY OR ANY HAZARDS CONTAINED THEREIN ARE ANY TO BE IMPLIED. OUTLINES ARE APPROXIMATE AND SHOWN ONLY TO IDENTIFY THE PARCEL IN CONSIDERATION.

ADDITIONAL IMAGES

3001 IRWIN ROAD || MOUNT LAUREL, NJ



For More Information

JONATHAN KLEAR

+1 856 234 9600 ext 210

jonathan.klear@naimertz.com



Faropoint

NAI MERTZ DISCLAIMER: NO WARRANTY OR REPRESENTATION, EXPRESS OR IMPLIED, IS MADE AS TO THE ACCURACY OF THE INFORMATION CONTAINED HEREIN, AND THE SAME IS SUBMITTED SUBJECT TO ERRORS, OMISSIONS, CHANGE OF PRICE, RENTAL OR OTHER CONDITIONS, PRIOR SALE, LEASE OR FINANCING, OR WITHDRAWAL WITHOUT NOTICE, AND OF ANY SPECIAL LISTING CONDITIONS IMPOSED BY OUR PRINCIPALS NO WARRANTIES OR REPRESENTATIONS ARE MADE AS TO THE CONDITION OF THE PROPERTY OR ANY HAZARDS CONTAINED THEREIN ARE ANY TO BE IMPLIED. OUTLINES ARE APPROXIMATE AND SHOWN ONLY TO IDENTIFY THE PARCEL IN CONSIDERATION.

LOCATION INFORMATION

3001 IRWIN ROAD || MOUNT LAUREL, NJ



Faropoint



Distance to:

Route 38	0.5 mi
I-295 (Exit 40)	1.0 mi
Route 73	5.0 mi
NJ Turnpike (Exit 4)	5.2 mi
Philadelphia (via Ben Franklin Bridge)	11.2 mi
Delaware	40 mi
New York	80 mi



For More Information

JONATHAN KLEAR

+1 856 234 9600 ext 210

jonathan.klear@naimertz.com

NAIMertz

NAI MERTZ DISCLAIMER: NO WARRANTY OR REPRESENTATION, EXPRESS OR IMPLIED, IS MADE AS TO THE ACCURACY OF THE INFORMATION CONTAINED HEREIN, AND THE SAME IS SUBMITTED SUBJECT TO ERRORS, OMISSIONS, CHANGE OF PRICE, RENTAL OR OTHER CONDITIONS, PRIOR SALE, LEASE OR FINANCING, OR WITHDRAWAL WITHOUT NOTICE, AND OF ANY SPECIAL LISTING CONDITIONS IMPOSED BY OUR PRINCIPALS NO WARRANTIES OR REPRESENTATIONS ARE MADE AS TO THE CONDITION OF THE PROPERTY OR ANY HAZARDS CONTAINED THEREIN ARE ANY TO BE IMPLIED. OUTLINES ARE APPROXIMATE AND SHOWN ONLY TO IDENTIFY THE PARCEL IN CONSIDERATION.