

# Stayton Industrial Park



873 WILLAMETTE AVE, STAYTON, OR 97383

INDUSTRIAL BUILDING





# Property Summary

Stand-alone 18,000 SF sprinklered warehouse in Stayton.

The property includes a small office, a restroom, and on-site parking.

Built in 1990, this warehouse is ideal for an owner-occupant but can also be configured for dual occupancy. Perfect for storage, contractors, or light manufacturing. Features include ample power and 24-foot ceiling height.

Contact the listing broker to schedule a tour!

---

|          |                                       |
|----------|---------------------------------------|
| Address: | 873 Willamette Ave, Stayton, OR 97383 |
|----------|---------------------------------------|

---

|                |           |
|----------------|-----------|
| Building Size: | 18,000 SF |
|----------------|-----------|

---

|           |           |
|-----------|-----------|
| Lot Size: | 0.92 Acre |
|-----------|-----------|

---

|             |      |
|-------------|------|
| Year Built: | 1990 |
|-------------|------|

---

|         |                       |
|---------|-----------------------|
| Zoning: | IL - Light Industrial |
|---------|-----------------------|

---

|           |        |
|-----------|--------|
| Tax Acct: | 104574 |
|-----------|--------|

---

|          |                        |
|----------|------------------------|
| Pricing: | <del>\$2,400,000</del> |
|----------|------------------------|

---

|                       |                    |
|-----------------------|--------------------|
| <b>PRICE REDUCED!</b> | <b>\$1,750,000</b> |
|-----------------------|--------------------|

---

# Building Plan

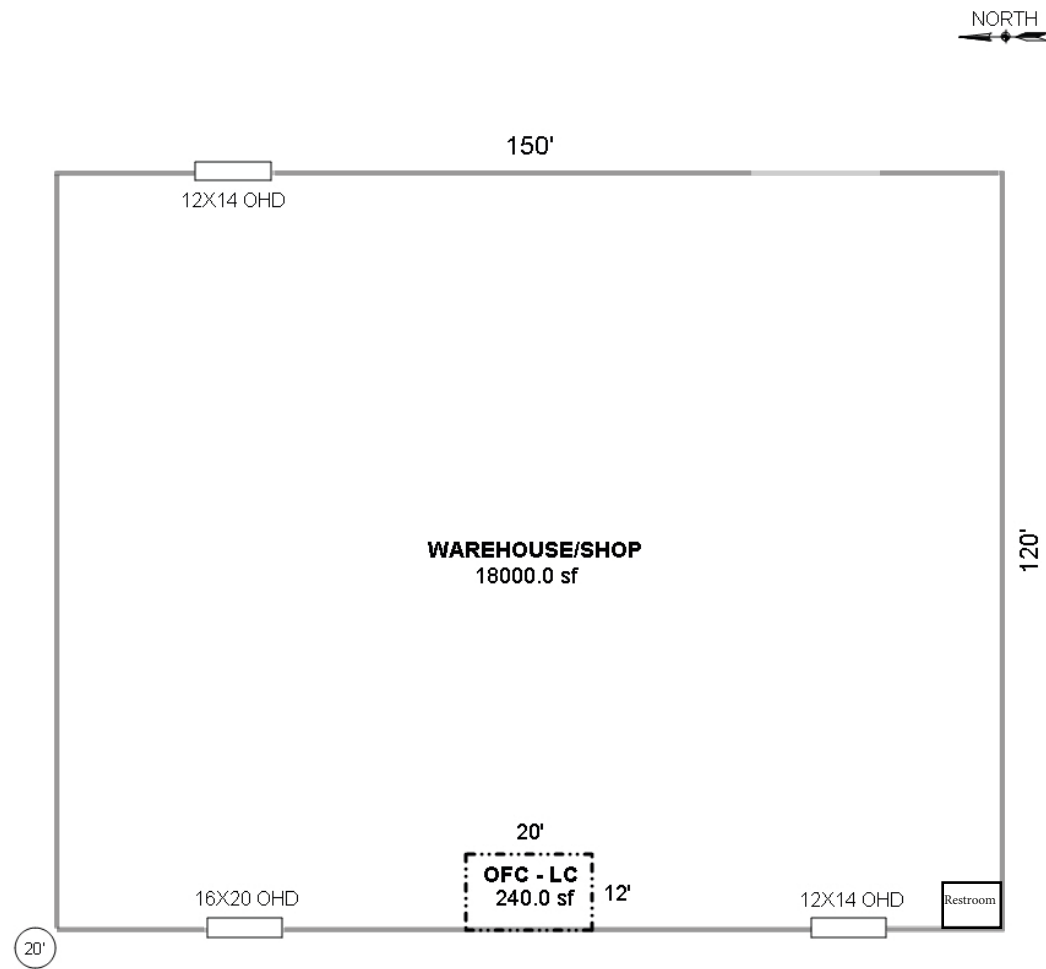



# Additional Photos





# Location

Located in the heart of Stayton Industrial Park. Enjoy quick access to Highway 22 for an easy commute to Salem and surrounding areas.





# Stayton Industrial Park



FOR MORE INFORMATION  
ON THIS PROPERTY  
CALL OUR OFFICE

---

MIKE MOSAR, PRINCIPAL BROKER  
350 MISSION ST. SE, SUITE 101  
SALEM, OR 97302  
(971) 273-7670  
MIKE@MOSARCOMMERCIAL.COM

[WWW.MOSARCOMMERCIAL.COM](http://WWW.MOSARCOMMERCIAL.COM)

873 WILLAMETTE AVE, STAYTON, OR 97383

---

INDUSTRIAL BUILDING

