

UNION SQUARE

2ND STREET NORTHWEST, BEMIDJI, MN



KRAUS-ANDERSON[®]
Realty Company

SPACE AVAILABLE

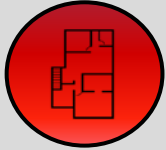

Multiple spaces available
-see site plan

SHOPPING CENTER



42,300 sf neighborhood
mixed-use property
located on Paul Bunyan
Drive/TH 197 and 2nd street

LOCATION



Adjacent to Lake Bemidji,
Paul Bunyan Statue, and
the Downtown Central
Business District

TRAFFIC COUNT



22,900/VPD on Paul
Bunyan Drive



	1 Mile	3 Miles	5 Miles
POPULATION	3,102	18,478	22,121
DAYTIME POP	5,571	27,147	29,059
HOUSEHOLDS	1,155	7,315	8,738
HOUSEHOLD INCOME	42,358	57,981	60,510



Retail Aerial

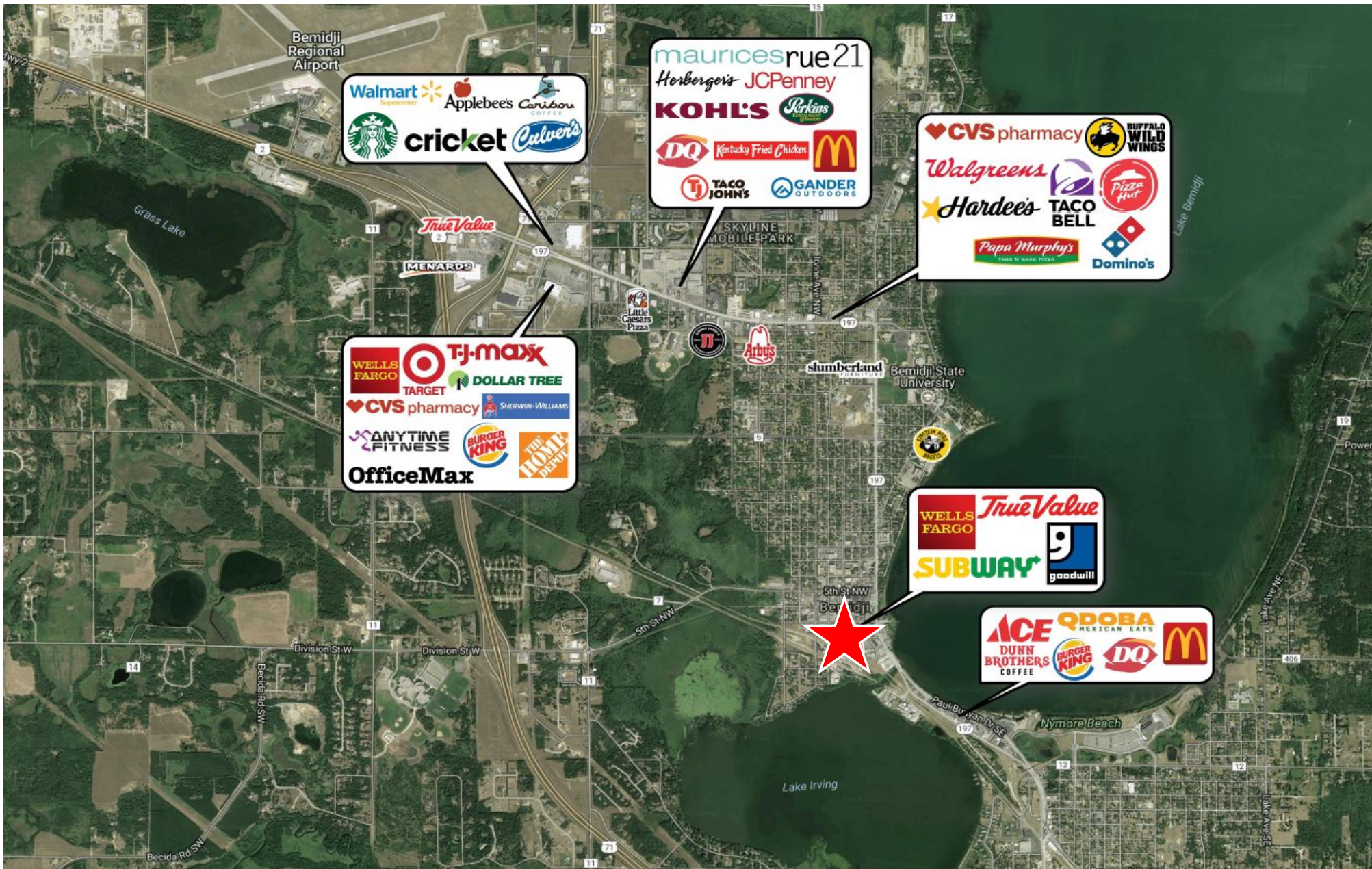

UNION SQUARE
BEMIDJI, MN





Aerial View



UNION SQUARE
BEMIDJI, MN



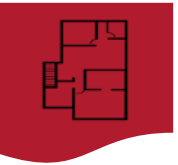

Site Plan

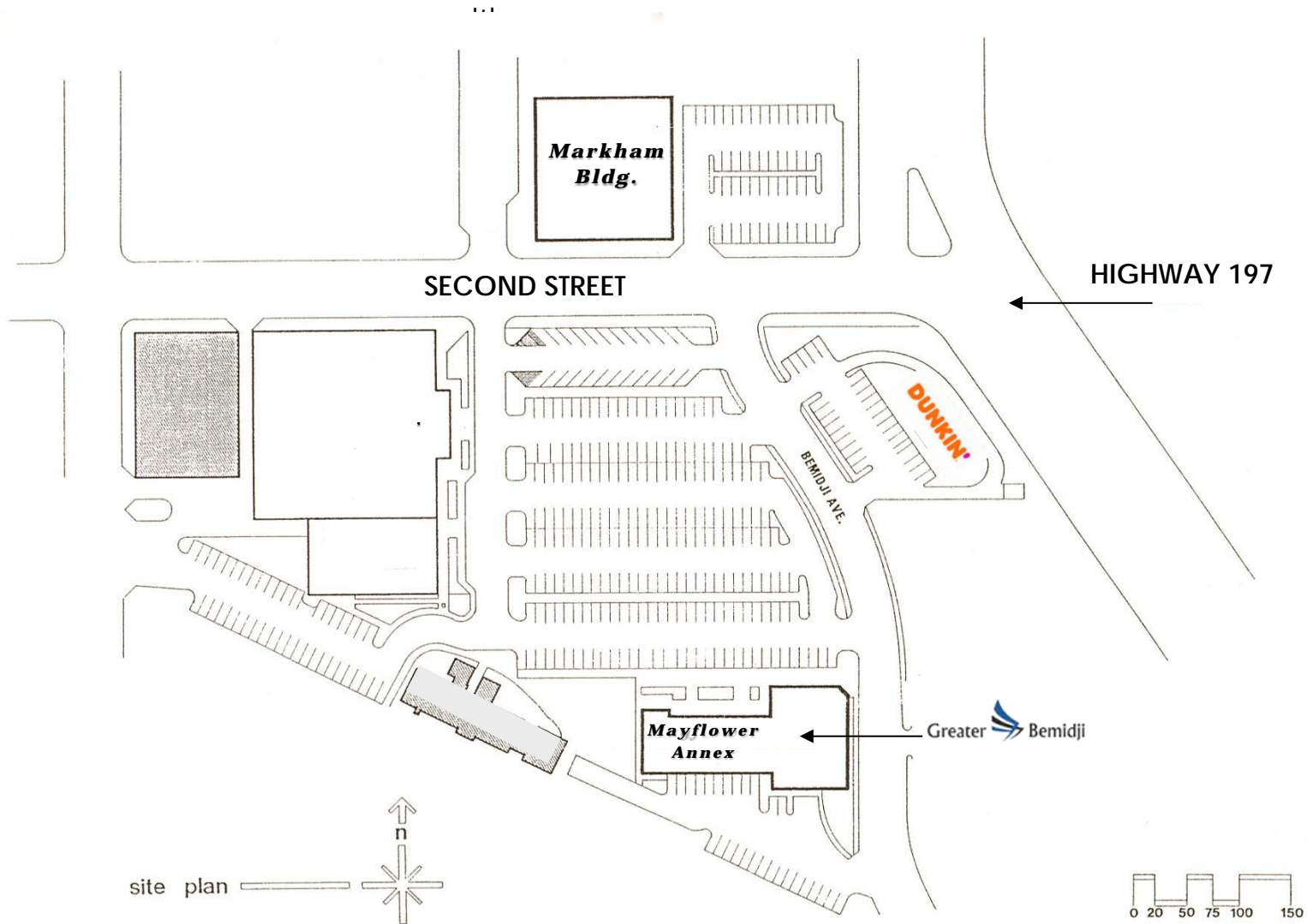

	Union Square	
Site Area	5.7 Acres	
Gross Leaseable Area	26,943 SF	
Parking Stalls	359	

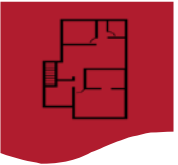

Site Plan

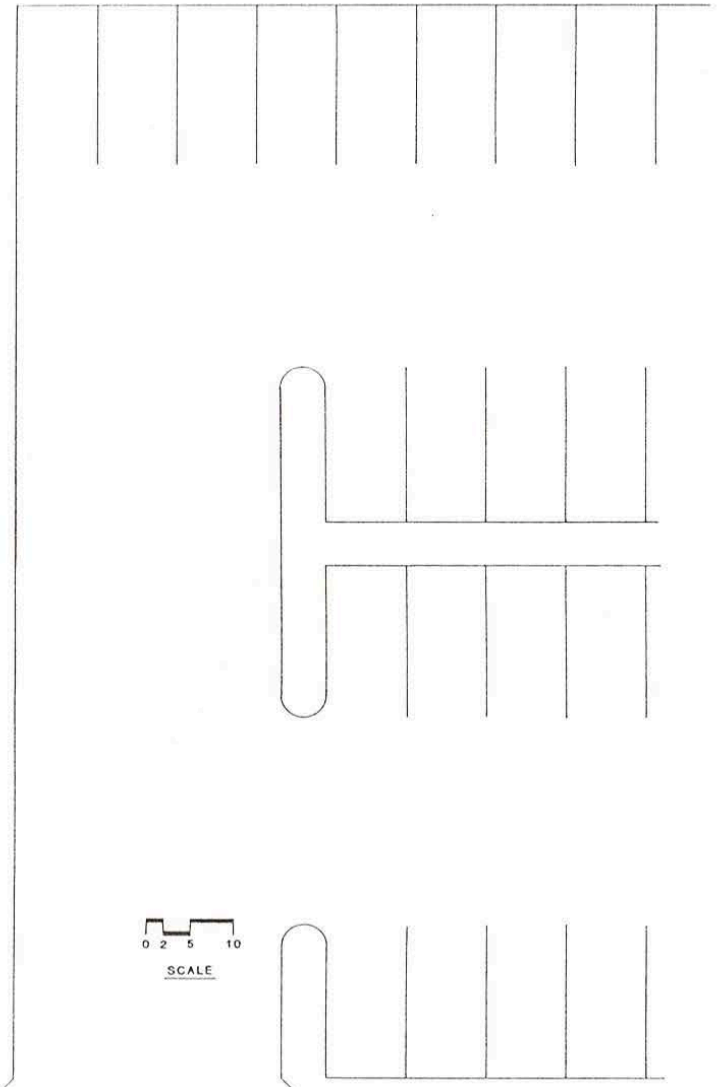
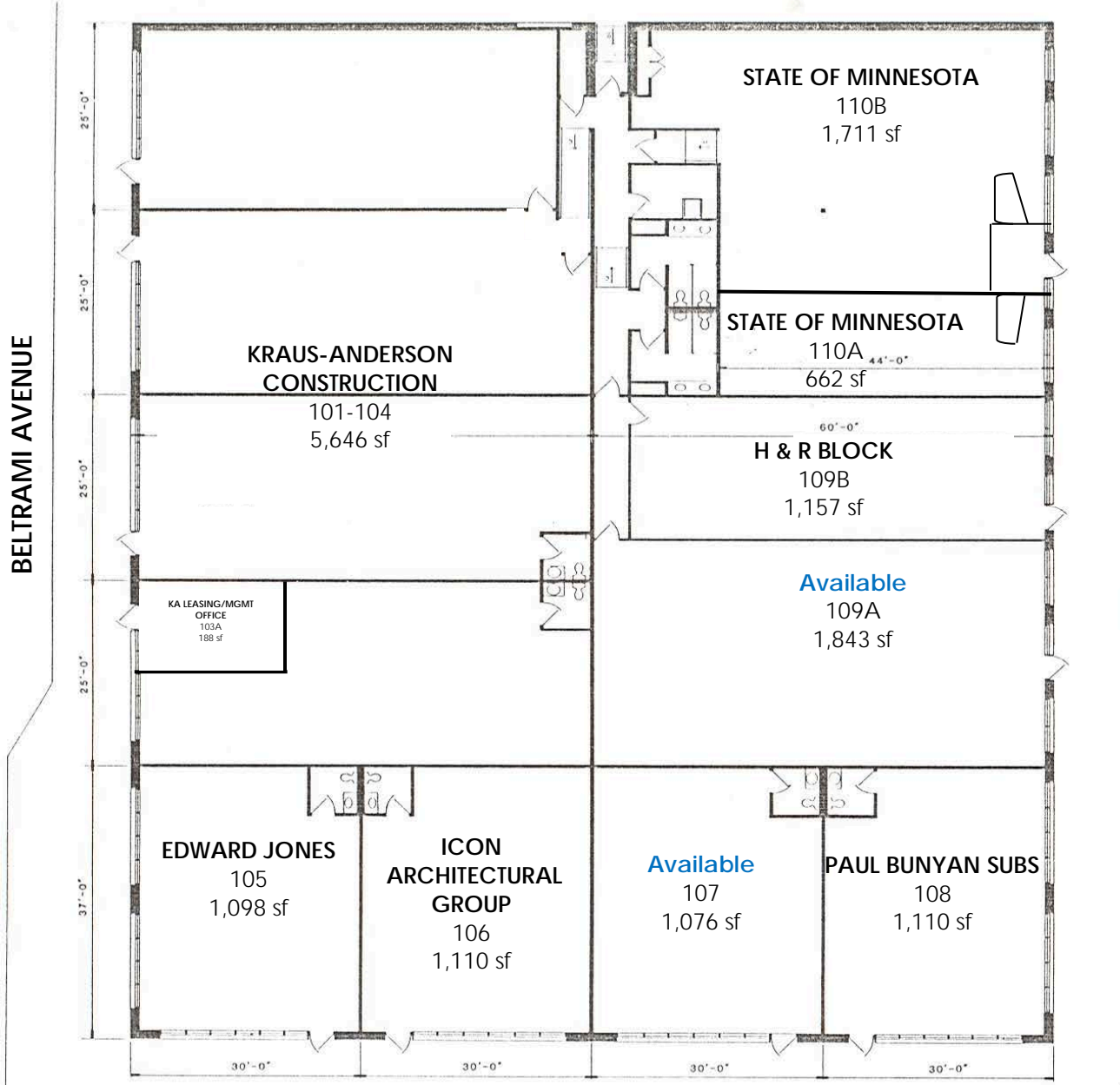

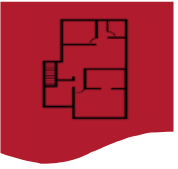

Site Plan

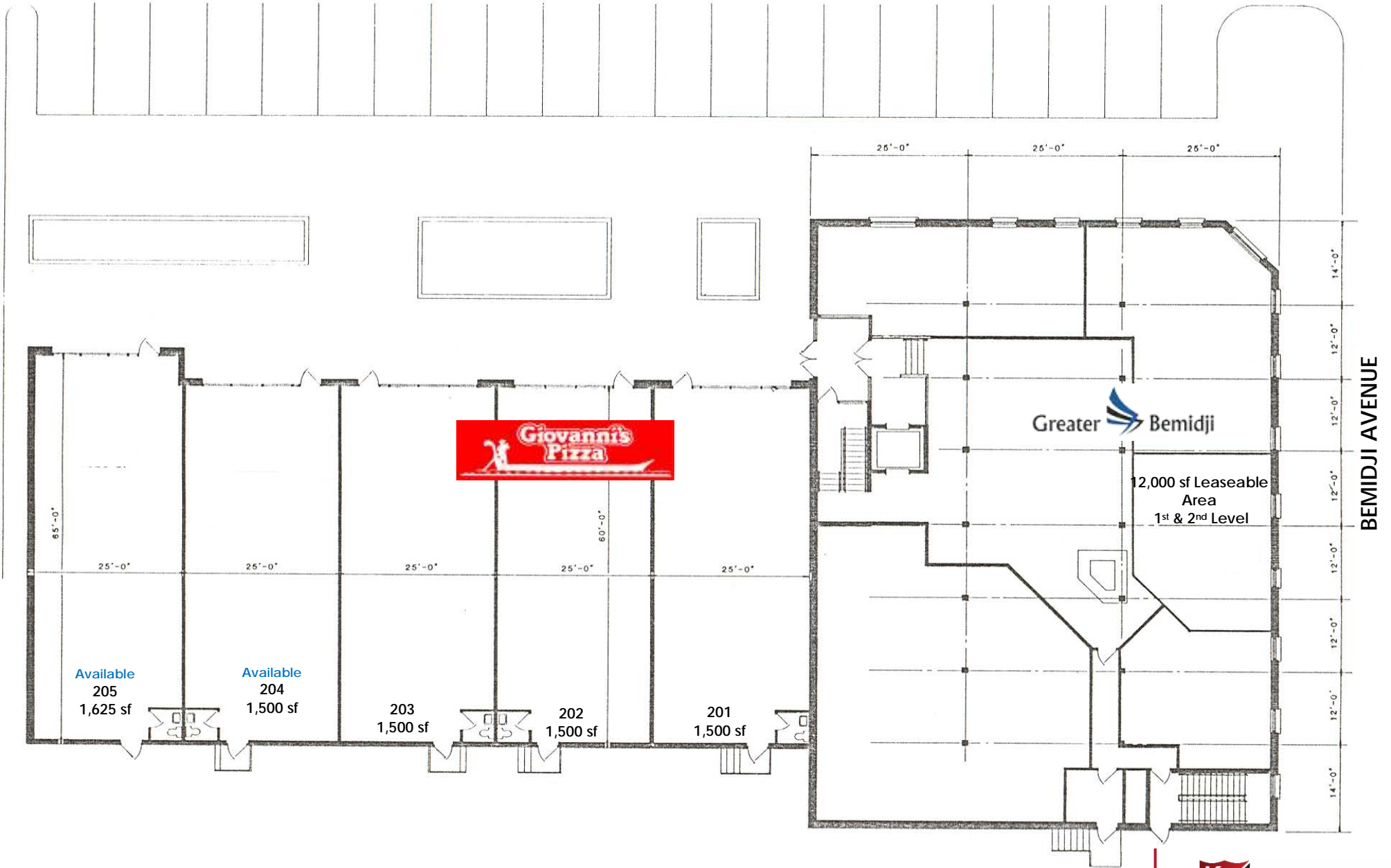

MAYFLOWER BUILDING
US HWY 197 & SECOND STREET, BEMIDJI, MN





Contact

Kraus-Anderson

202 Beltrami Ave
Bemidji, MN 56601

www.krausanderson.com

Main 218-759-3047
Fax 218-759-0995



Dan Mossey



O: 612-255-2420

C: 763-438-4751



dan.mossey@krausanderson.com

Linda Autrey



O: 218-759-3047

C: 218-766-8212



linda.autrey@krausanderson.com