

658 WEST 181ST STREET

BETWEEN WADSWORTH AVENUE & BROADWAY | WASHINGTON HEIGHTS

claire's

Free
Piercing
It's our thing.

*with the purchase of a starter kit.

SPRINKLERS
THROUGHOUT
BUILDING

SPRINKLER
FIRE DEPT.
CONNECTION

658 WEST 181ST STREET

BETWEEN WADSWORTH AVENUE & BROADWAY | WASHINGTON HEIGHTS

PROPERTY HIGHLIGHTS

- Highly visible location in heavily trafficked retail corridor
- Dense residential neighborhood
- Strong neighboring retail tenancy including:
Target, Capital One, Foot Locker, Carter's, AT&T, T-Mobile, Verizon, Chick-fil-A, JD Sports, Snipes, Chase, Vitamin Shoppe, Apple Bank, & more!

SIZE: 1,219 SF Ground Floor

FRONTAGE: 23'

CEILING HEIGHT: 12'

POSSESSION: 90 days from signing

ASKING RENT: Upon Request

TRANSPORTATION: 



658 WEST 181ST STREET

BETWEEN WADSWORTH AVENUE & BROADWAY | WASHINGTON HEIGHTS

FLOOR PLANS: GROUND FLOOR - 1,219 SF

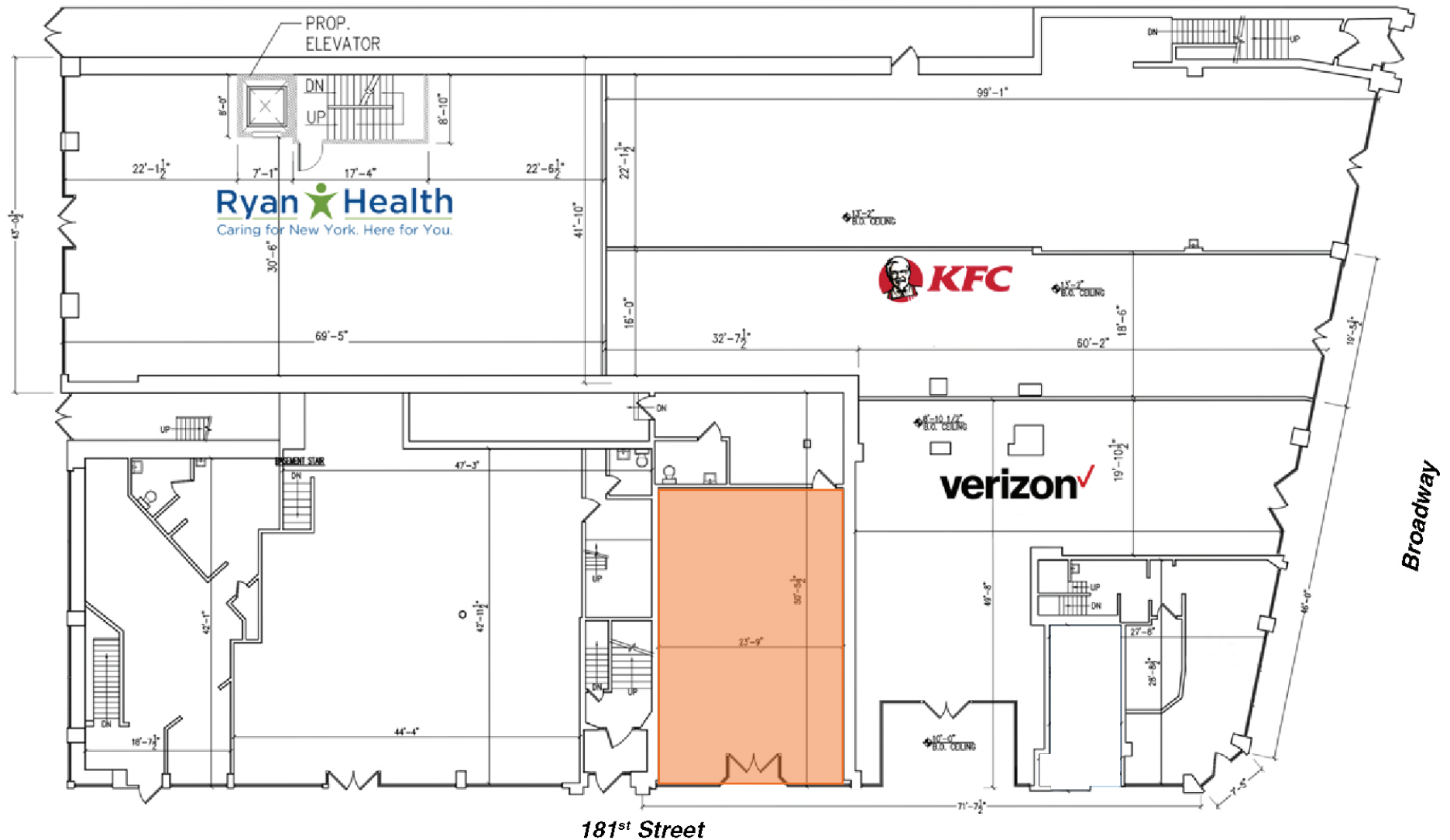

658 WEST 181ST STREET

BETWEEN WADSWORTH AVENUE & BROADWAY | WASHINGTON HEIGHTS

FOR MORE INFORMATION,
PLEASE CONTACT:

JACK HAMADANI

718.415.0095 | JHamadani@ksrny.com

FREDDY SOUID

917.968.0329 | FSoud@ksrny.com

DARREN KASSIN

917.684.7271 | DKassin@ksrny.com

