

INDUSTRIAL FOR LEASE

Major Price Reduction!

4180 Hallmark Pkwy
San Bernardino, CA 92407



PROPERTY HIGHLIGHTS

- NEW CONSTRUCTION
- ±22,195 SF BUILDING ON ±60,984 SF LOT
- AVAILABLE IMMEDIATELY
- THREE (3) DOCK HIGH POSITIONS
- THREE (3) GROUND-LEVEL DOORS
- 23' MINIMUM CLEARANCE
- ESFR SPRINKLERS, K25.2 HEADS
- IRON FENCED & GATED YARD
- SKYLIGHTS
- EASY ACCESS TO THE I-215, I-210 FREEWAYS

PRICING SUMMARY

- **LEASE RATE: \$1.29 PSF/MO GRS**

±22,195 SF
INDUSTRIAL BUILDING



JP GORMLY

Vice President, Principal LIC NO 01921853
e jpgormly@lee-associates.com
o 323.767.2036

PETER D. BACCI

SIOR Executive VP, Principal LIC NO 00946253
e pbacchi@lee-associates.com
o 323.767.2022

MICHAEL H. TSAPARIAN

CCIM SIOR Executive VP, Principal LIC NO 00946253
e mtsaparian@lee-associates.com
o 323.767.2111

INDUSTRIAL FOR LEASE

PROPERTY SITE PLAN

HALLMARK PKWY

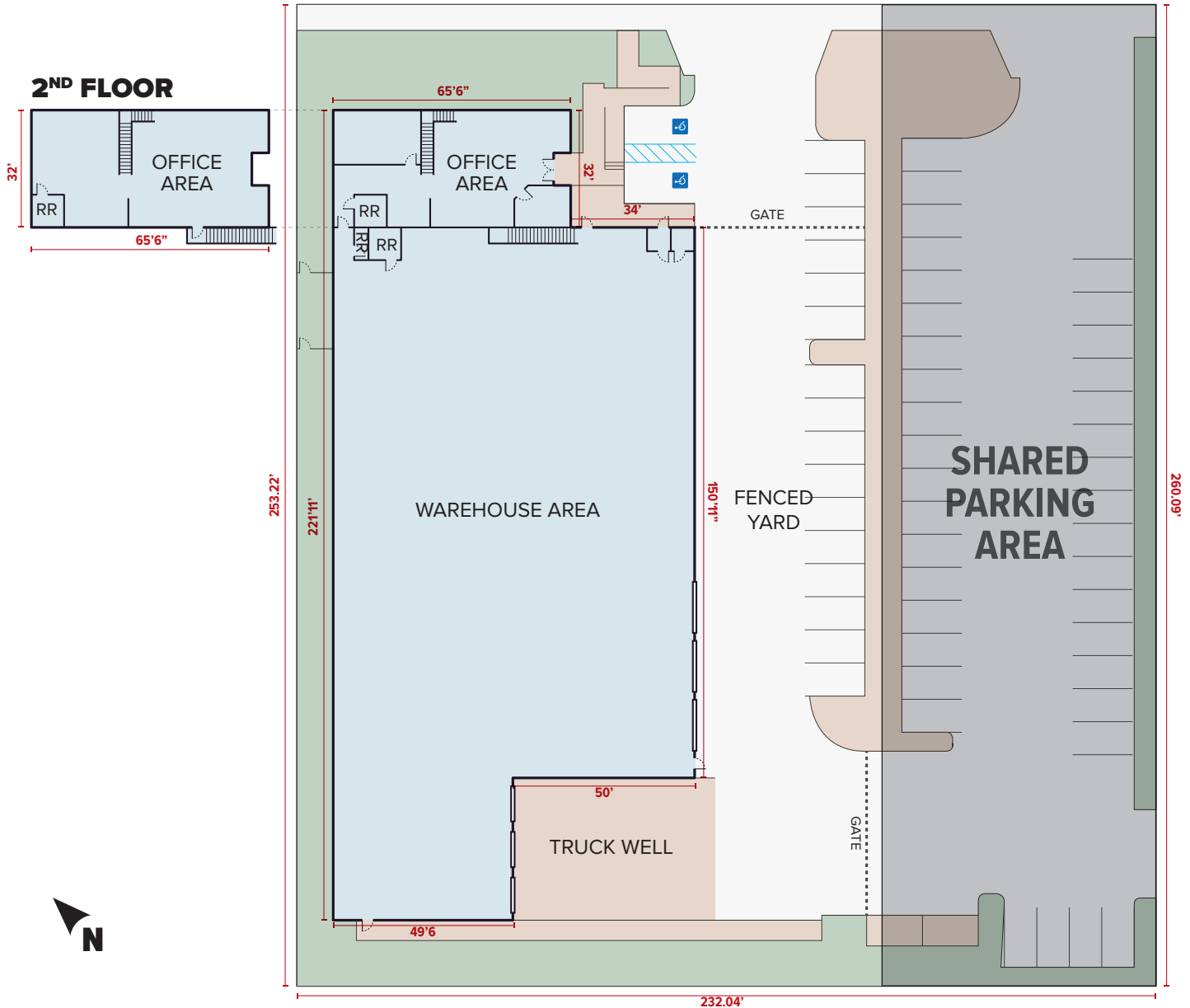

4180 Hallmark Pkwy
San Bernardino, CA 92407

±22,195 SF Industrial Building

NOTE: Drawing not to scale. All measurements and sizes are approximate.

JP GORMLY

Vice President, Principal LIC NO 01921853

e jpgormly@lee-associates.com

o 323.767.2036

PETER D. BACCI

SIOR Executive VP, Principal LIC NO 00946253

e pbacci@lee-associates.com

o 323.767.2022

MICHAEL H. TSAPARIAN

CCIM SIOR Executive VP, Principal LIC NO 00946253

e mtsaparian@lee-associates.com

o 323.767.2111