

# 23-17 41<sup>ST</sup> AVENUE

CORNER OF 24TH STREET | LONG ISLAND CITY

**HELLER**  
ORGANIZATION



**OVER 7,000+ SF  
ON PRIME CORNER**

EXCLUSIVE BROKERS

**Joshua Singer** [josh@hellerorg.com](mailto:josh@hellerorg.com)

**Stephen Weber** [stephen@hellerorg.com](mailto:stephen@hellerorg.com)



54 West 21st Street, 6th Floor | New York, NY 10010 | P: 212.366.5034 | F: 917.591.0590

[www.hellerorg.com](http://www.hellerorg.com)

All information is from sources deemed reliable. No representation is made and we do not guarantee the accuracy of any information provided. All information must be independently verified. The value of any real estate investment is dependent on a variety of factors and should be evaluated carefully by prospective purchasers and/or tenants.

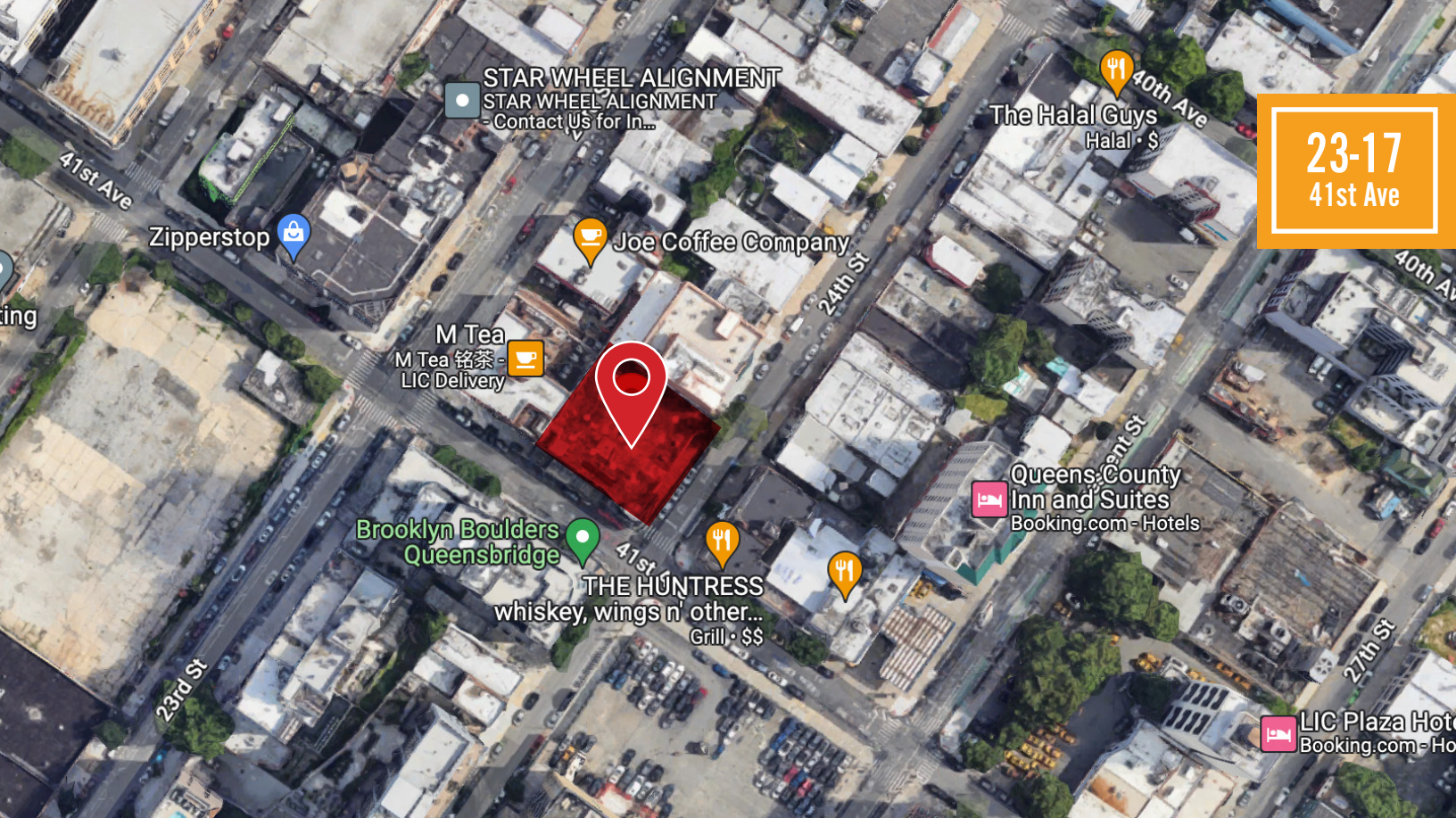

**23-17**  
41st Ave

**SIZE:** 7,233 SF Ground (divisible)

**FRONTAGE:** 125' Wraparound on 41st Ave

**CEILING HEIGHT:** 15' Space A | 12'4" Space B

**POSSESSION:** Arranged

**TRANSPORTATION:** **E R N W M G 7**

**HIGHLIGHTS:**

- All logical divisions considered
- High foot traffic corner
- 10 minute walk to Court Square
- 155' total frontage
- Brand new condo development

**NEIGHBORING TENANTS:**



**EXCLUSIVE BROKERS**

**Joshua Singer** josh@hellerorg.com

**Stephen Weber** stephen@hellerorg.com



54 West 21st Street, 6th Floor | New York, NY 10010 | P: 212.366.5034 | F: 917.591.0590

[www.hellerorg.com](http://www.hellerorg.com)

All information is from sources deemed reliable. No representation is made and we do not guarantee the accuracy of any information provided. All information must be independently verified. The value of any real estate investment is dependent on a variety of factors and should be evaluated carefully by prospective purchasers and/or tenants.

# FLOOR PLAN - GROUND FLOOR

23-17  
41st Ave

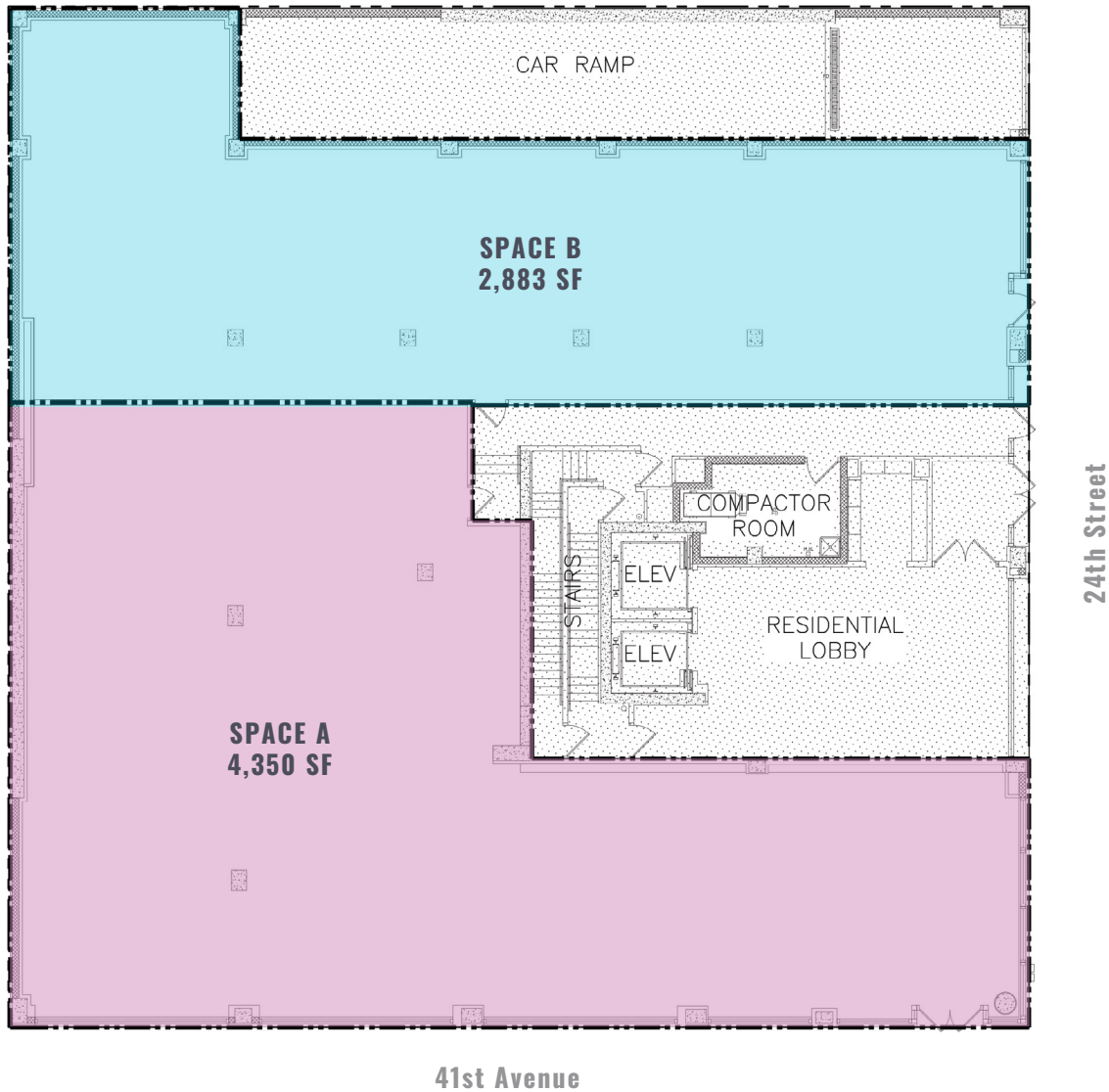

## EXCLUSIVE BROKERS

**Joshua Singer** [josh@hellerorg.com](mailto:josh@hellerorg.com)

**Stephen Weber** [stephen@hellerorg.com](mailto:stephen@hellerorg.com)

**HELLER**  
ORGANIZATION

54 West 21st Street, 6th Floor | New York, NY 10010 | P: 212.366.5034 | F: 917.591.0590

[www.hellerorg.com](http://www.hellerorg.com)

All information is from sources deemed reliable. No representation is made and we do not guarantee the accuracy of any information provided. All information must be independently verified. The value of any real estate investment is dependent on a variety of factors and should be evaluated carefully by prospective purchasers and/or tenants.