



**For Sublease**

## LaSalle Building at Ten Mile Crossing

**2487 W. Navigator Drive  
Suite 430  
Meridian, ID**

### Overview

Class A office space located in the prestigious LaSalle Building at Ten Mile Crossing, one of Meridian's most dynamic office developments. This high-quality space offers modern finishes, functional layout, and immediate access to I-84 via the Ten Mile Interchange.

- Professional office buildout
- Flexible layout with efficient design
- Located in a rapidly growing employment corridor
- Surrounded by new restaurants, retail, gyms, and services

### Contact

---

**Greg Gaddis**

208.869.9294

[greg@tenantrealtyadvisors.com](mailto:greg@tenantrealtyadvisors.com)

**Joshua Waitman**

208.369.1123

[joshua@tenantrealtyadvisors.com](mailto:joshua@tenantrealtyadvisors.com)

---

950 W. Bannock St., Suite 400  
Boise, ID 83702

---

**TenantRealtyAdvisors.com**



FOR SUBLEASE

2487 W. Navigator Drive Meridian, ID



## Property Information

Property Type  
**Office**

Lease Type  
**NNN**  
Estimated at \$7.50/SF/YR

Access  
**Contact  
Agent**

Preferred Term  
**Through May  
31, 2027**  
Longer term available  
direct from landlord

Large Parking  
Lot  
**5:1,000**





FOR SUBLEASE



Space Available

Suite	Size	Rate
430	2,508 RSF	\$22/SF/YR NNN

Floor Plan

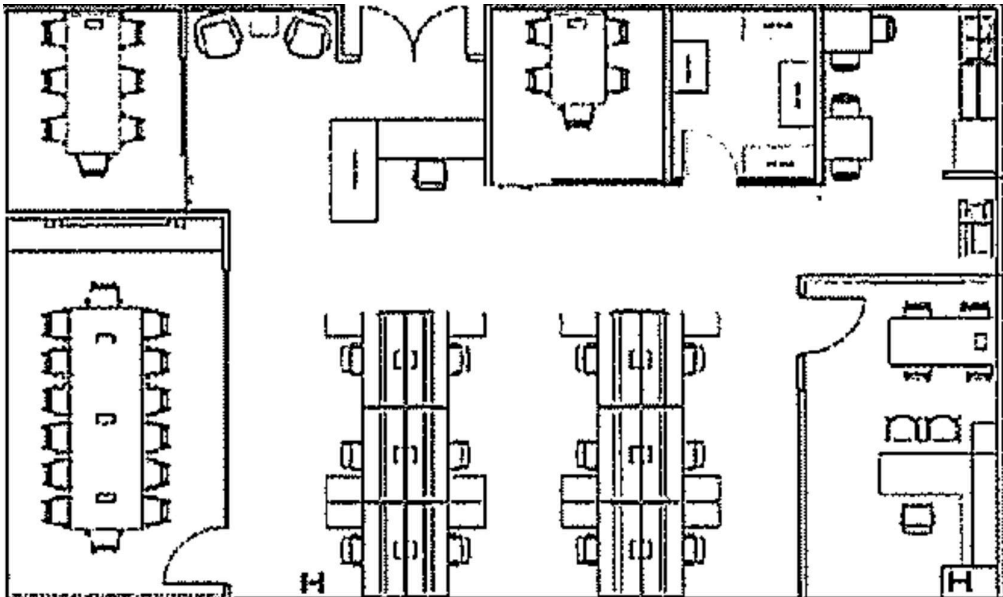





## ABOUT THE AREA

Located at the heart of the Treasure Valley's explosive westward growth, this premier office space sits directly off the **Ten Mile Interchange**—one of the most dynamic corridors in the Boise metro.

- **Highly accessible:** Immediate freeway access via I-84
- **Employee-friendly: Significantly reduced commute times for Canyon County residents** compared to Boise offices
- **Retail-rich environment:** Surrounded by new restaurants, coffee shops, gyms, hotels, and medical offices Steps from Scheels, Chick-fil-A, Starbucks, and other national brands
- **In-demand location:** Meridian continues to rank among the **fastest-growing cities in the country**, making it a strategic location for recruitment and retention