

**Valhalla Industrial Complex**  
**540 BARNEVELD AVE**  
**3,311 - 6,741 ± SF for LEASE**

Scott Mason  
President  
415.215.1937  
scott@calcosf.com  
LIC# 01036610



**Two Units Available**

**Valhalla Industrial Complex**  
**540 BARNEVELD AVE**  
**3,311 - 6,741 ± SF for LEASE**

**SUBJECT  
PROPERTIES**



**Valhalla Industrial Complex**  
**540 BARNEVELD AVE**  
**3,311 - 6,741 ± SF for LEASE**

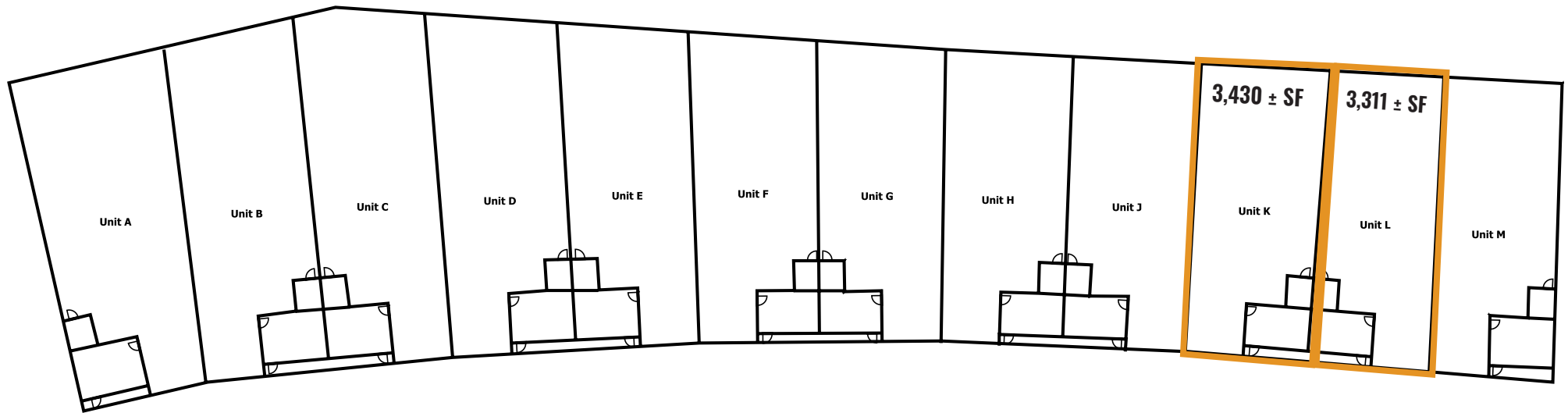

**New to the market, two warehouse units available for LEASE**

- 3,311-6,741 ± SF (if combined)
- Concrete, High cube (22')
- Totally clear span warehouses
- 200 amp, 3 phase power
- One (1) roll up door for each unit outlined
- Sprinklered
- \$1.85 PSF, IG / month
- Available now

**Scott Mason**  
**President**  
415.215.1937  
scott@calcosf.com  
**LIC# 01036610**

**Calco Commercial, Inc.**  
20 Dorman Avenue  
San Francisco, CA  
415.970.0000  
www.calcosf.com

# VALHALLA INDUSTRIAL COMPLEX

1. All concrete, open span, and functionally designed for light industrial and office uses.
2. Ideally situated near the Bayshore industrial corridor. Valhalla Real Estate Industrial Complex encompasses several city blocks bounded by Oakdale, Industrial, and Barneveld Streets. Located within two (2) blocks are both entrances and exits to the 101 and 280 Freeways. Additionally, three (3) separate public bus routes service the Park.
3. Excellent security provided on-site with nightly private patrol.
4. The Park is professionally managed to ensure regular maintenance and repairs, landscaped grounds, and swept-clean walkways and parking areas.
5. The Park is situated within two blocks of more than a dozen restaurants and general business services.
6. Un-metered on-site street parking and private parking lots are available for Tenant use.



Scott Mason  
President  
415.215.1937  
scott@calcosf.com  
LIC# 01036610